



1/32

B-17G FLYING FORTRESS Heavy Bomber



Big 1/32 Scale • Authentic Surface Details • Over 800,000 Rivets • Highly Detail Turbo Supercharger Engines • Wall mount Holder • Detailed Cockpit & Bomb Bay • Colorful Markings

Plastic model kit containing 577 parts

Wing span : 989 mm Length : 707mm

To Express Gratitude :

B-17 Flying Fortress

One of the most renowned combat aircraft of WW II, America's first all-metal, four-engine heavy bomber aircraft, the Boeing B-17 Flying Fortress was primarily utilized in daylight raids to conduct a precision strategic bombing campaign targeting German industrial and civilian targets. In the Pacific theatre, it was used to destroy Japanese airfields and shipping.

Because of their long-range capability and heavy armament, formations of B-17s often flew into battle without a fighter escort. The G variant, for example, carried a healthy complement of 13 .50 calibre machine guns, and was thus very capable of defending itself. By 1944 the B-17s were being accompanied by squadrons of P-51 Mustangs, which allowed the bomber crews to concentrate on their primary duty, pounding aircraft and munitions factories, as well as important psychological targets such as Berlin.

The bombing raids on Germany by the U.S. 8th Air Force and RAF's Bomber Command ripped the heart out of Germany's industrial production. By September 1944, the B-17s had not only 'delivered' 500,000 tons of the 1.5million tons of bombs dropped on Germany, but additionally the airgunners had fired 99 million rounds of ammunition during those missions, downing over 20,000 German planes in the process. Over 12,000 B-17s were built during the war and nearly 250,000 Americans and allied aircrew flew in them, 46,500 of these brave men being either killed or wounded. The B-17 remains one of the defining bombers of WWII.

CAUTION

- * When you use glue or paint, do not use near a open flame, and use in a well-ventilated room.
- * Symbols such as ① refer to the color number of Mr. COLOR and TAMIYA paints. Glue and paint are not included.
- * When you take parts off the runner, use plastic nippers and trim excess plastic with a cutter or a file.
- * See the list at right for a key to the symbols.

These instructions were written based on an experienced modeler's recommendations. We do understand that there are one or two logical assembly sequences, and each and every modeler has their own preferences for the order that they build and paint their models. Therefore, we recommend strongly that every proud owner of this giant kit study the instructions thoroughly, then follow their own preferences for the sequence of assembling and painting the model. Like many scale plastic kits on the market, this kit is built around subassemblies. This is the best way to facilitate maximum ease of assembly and painting. As the kit tries to depict the gear down position as accurately as possible, please take special care and follow the instructions carefully when assembling the landing gear. Finally we must advise you to be very careful when using sharp tools such as modeling knives, drills and cutters. Photo-etch pieces are included so also be very careful with the use of super glue. It will stick your fingers together if used improperly. If that should happen, don't attempt to tear your fingers apart by brute force. Use de-bonder from the super glue manufacturer or nail polish remover to dissolve the glue or simply let your fingers stick together for a short period of time and they should come apart with the help of the metabolism of the human skin. There are many model paints on the market, but being an environmentally-conscious brand, we recommend using acrylics, a water-based paint that does the least harm to the environment. This is a complex kit that will provide hours and hours of enjoyment. However, this kit is meant for modelers aged 14 and over as it contains many small and sharp parts, so please keep it out of the reach of small children.



BE CAREFUL



REMOVE



CEMENT TOGETHER



PLEASE WAIT FOR A FEW MINUTES UNTIL DRY



MAKE 2pcs



OPEN HOLE



DO NOT CEMENT



INSTANT GLUE FOR METAL



BEND



FILL HOLE



APPLY DECAL



OPTIONAL

Parts List

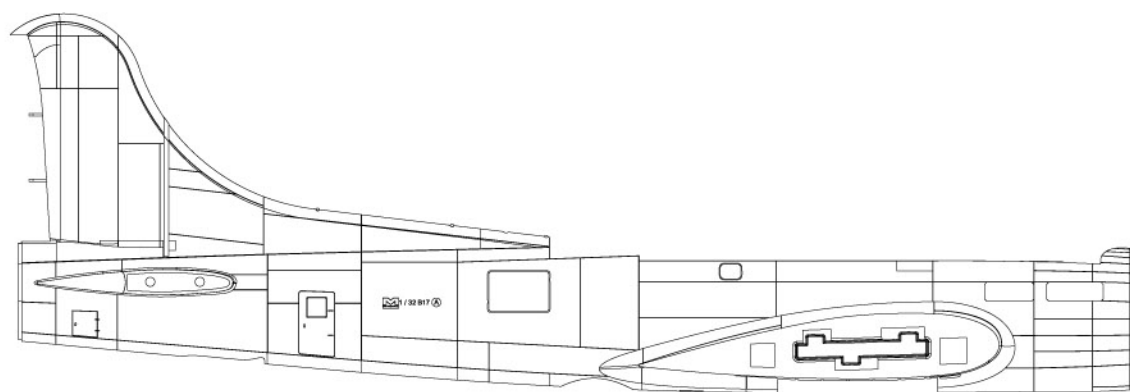

A

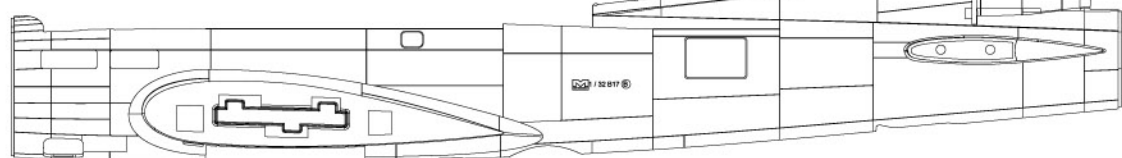

B

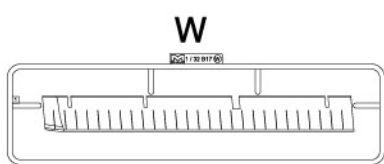

W

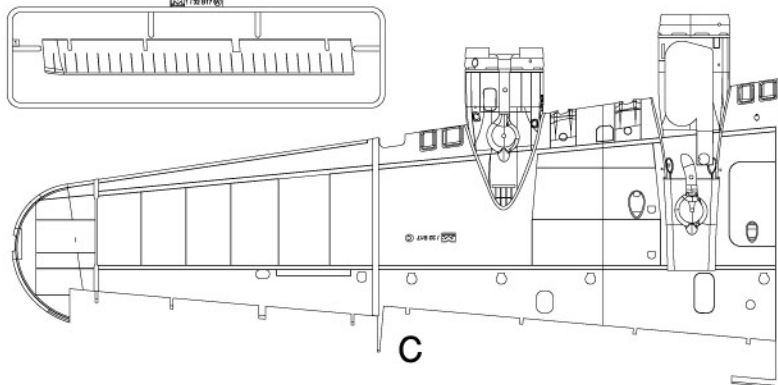

C

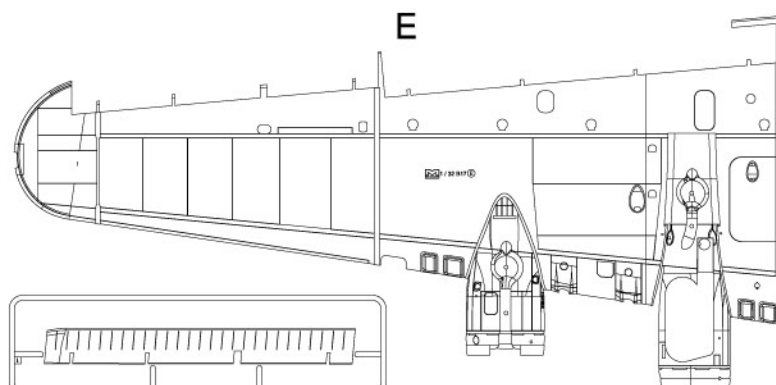

E

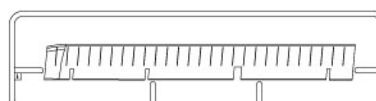

Y

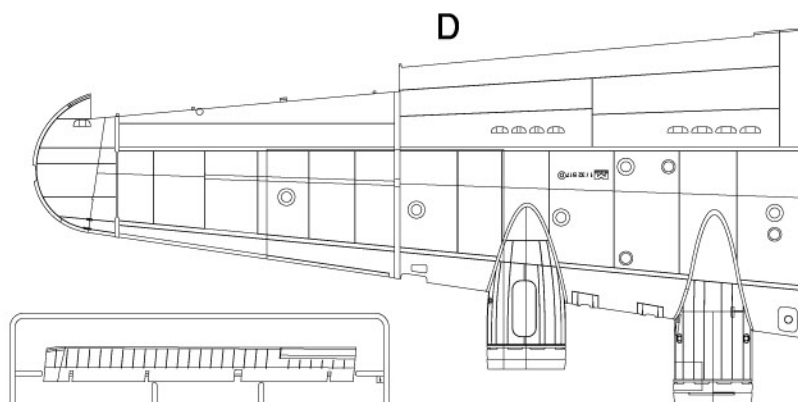

D

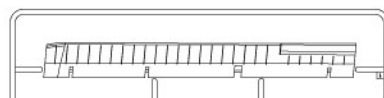

X

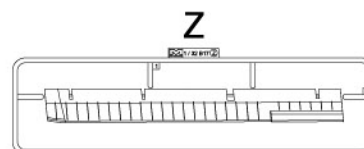

Z

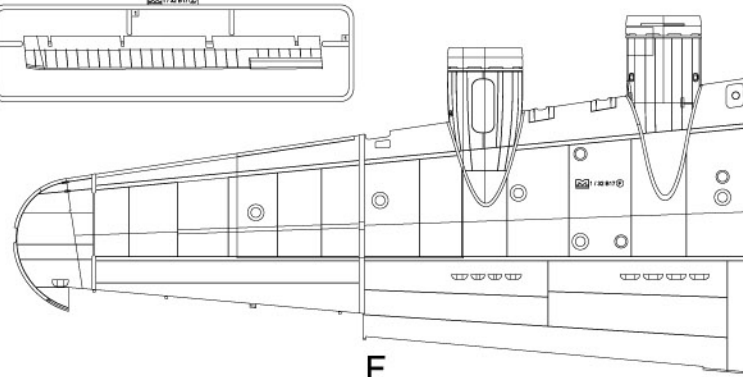

F

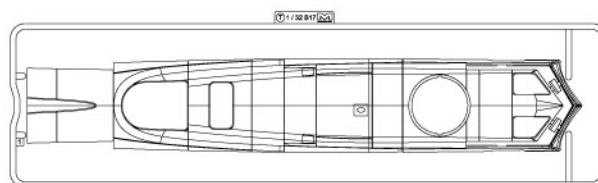

T

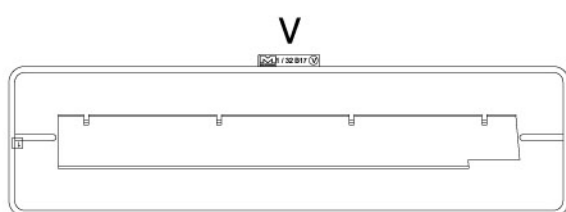

V

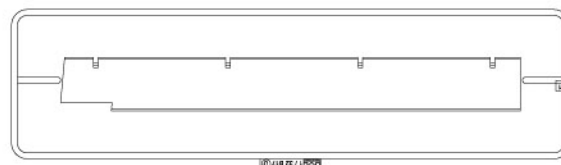

U

Parts List

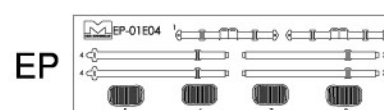
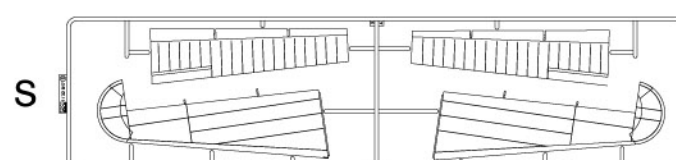
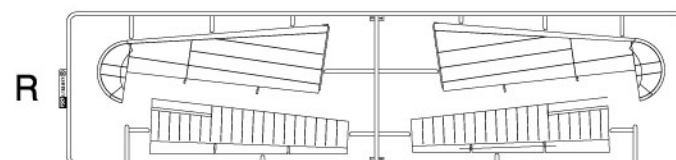
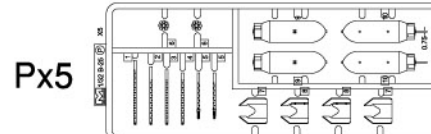
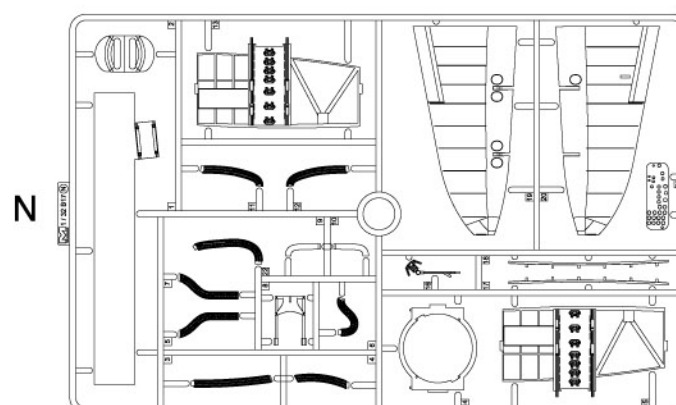
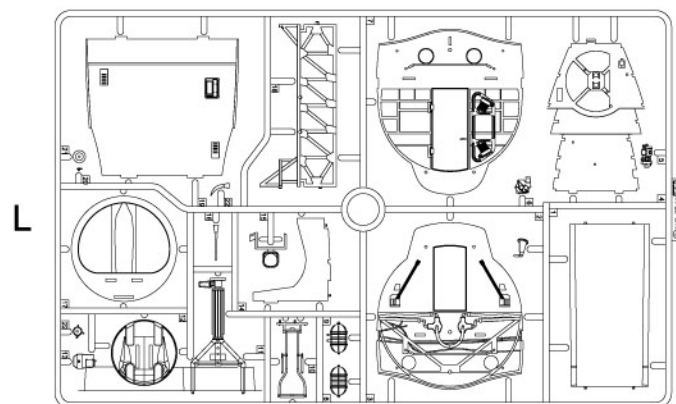
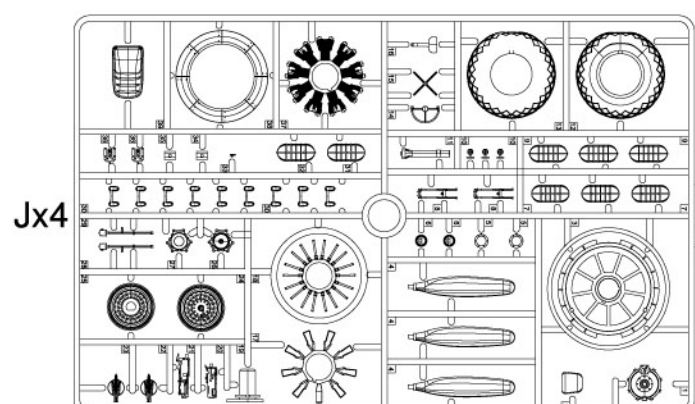
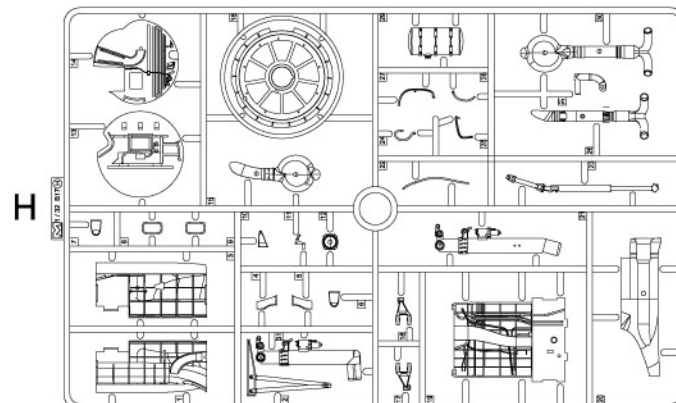
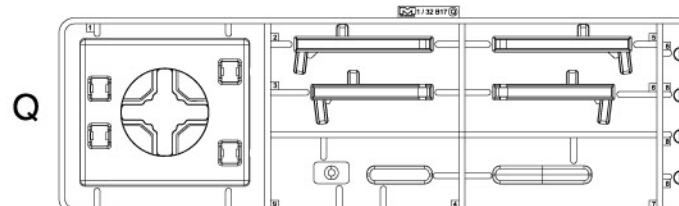
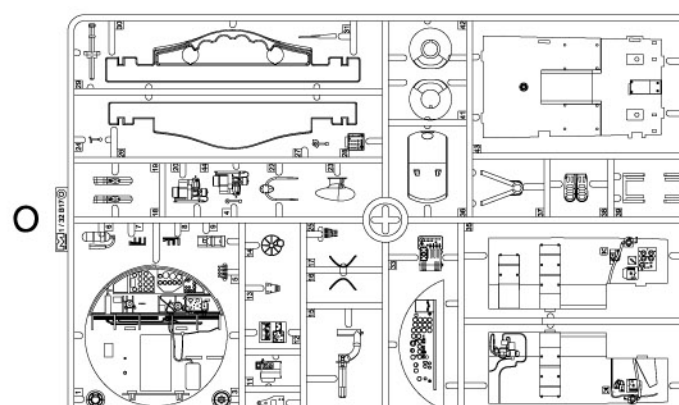
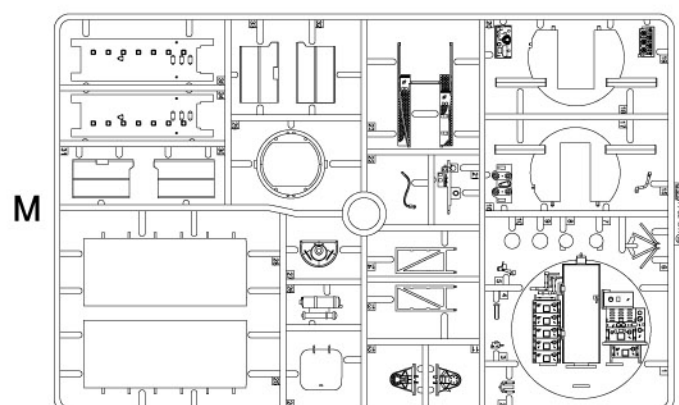
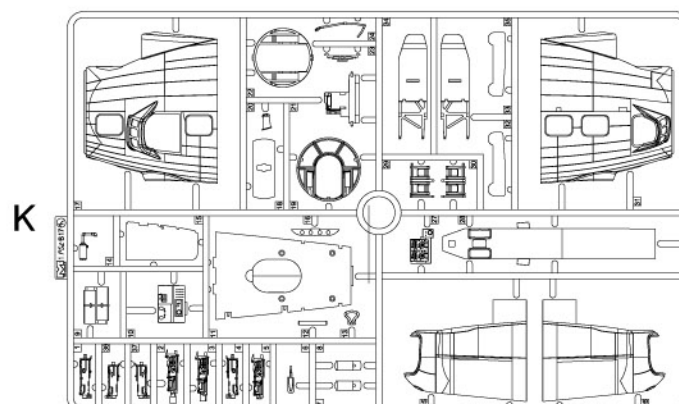
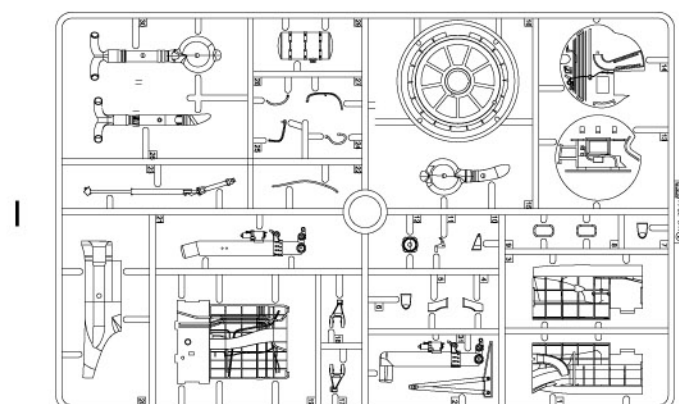
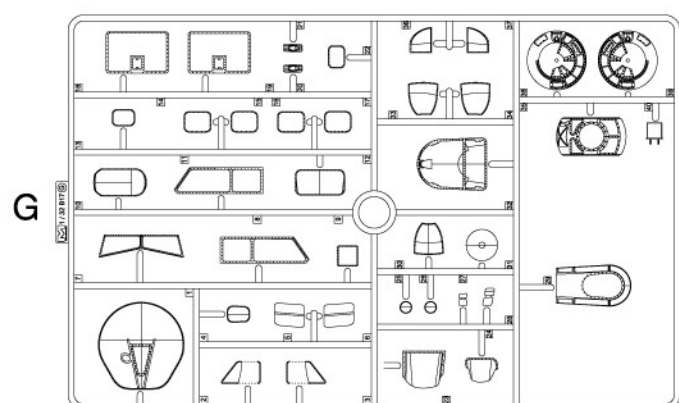

COLOUR GUIDE

	Colour	GSI Mr. Color	TAMIYA ACRYLICS
①	Silver	H8	X11
②	Yellow	H4	X24
③	Khaki Green	H80	XF26
④	Flat Black	H12	XF1
⑤	Olive Drab	H52	XF62
⑥	Black	H2	X1
⑦	Wood Brown	H37	X9
⑧	Steel	H18	X10
⑨	Tire Black	H77	XF18
⑩	Burnt Iron	H76	X10
⑪	Grey	H22	XF20
⑫	Flat White	H1	XF2
⑬	Green	H16	X5

1 Central pedestal and control column assembly

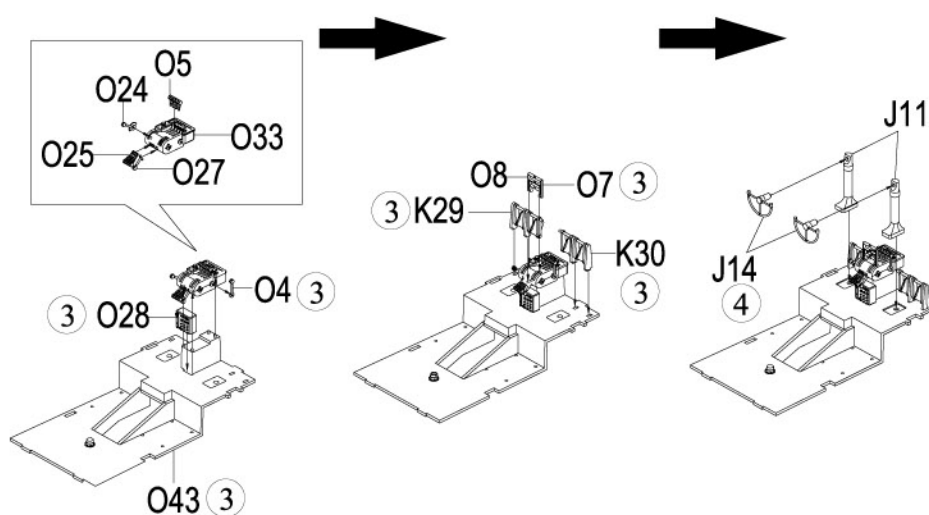

2 Seat assembly

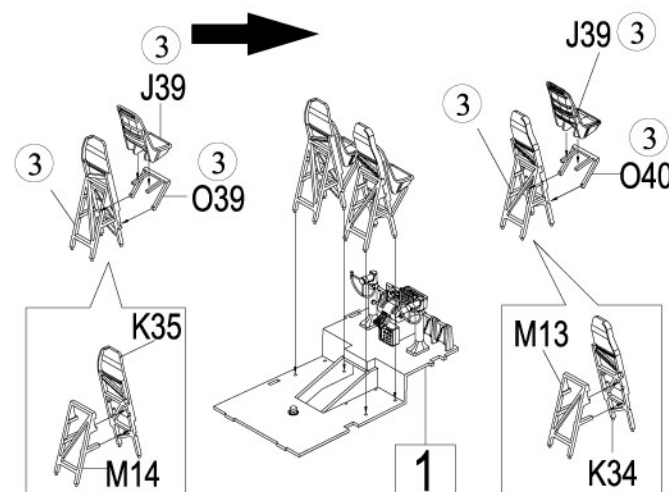

3X12

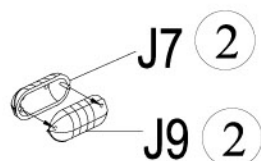

5 Oxygen tank assembly

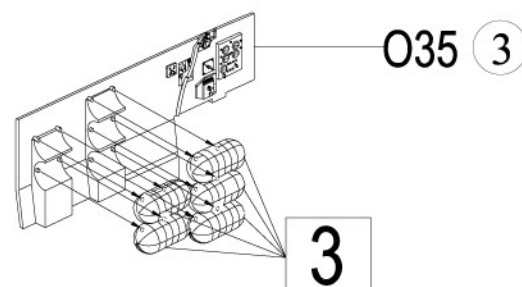

6

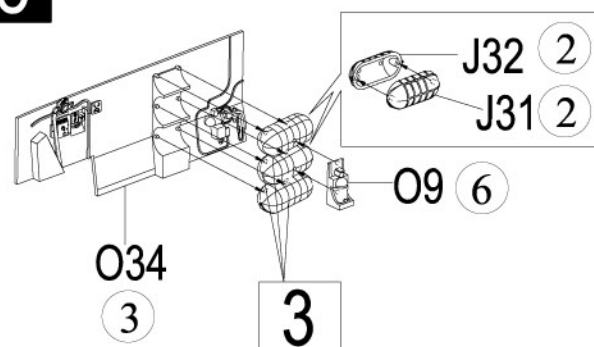

7

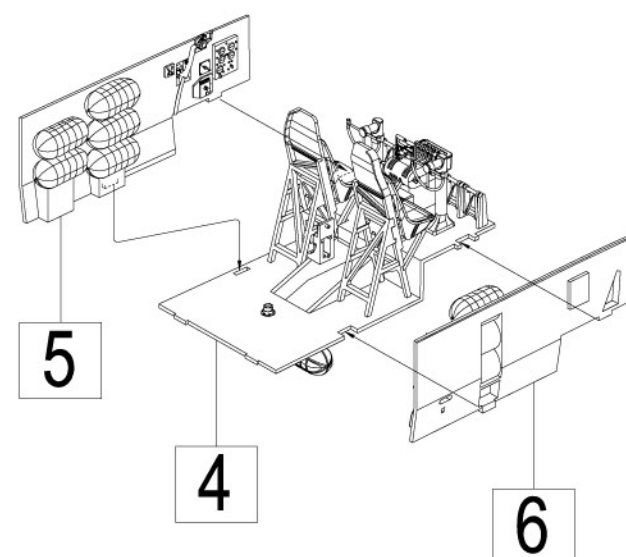

4

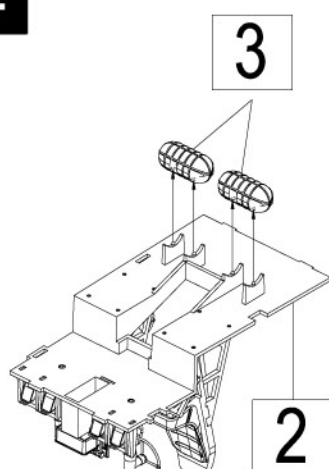

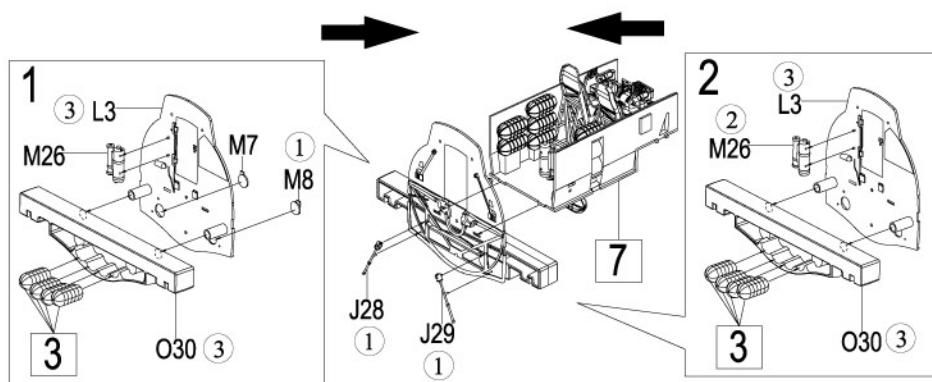
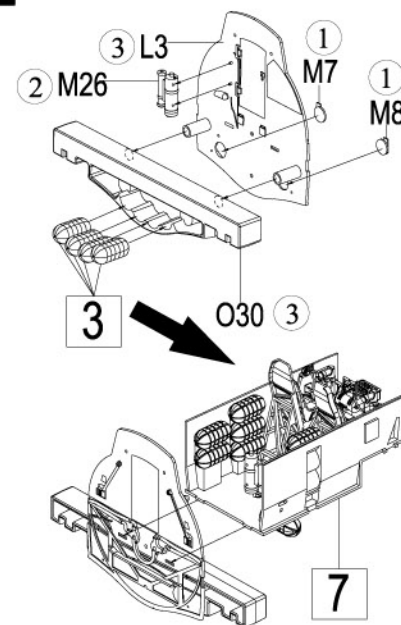
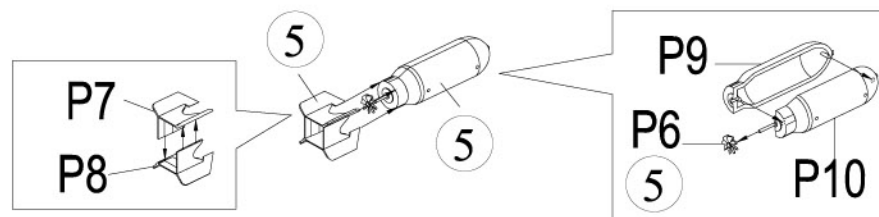
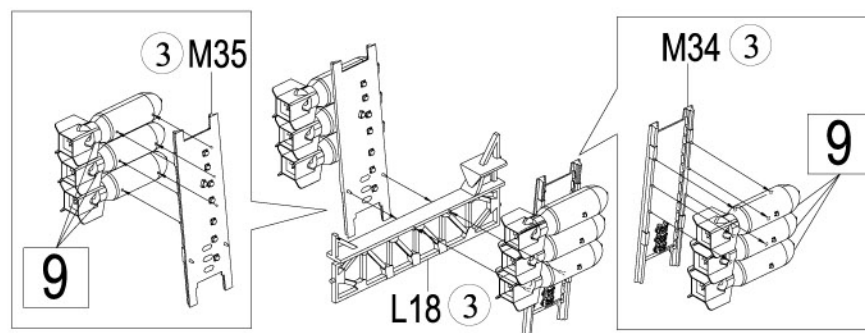
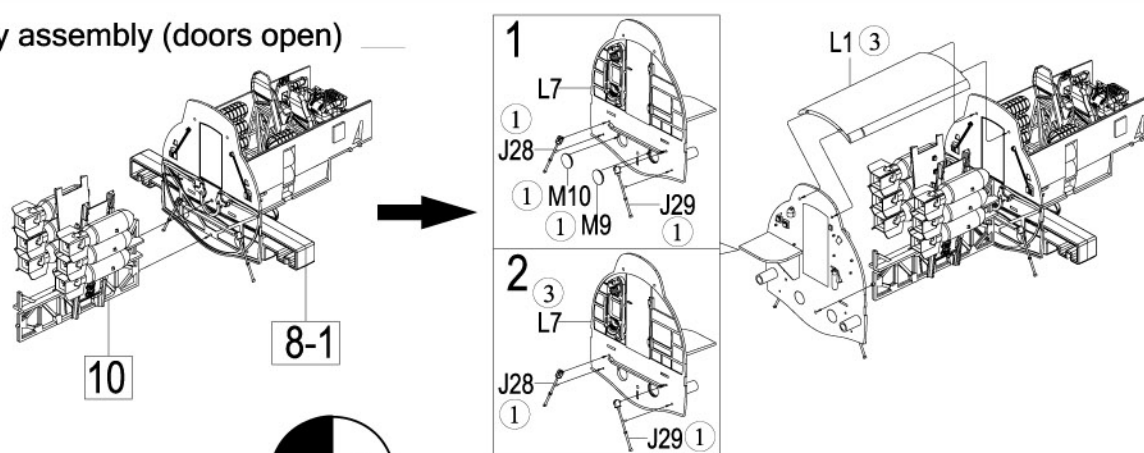
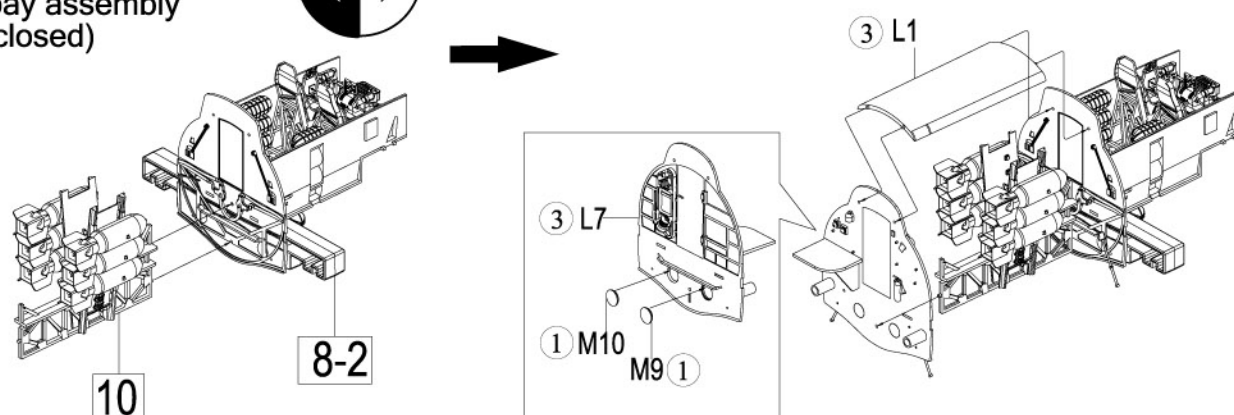
8-1 Bomb bay (doors open)**8-2** Bomb bay (doors closed)**9X10****10****11-1** Bomb bay assembly (doors open)**11-2** Bomb bay assembly (doors closed)

12

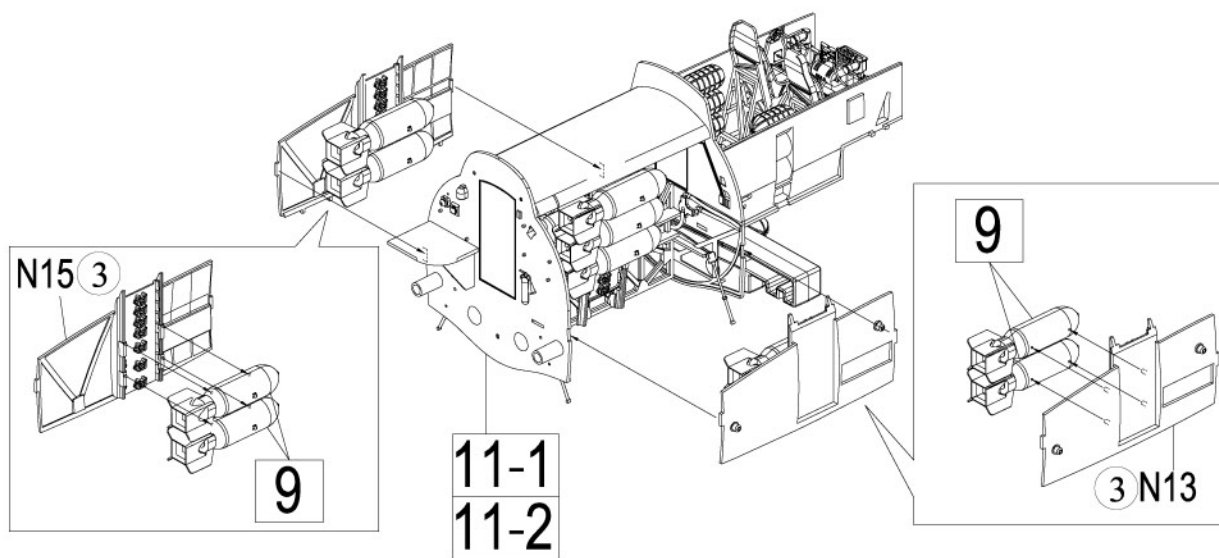

13

Radio compartment assembly

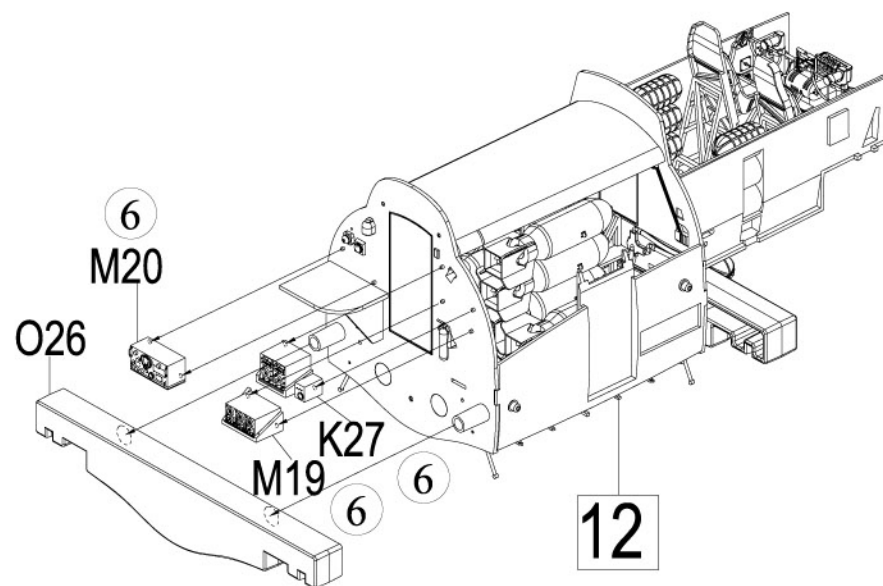

14

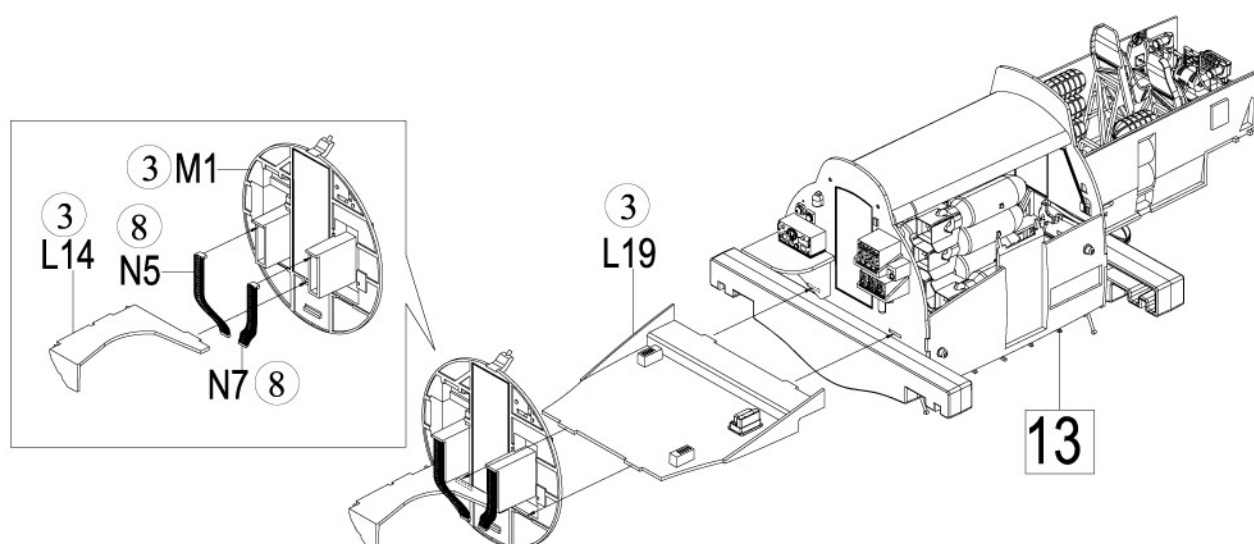

15 Instrument panel assembly

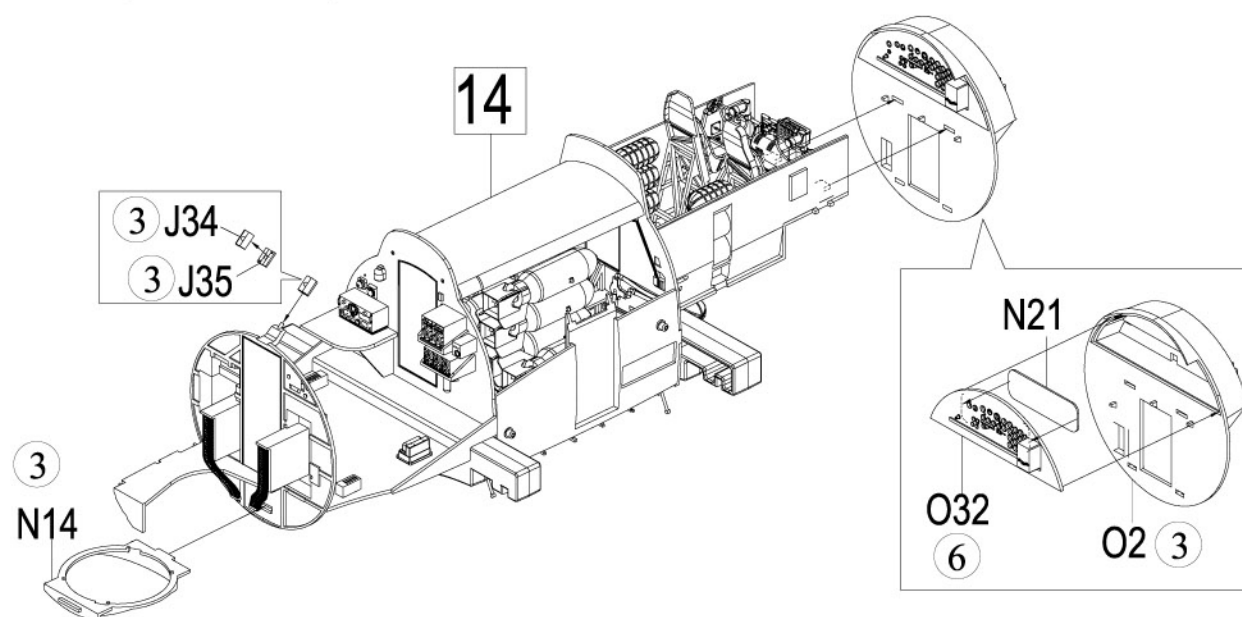

16 Waist gun window assembly (left)

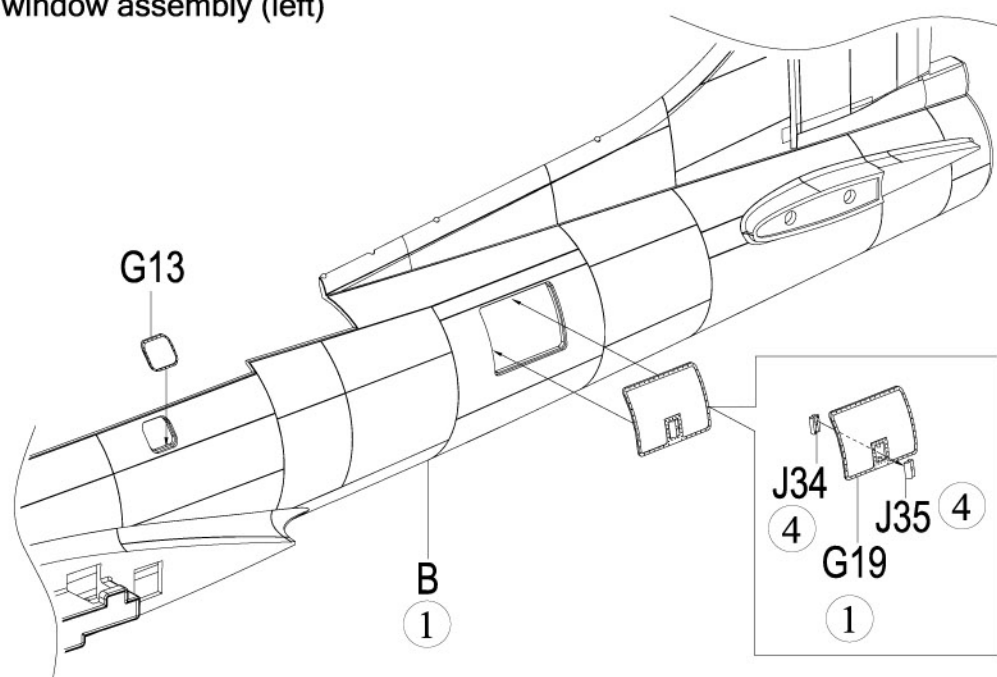

17 Mating central unit to fuselage

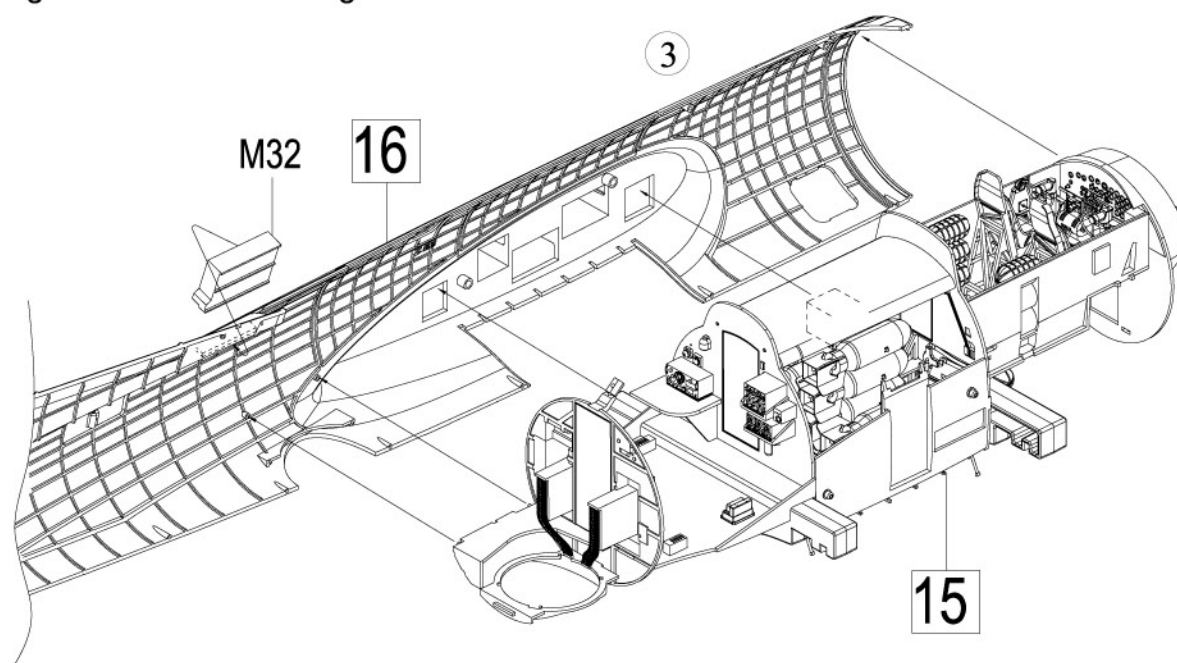

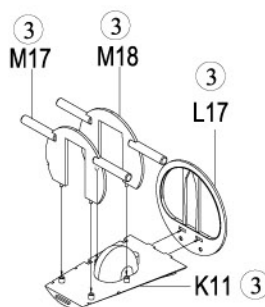
18**19**

Tail gear compartment and catwalk assembly

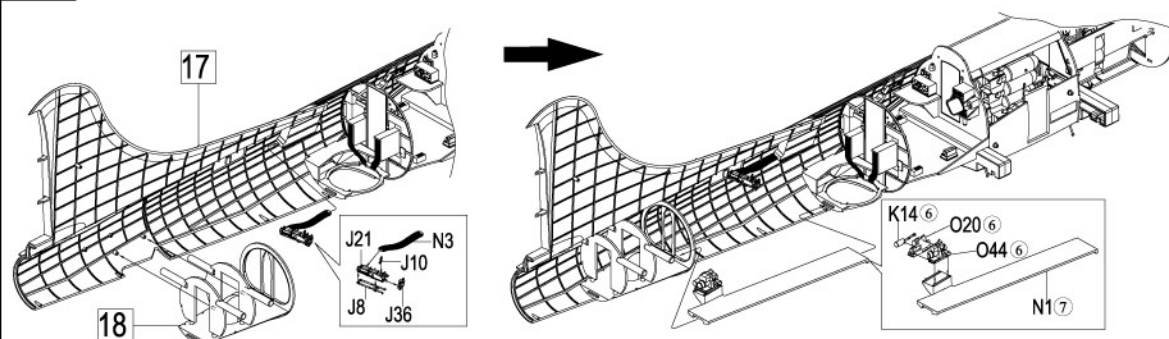
**20**

Waist gun window assembly (right)

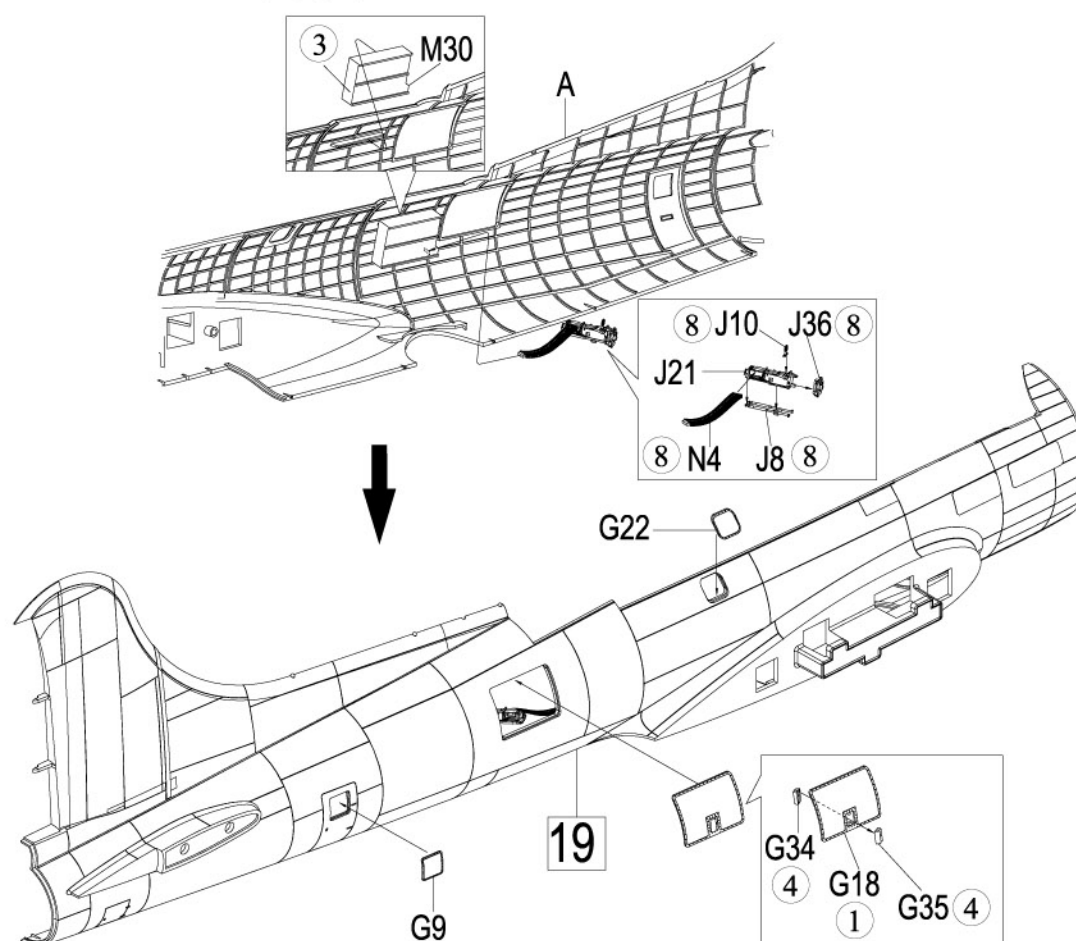
**21**

Mating the two fuselage halves

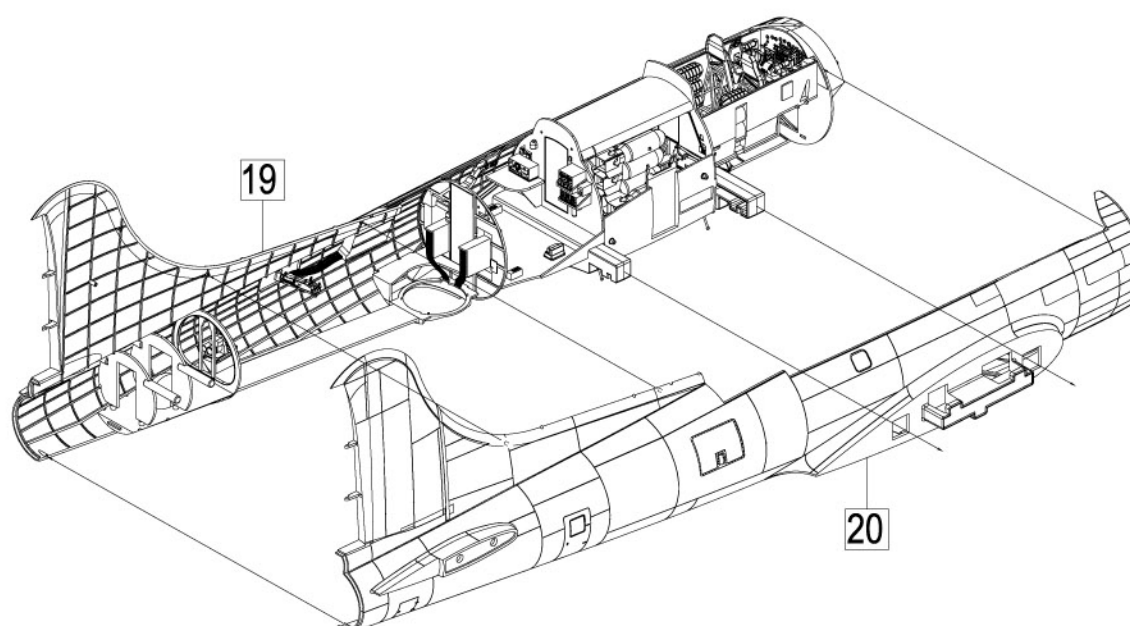
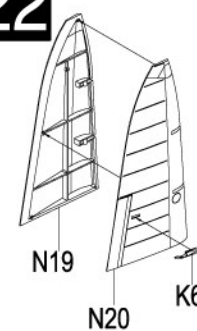
**22**

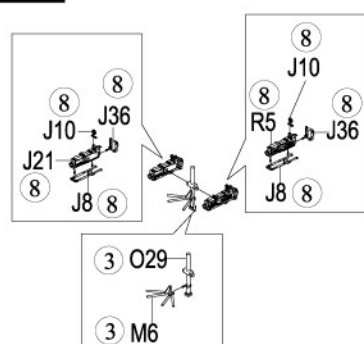
23**24**

Tail section and Cheyenne tail turret assembly

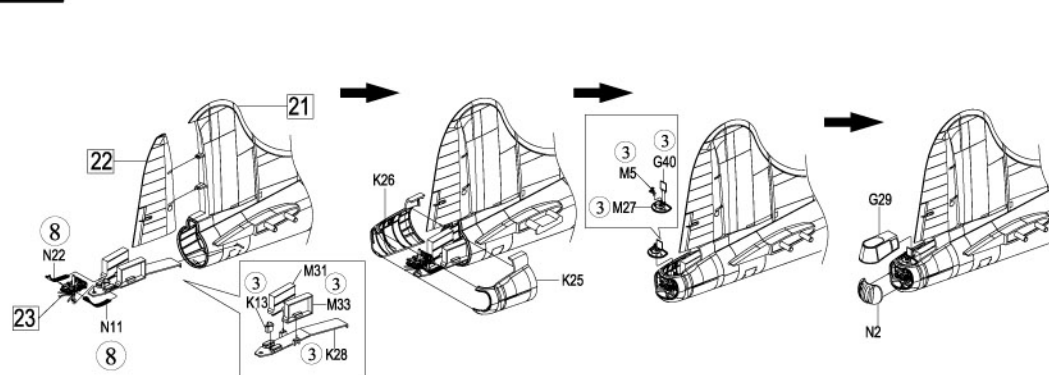
**25**

Radio compartment window and gun assembly; canopy installation

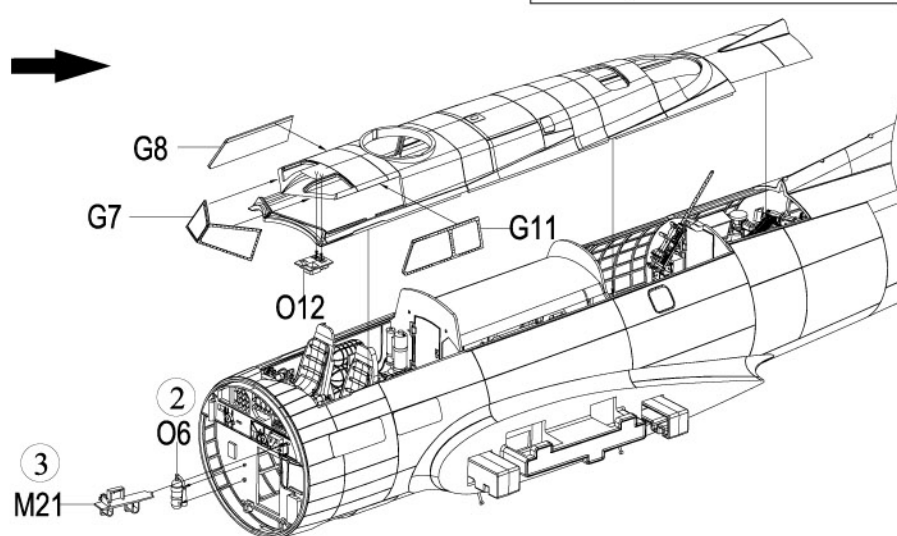
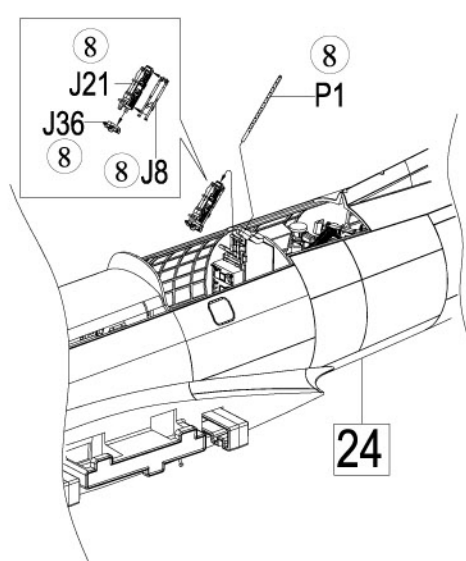

Optional: Leave this piece uncemented to display interior after assembly.

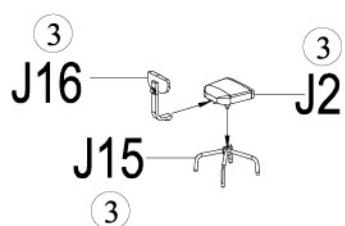
26X2**27**

Bombardier's compartment assembly

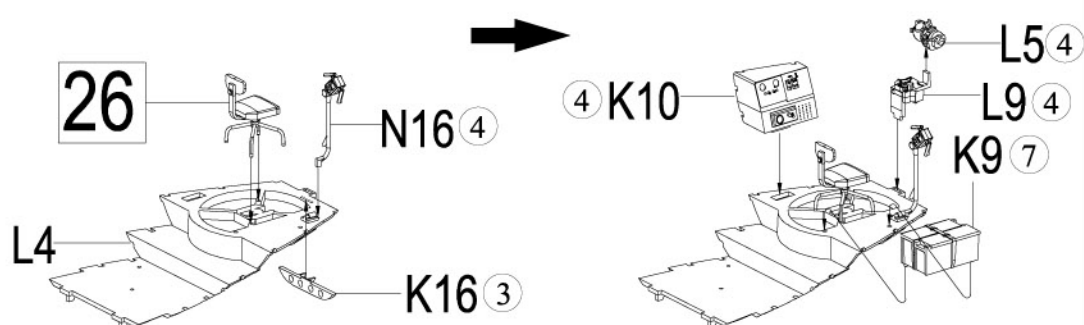
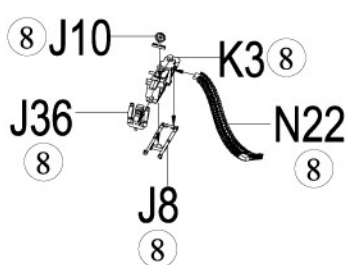
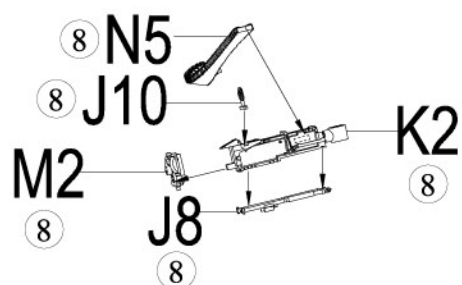
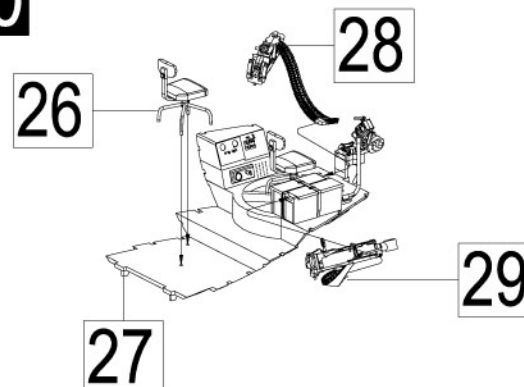
**28****29****30**

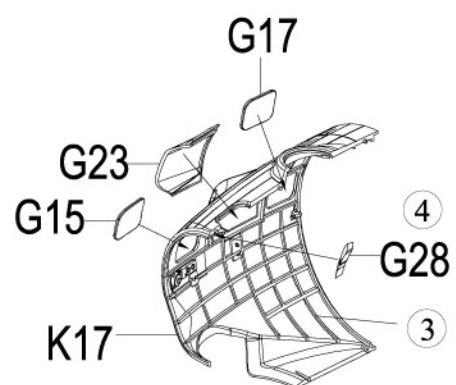
31**32**

Nose assembly

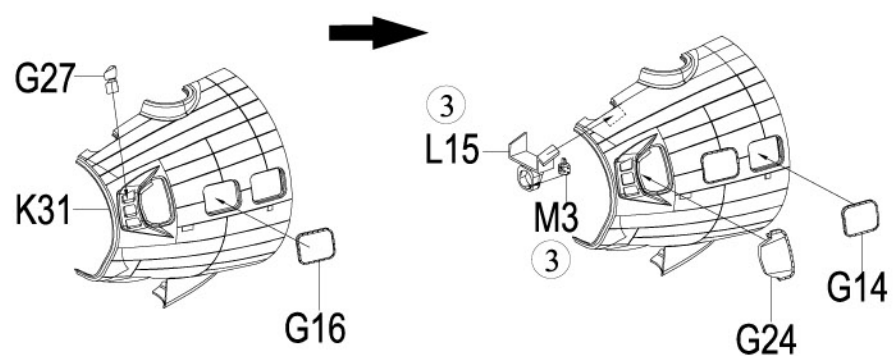
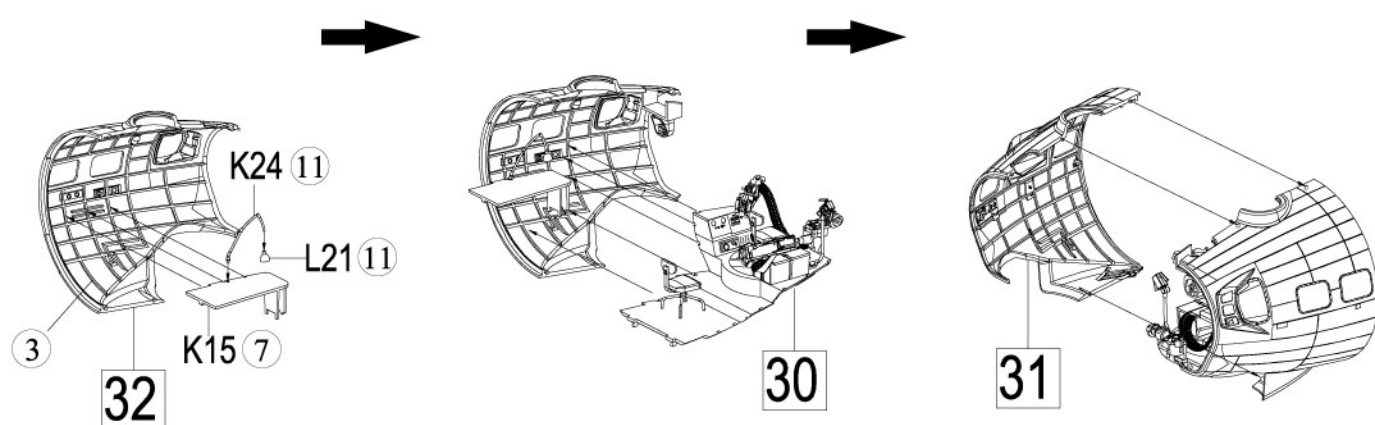
**33****34**

Right horizontal stabilizer assembly

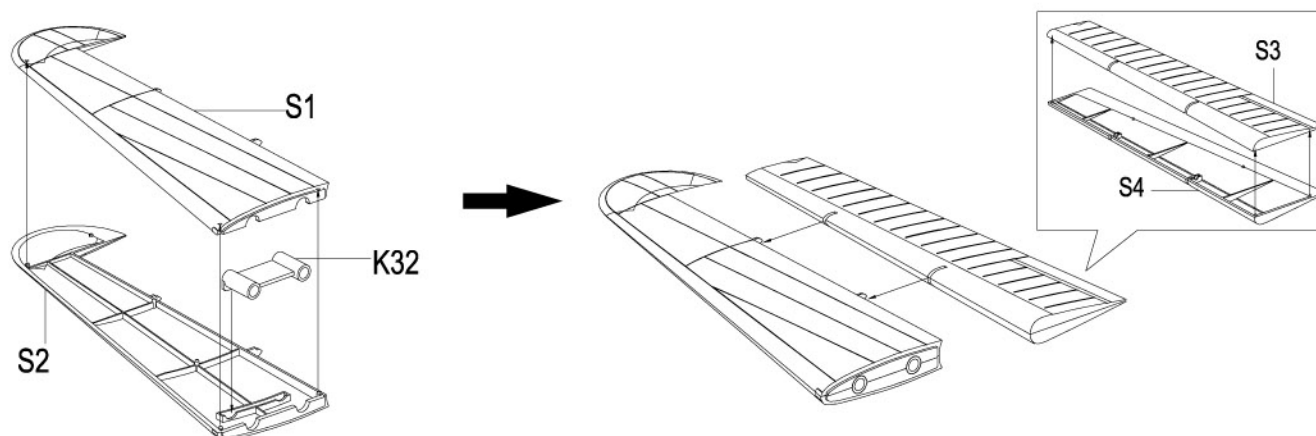
**35**

Left horizontal stabilizer assembly

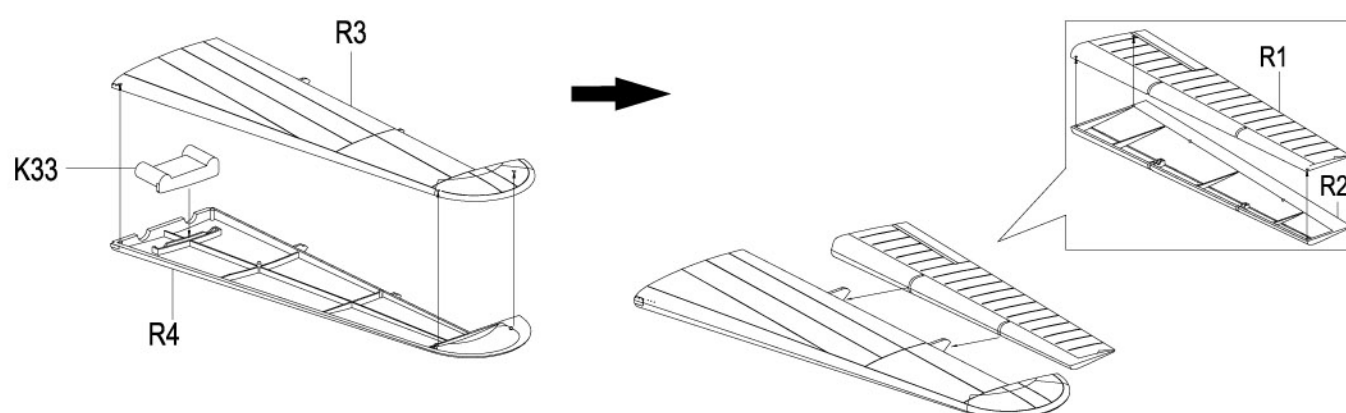

36 Nose and horizontal stabilizer attachment

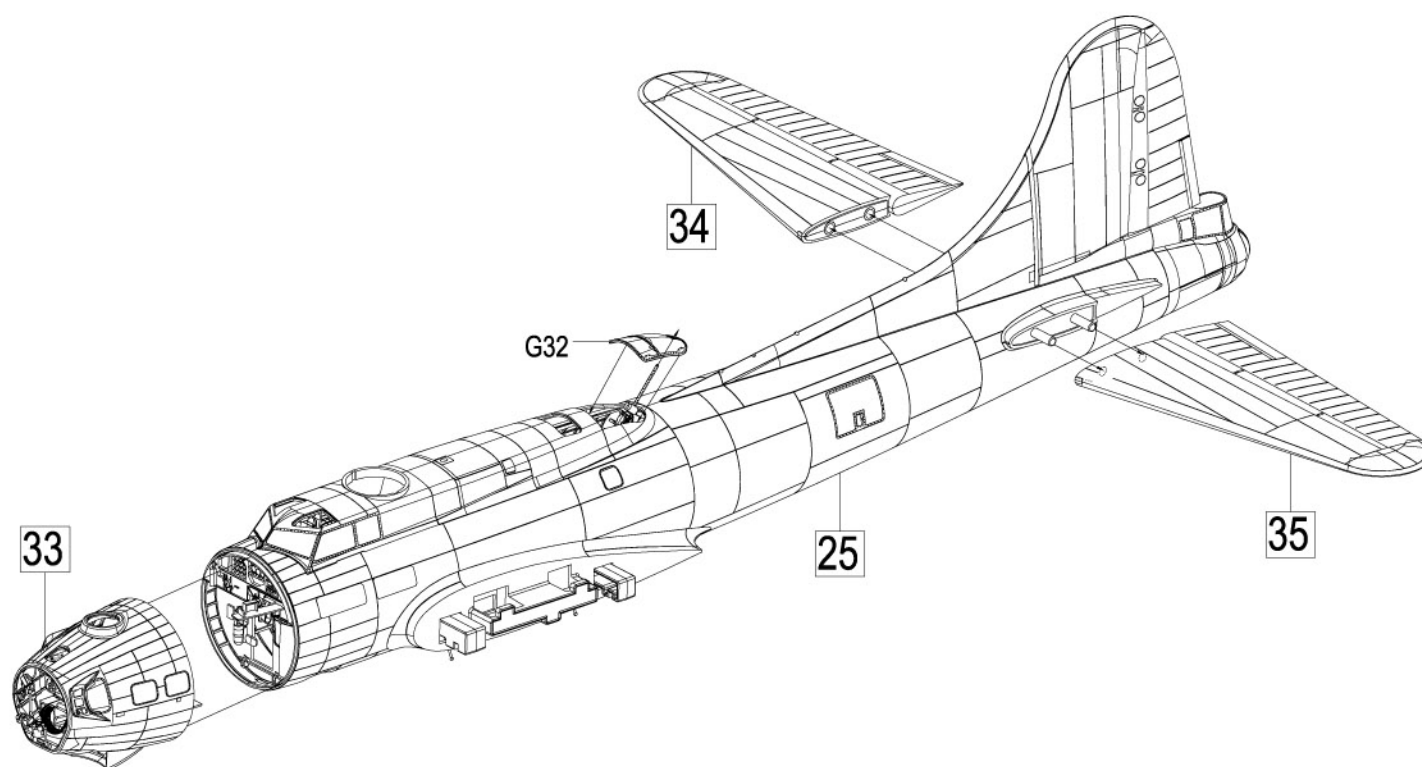

37

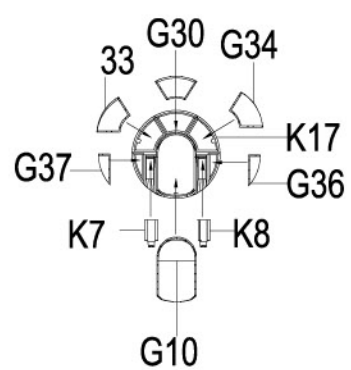

38 Dorsal gun turret assembly

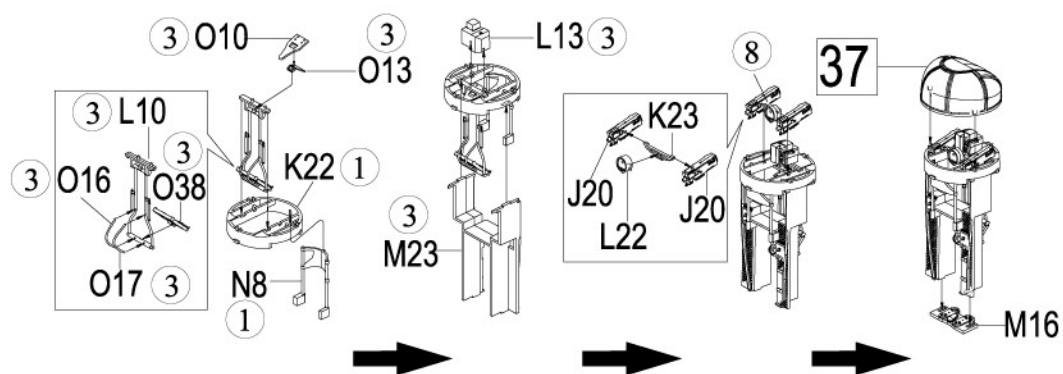

39

Clear part and dorsal gun turret attachment

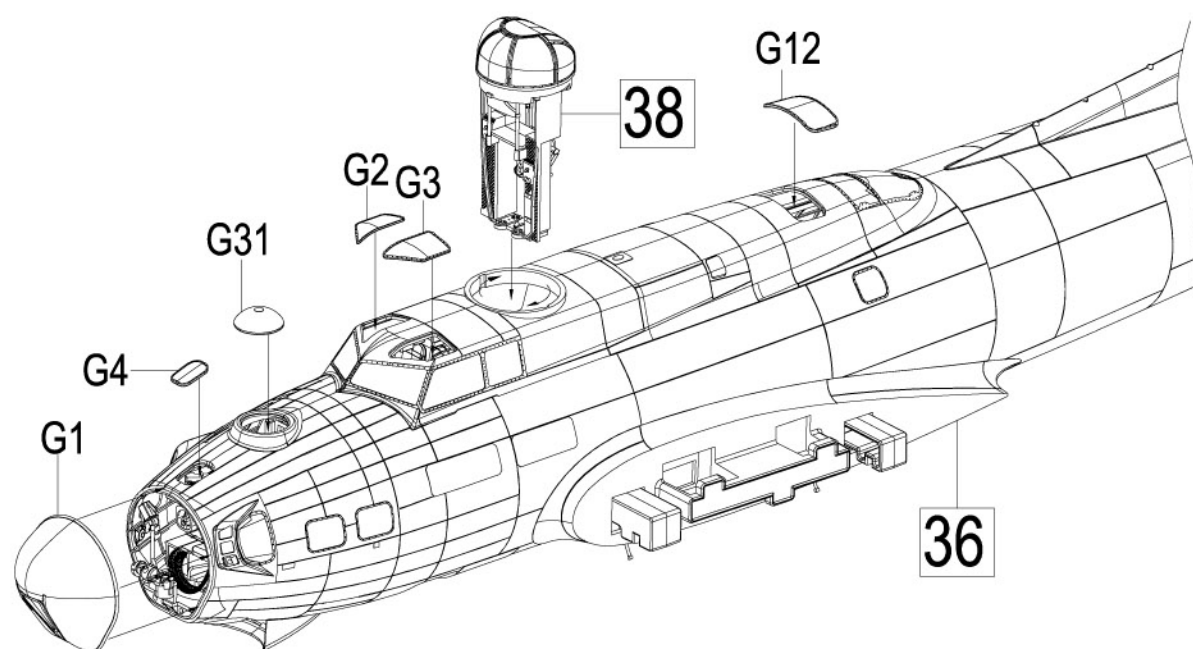

40 Bomb bay door hinge assemble (open position)

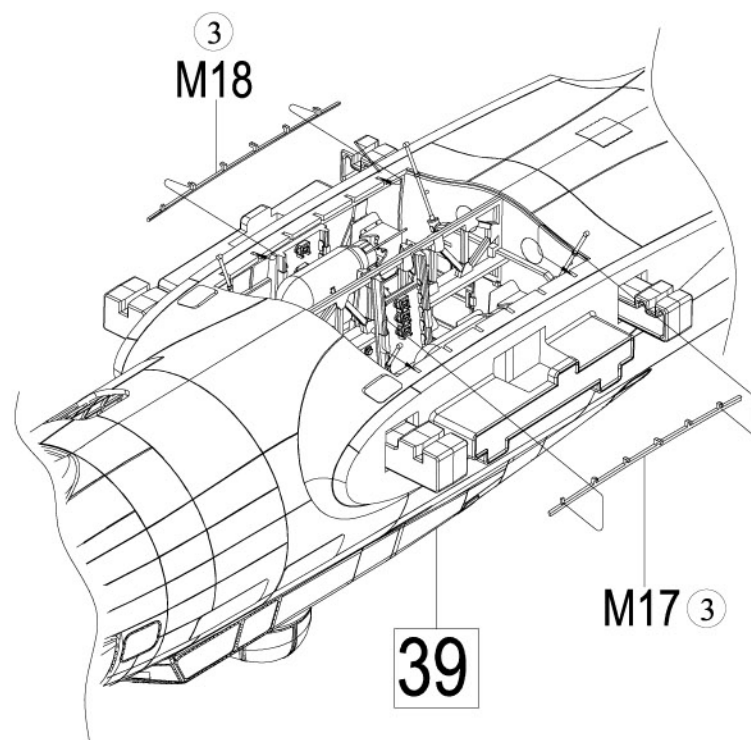

41 Chin turret assembly

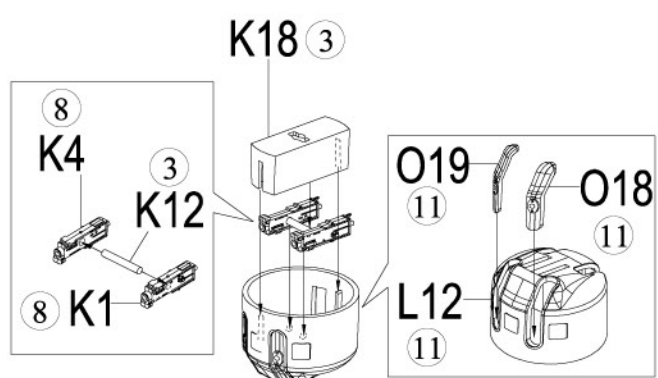

42-1 Tail gear assembly (down position)

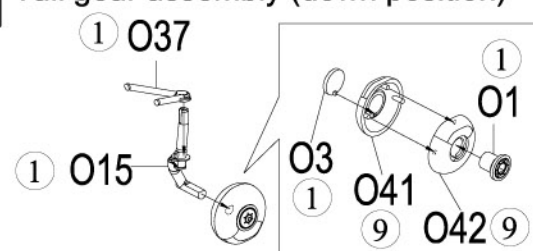

42-2 Tail gear assembly (up position)

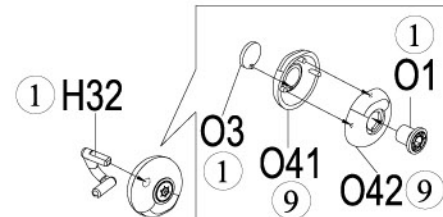

43 Ball turret assembly

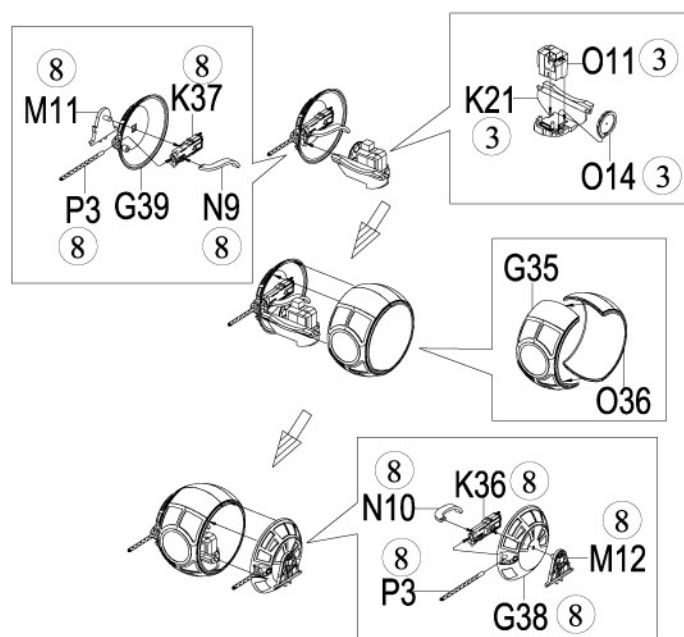

44 Ball turret mount assembly

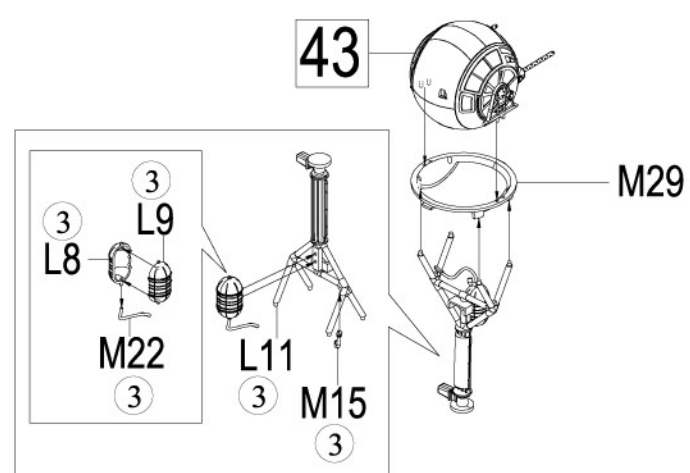

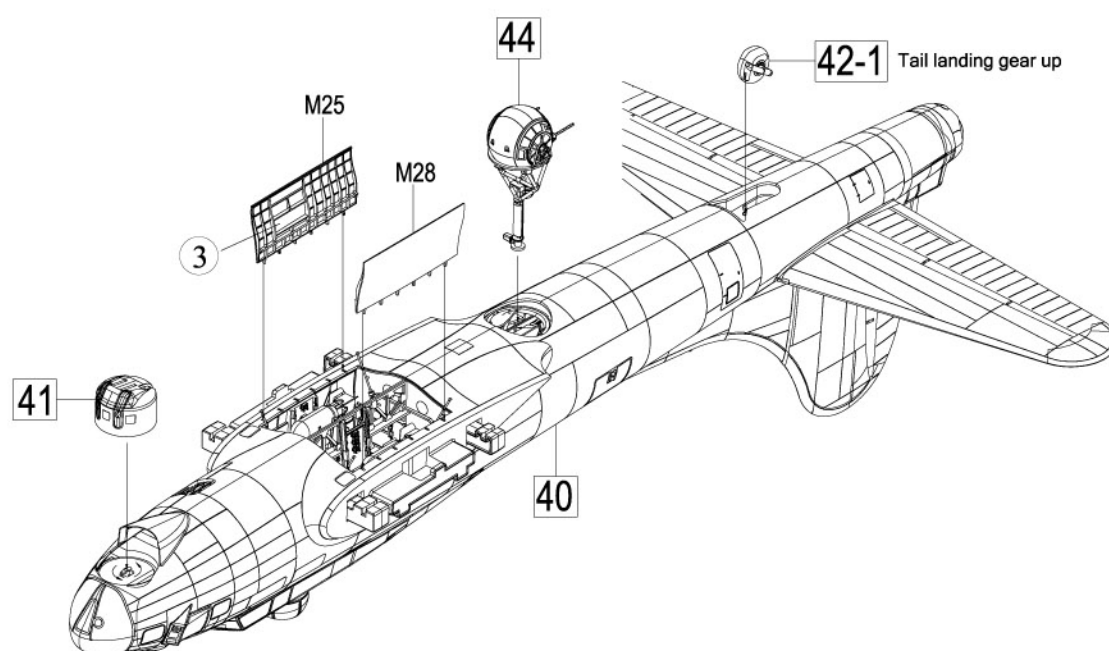
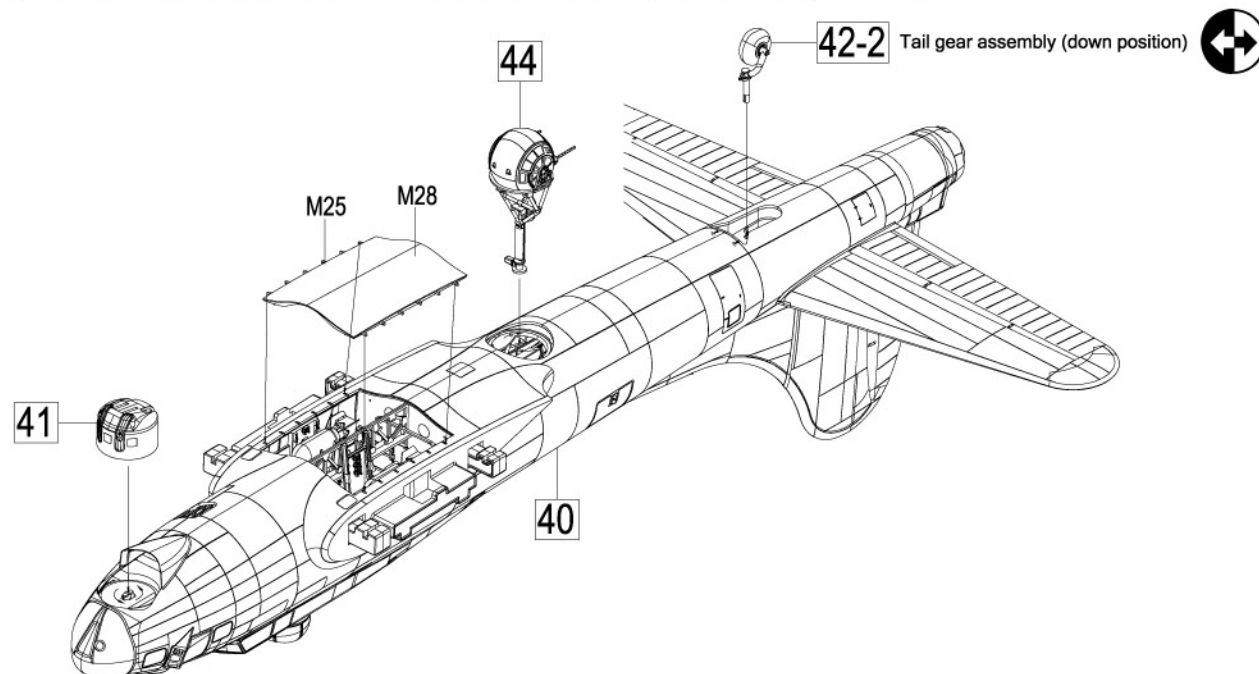
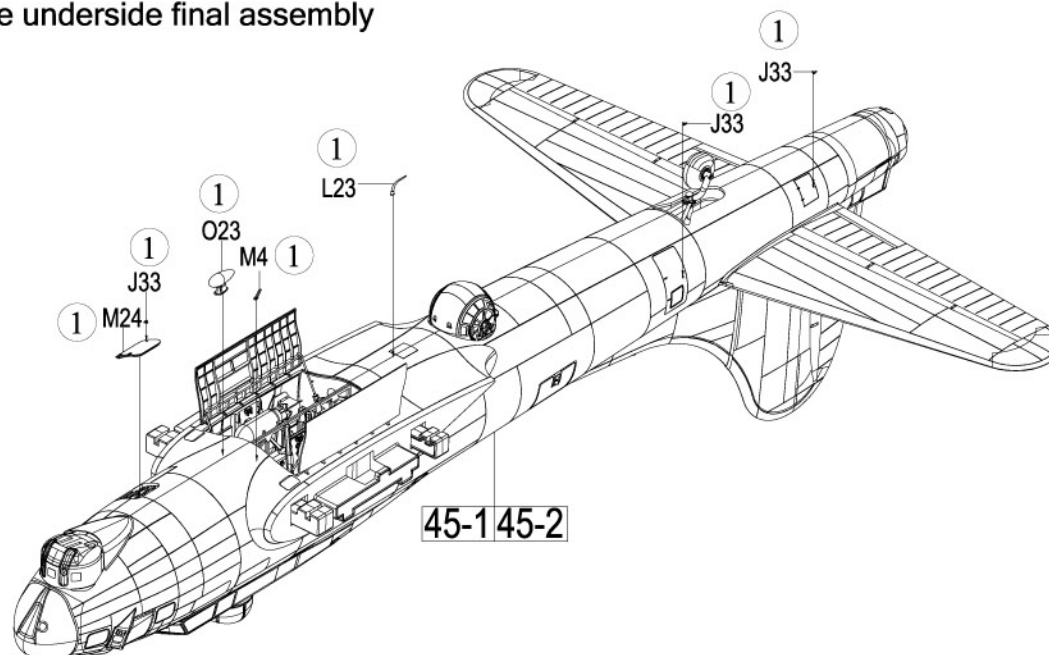
45-1 Fuselage underside components assembly (bomb bay open, gear up)**45-2** Fuselage underside components assembly (bomb bay close, gear down)**46** Fuselage underside final assembly

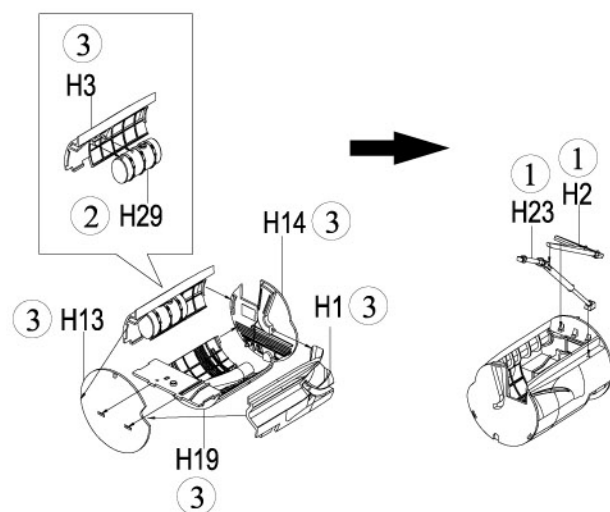
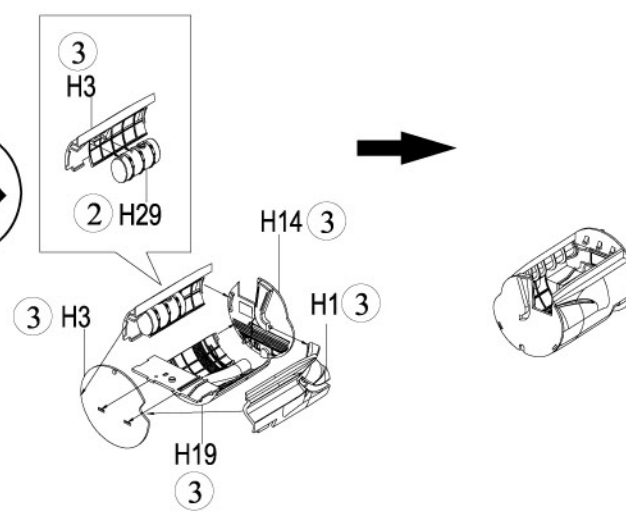
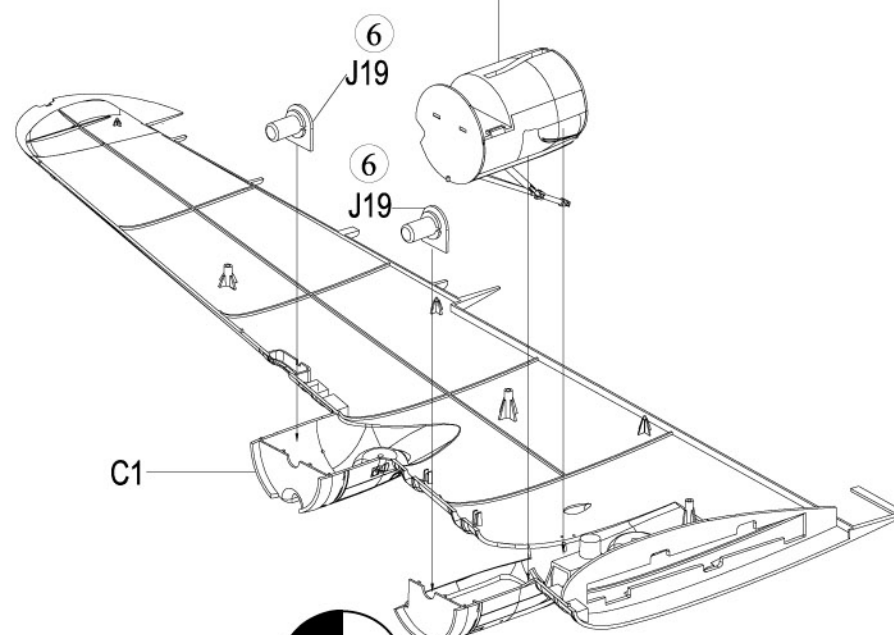
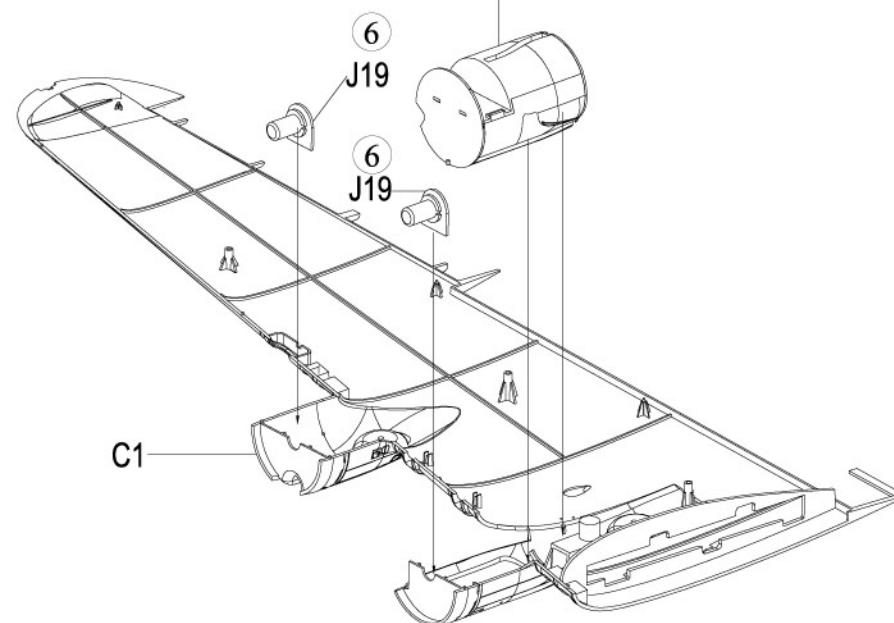
47-1 Main landing gear bay assembly (gear down)**47-2** Main landing gear bay assembly (gear up)**48-1** Main landing gear bay installation (gear down)**48-2** Main landing gear bay installation (gear up)

49 Right wing and supercharger assembly

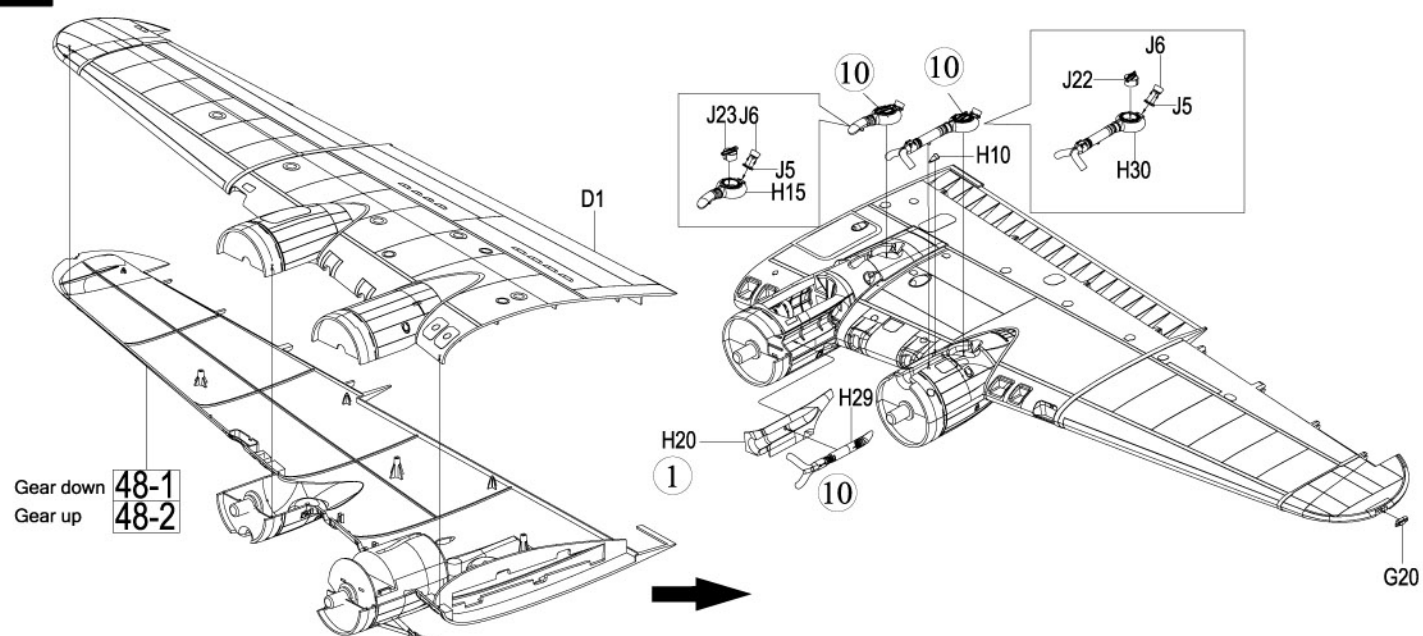

50 Right wing and control surface assembly

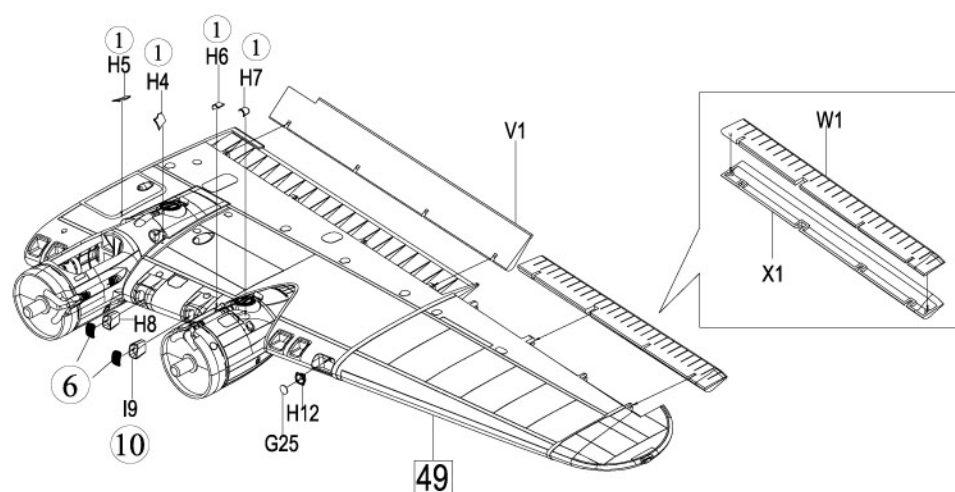

51X4

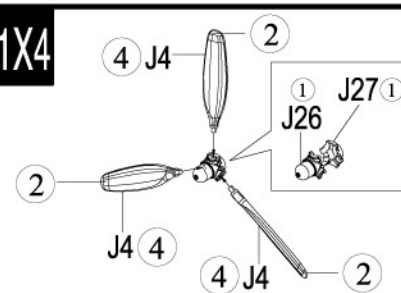

52X2

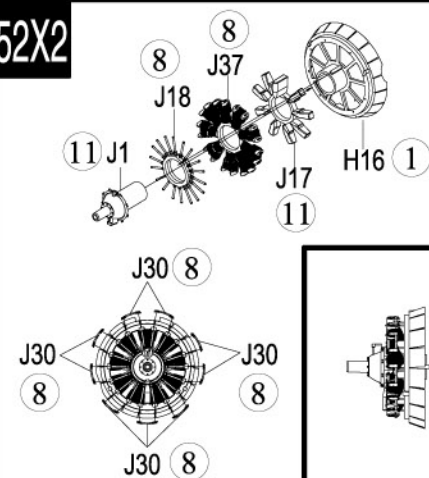

53

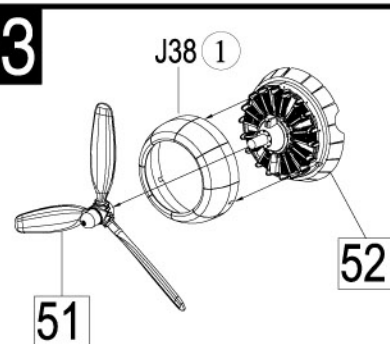

54X2 Engine assembly

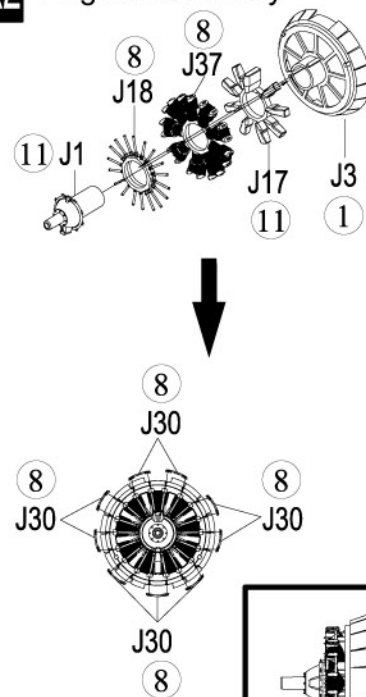

55X2

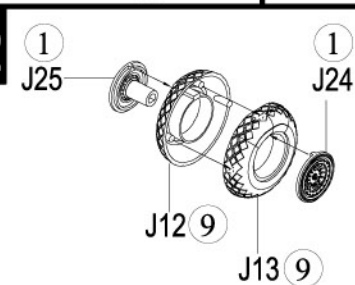

56-1 Main landing gear assembly

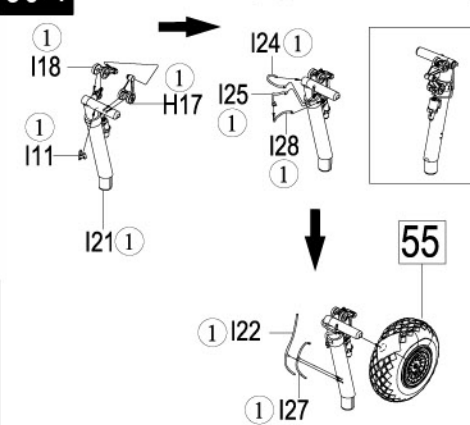

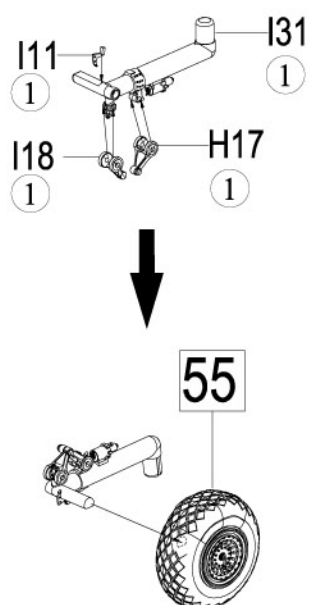
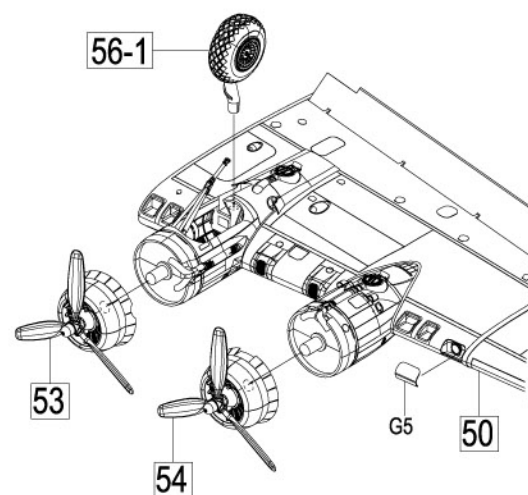
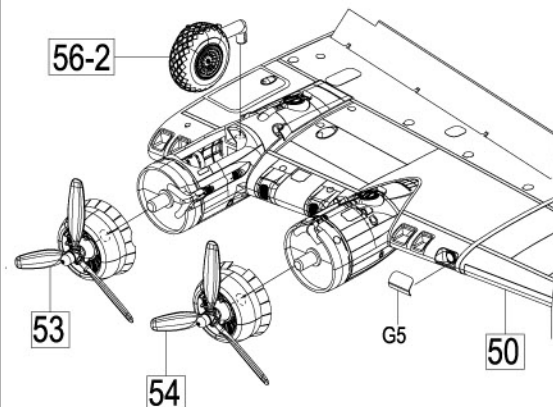
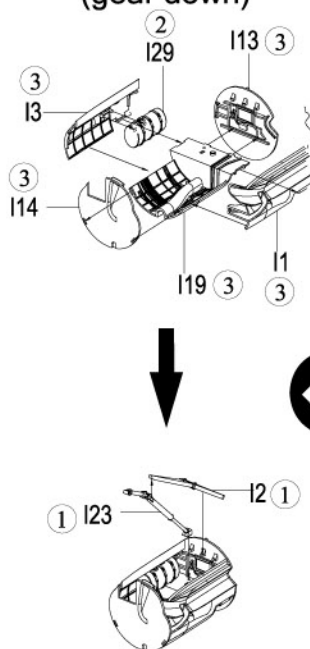
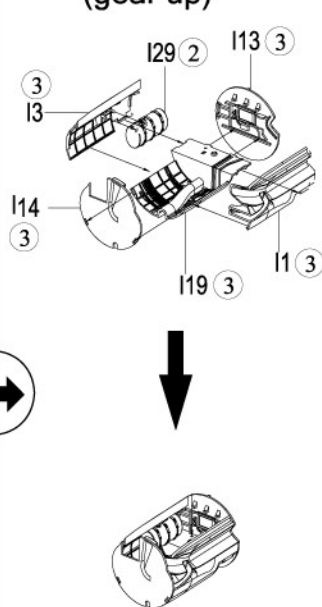
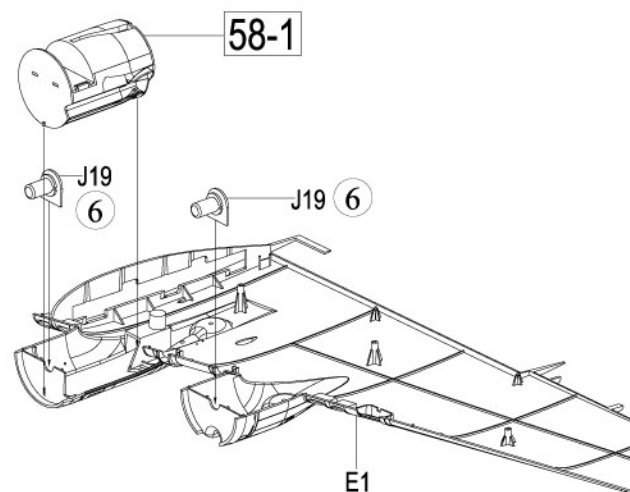
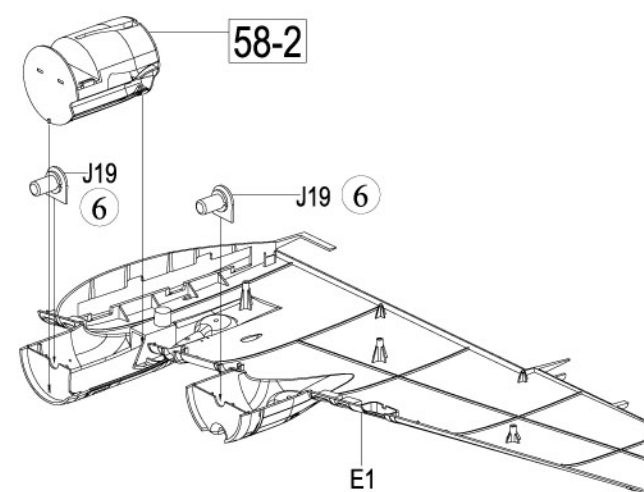
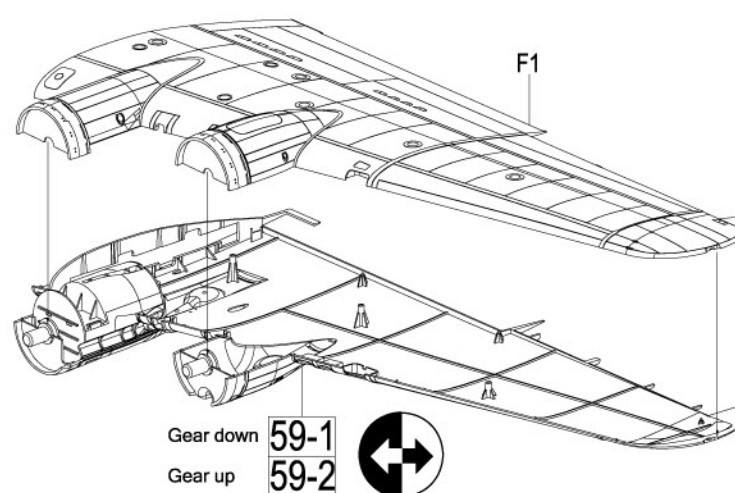
56-2 Main landing gear up**57-1** Main landing gear down**57-2** Main landing gear up**58-1** Landing gear bay assembly (gear down)**58-2** Landing gear bay assembly (gear up)**59-1** Installation of landing gear bay (gear down)**59-2** Installation of landing gear bay (gear up)**60** Left wing assembly

61

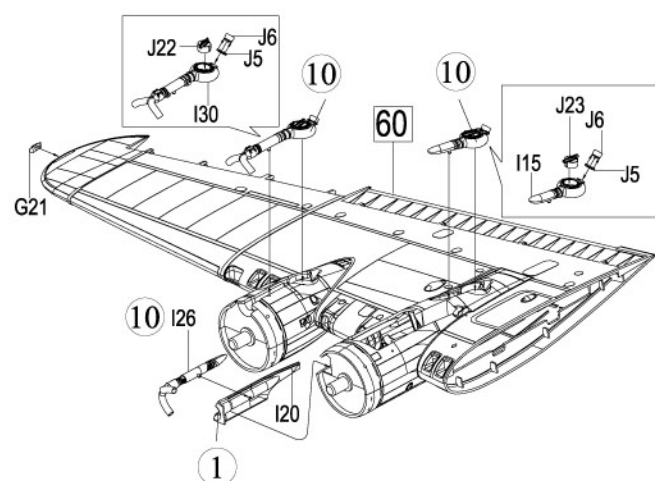

62

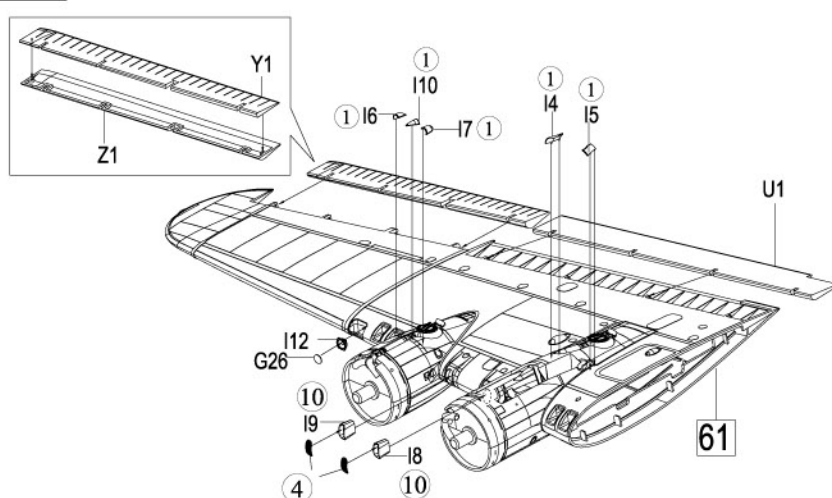

63

Engine assembly

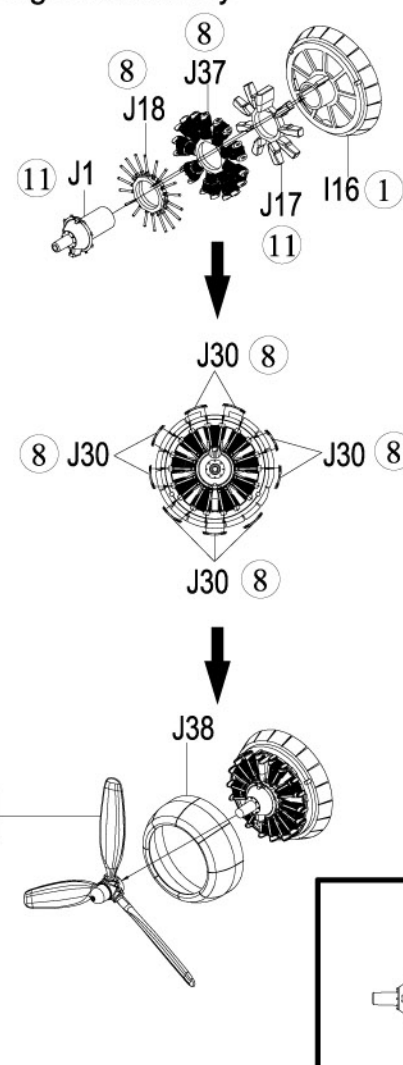

64-1

Main landing gear assembly (gear down)

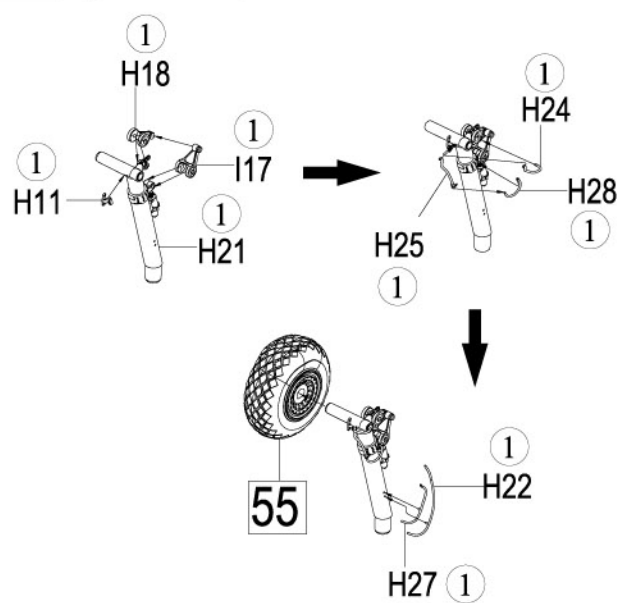

64-2

Main landing gear assembly (gear up)

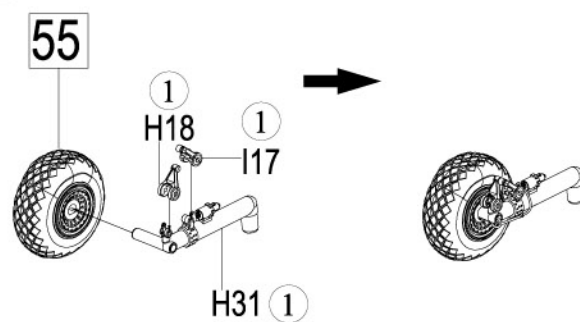

65-1

Gear down position

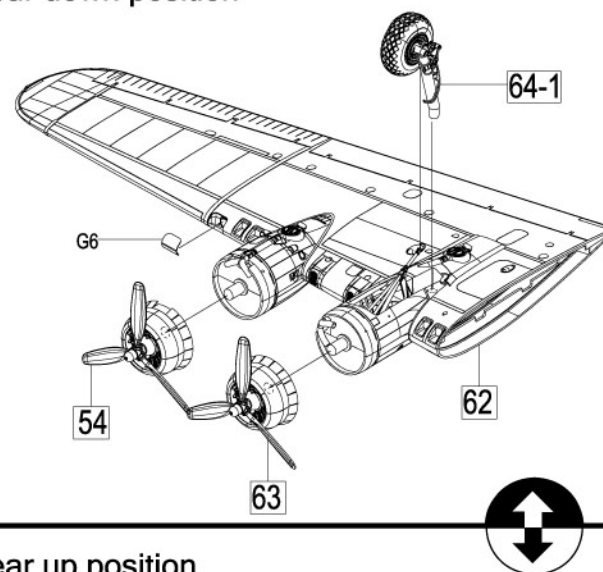

65-2

Gear up position

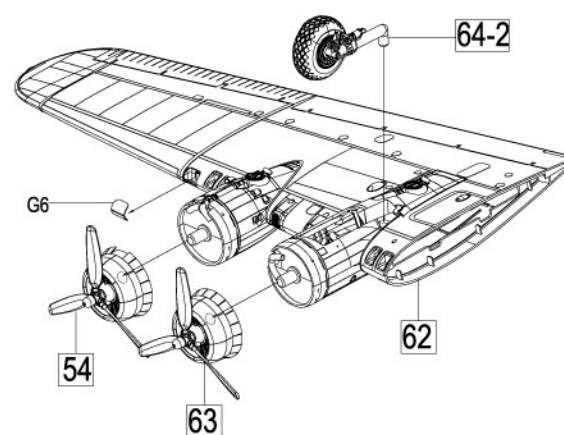

66 Final assembly

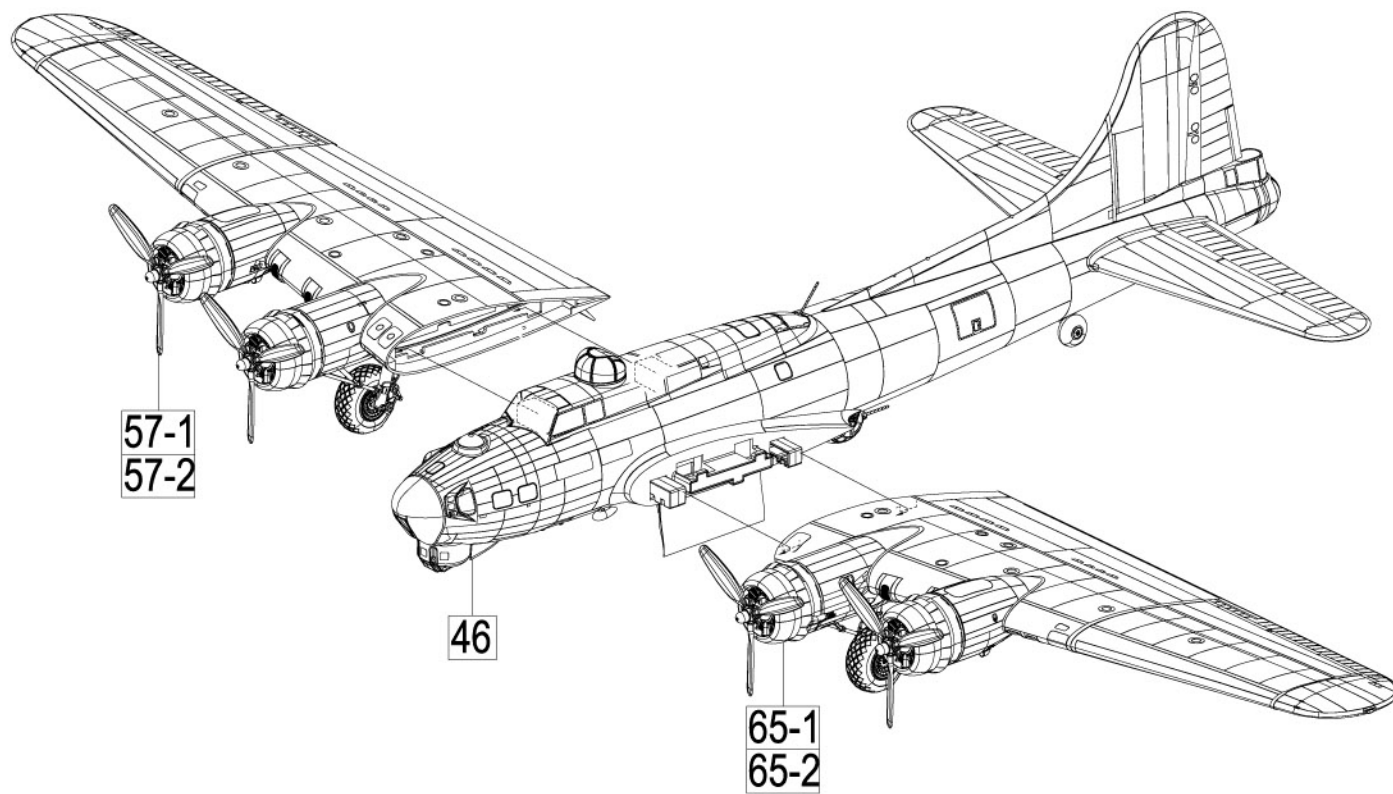

67

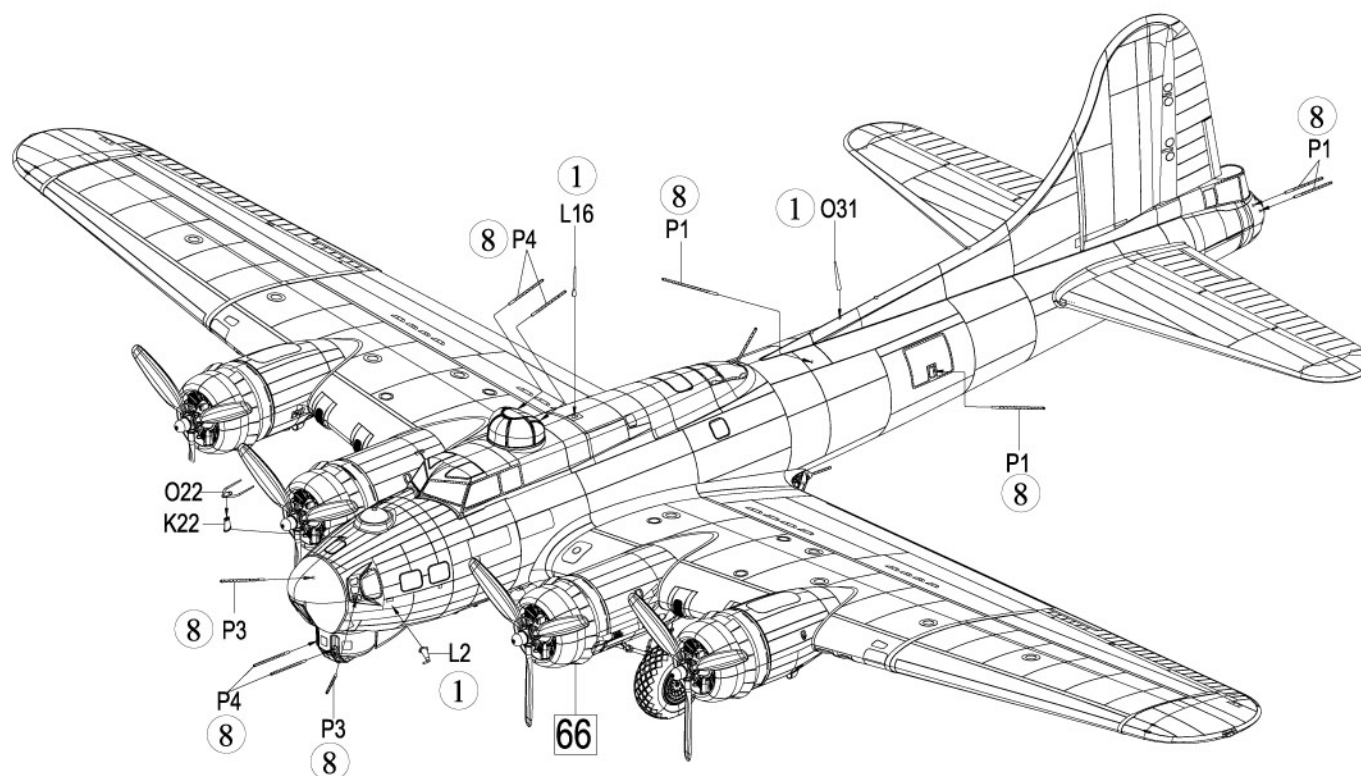

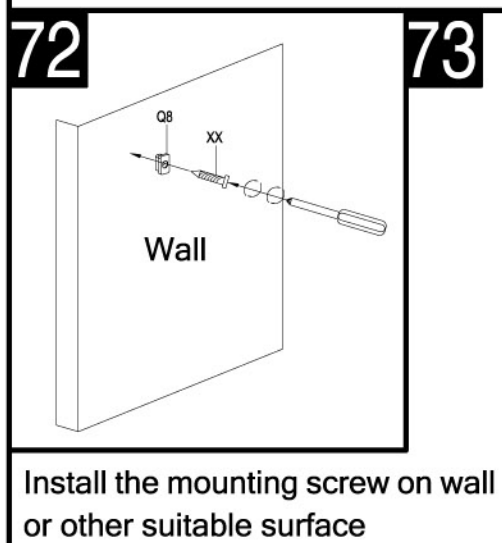
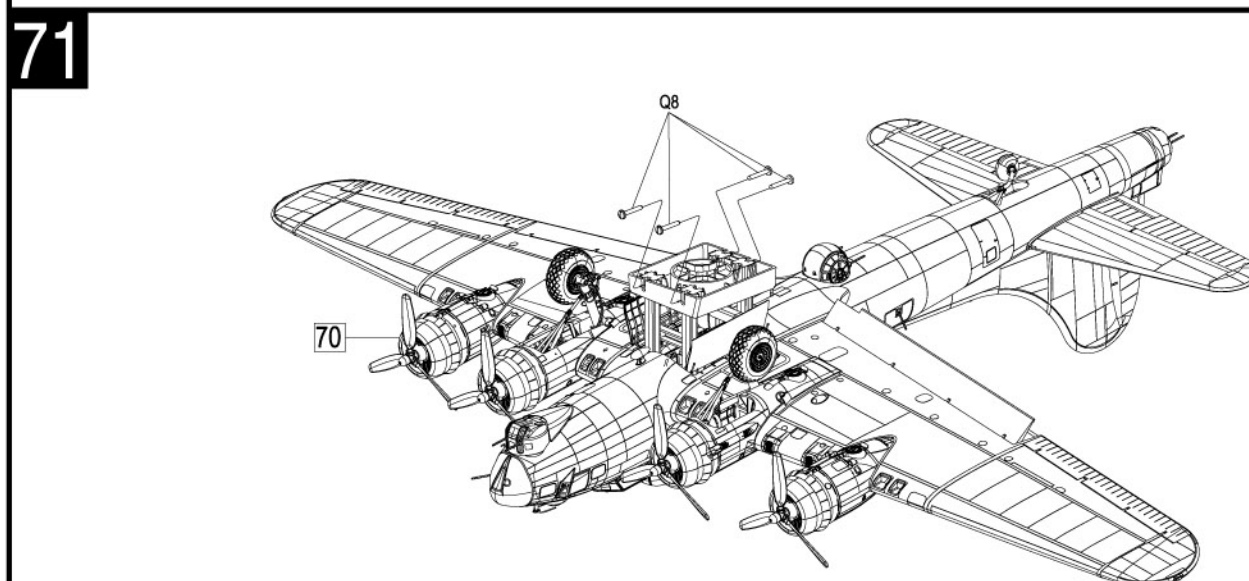
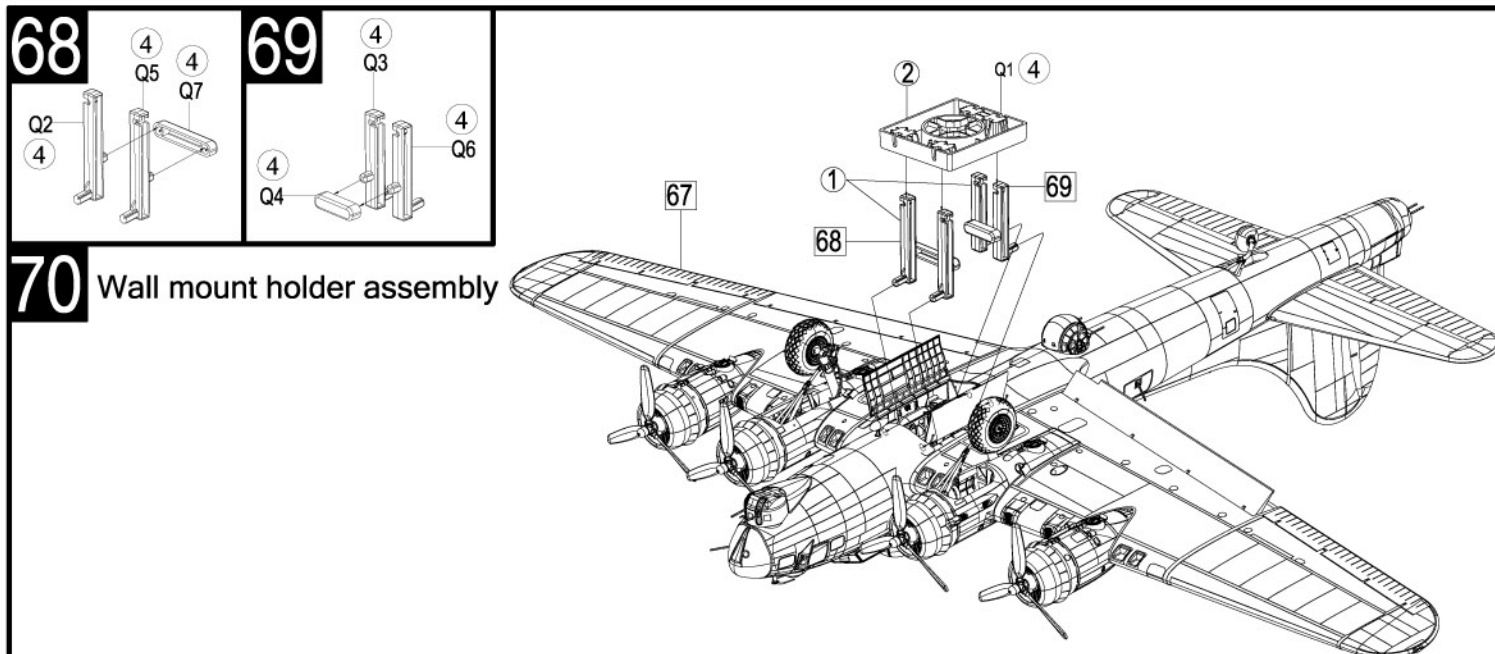

You can adjust the display angle with the wall mount holder

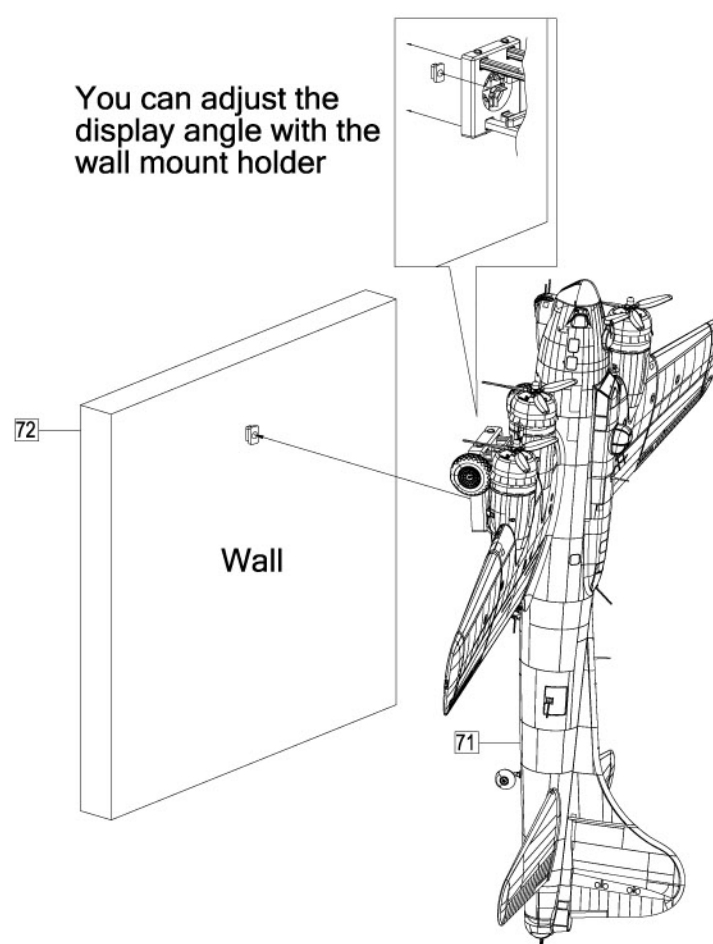

74 Painting and decal placement

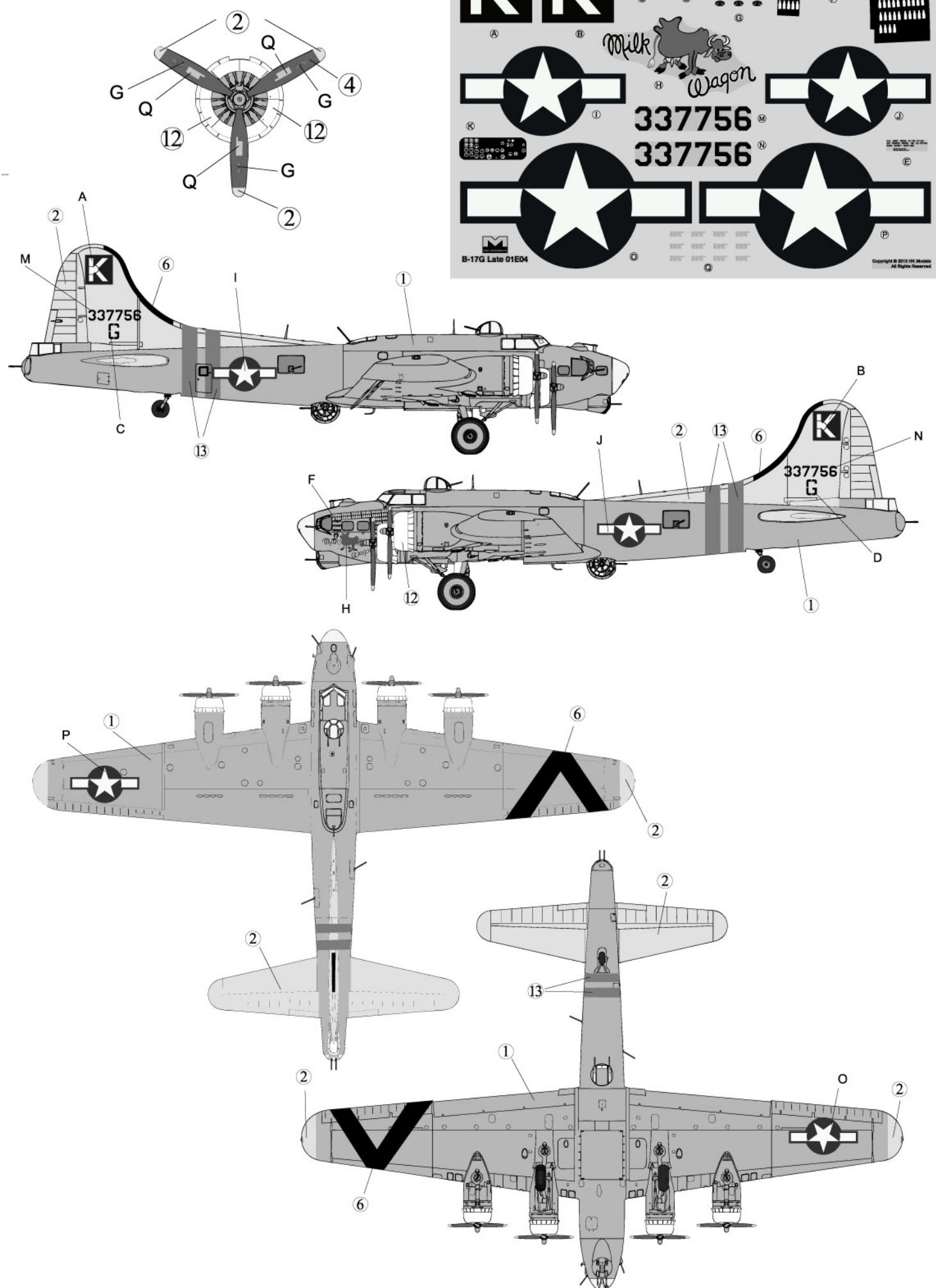

Hong Kong Models Co., Ltd

Address: Flat 12, 12/F., Block A, Tak Lee Industrial Center. Ching Yeung Street. Tuen Mun. N.T. Hong Kong.

Tel: 852-2464 9813 Fax: 852-2626 4864

Website: www.hk-models.com E-mail: info@hk-models.com