

1/32  
SCALE

# B-17E/F Flying Fortress

The Boeing B-17 'Flying Fortress' was one of the U.S.A.'s main four-engine heavy bombers, operating alongside the B-24 Liberator, and the later B-29 Superfortress, in all theatres of World War 2. It's a fact that the B-17 almost never saw its place in history and the defeat of Nazi Germany, as the prototype, known as Model 299, crashed due to pilot error during its evaluation in October 1935. Thankfully, the design had shown such promise during the testing phase, in fact exceeding the requirements of the original specification, that further prototypes were ordered despite Boeing losing the original contract with the United States Army Air Corps. It was this further evaluation that saw the type enter active service in 1938. The actual name 'Flying Fortress' was coined by a newspaper hack who witnessed a roll-out of the machine, bristling with guns and turrets, and Boeing realised that this was the sort of propaganda they needed, and trademarked the name. After the initial prototypes, serial production of the B-17 began with the B-17B variant, and underwent a major revision with the introduction of the 'E'. This type featured a substantially redesigned tail and fillet that featured throughout subsequent versions, giving the B-17 its iconic profile. An extra 10ft of length was added to the fuselage. Other refinements included the addition of a tail and dorsal turret, and

the addition of a Bendix turret to replace the fixed bathtub type that had graced previous versions. This was found to be disappointing, and was eventually replaced with the Sperry ball turret that became a permanent feature of all future marques.

Differences between the E & F versions were mostly changes in nose armament layout, with staggered cheek guns being implemented, and a change in the bombardier's glass nose, although this would vary occasionally between machines, with a number of sub-types and adaptations being fitted. Other changes included engine cowlings with rounder forward radius, paddle-blade prop blades and strengthened undercarriage that allowed the internal bomb load to double from 4000lb to 8000lb.

The B-17E/F was powered by 4 × Wright R-1820 "Cyclone" turbocharged radial engines that were constantly uprated over the service life of the B-17, and also carried 11 × .50cal M2 Browning machine guns, with a twelfth being sometimes fitted in the glass nose. Wingspan was 103ft 9in, with a length of 74ft 4in. A crew of 10 was typically carried by the B-17.



BE CAREFUL



REMOVE



GLUE TOGETHER



PLEASE WAIT FOR A FEW MINUTES UNTIL DRY



MAKE 2 PIECES



DRILL HOLE



DO NOT GLUE



INSTANT GLUE FOR METAL



BEND



FILL HOLE



SEQUENCE OF WORK



OPTIONAL



USED COLOUR



APPLY DECAL



MARKING OPTION

## CAUTION

When using both glue and paint, do not use these near an open flame, due to the flammable properties of these items.

The symbols provided, such as 'X', refer to the basic colours of parts, although a more comprehensive list is supplied for your use for Tamiya, Mr Hobby and AK-Interactive codes.

When removing parts from sprues, take extreme care. Consider correct tools such as Xuron Sprue Cutters

Please check the symbology on the left and familiarise yourself before building this model kit.

In cooperation with:



www.ak-interactive.com



Large Scale Modeller

www.largescalemodeller.com

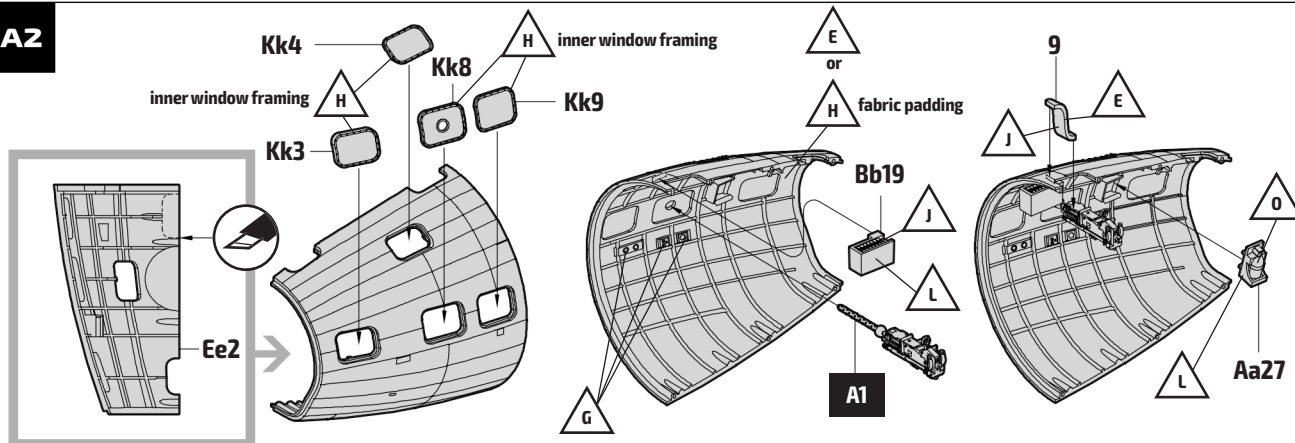

**A2****A3**

x2

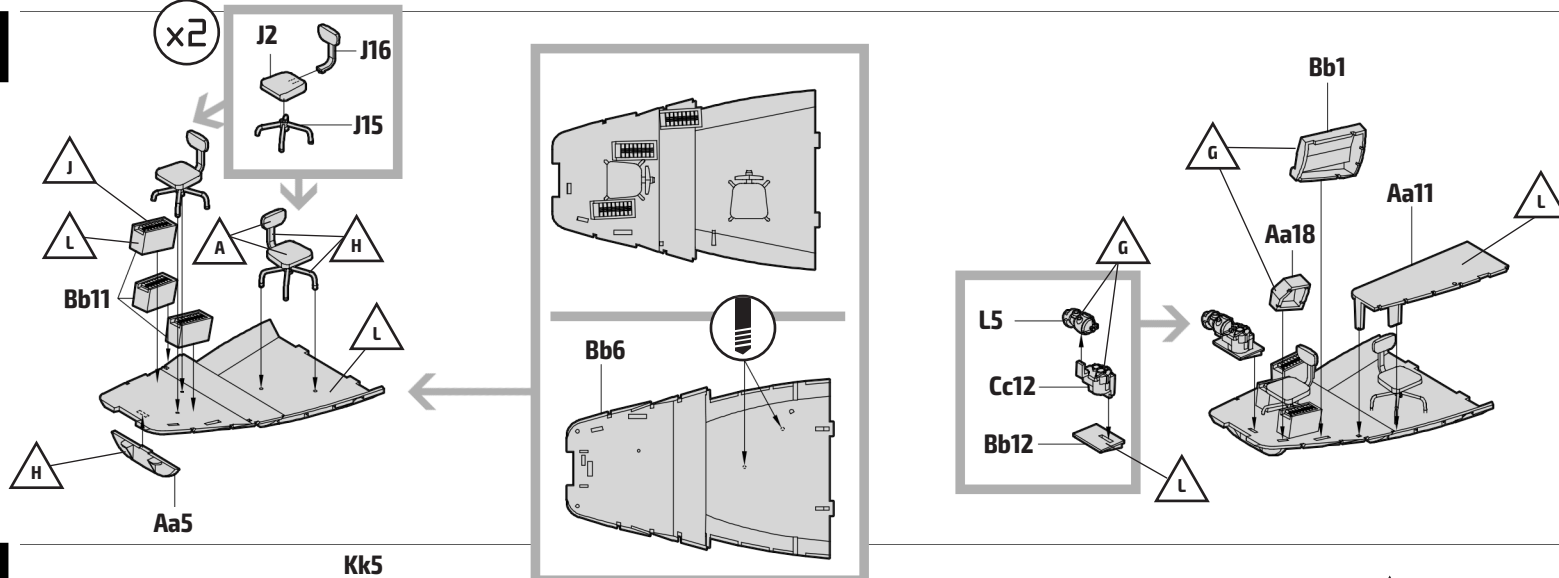

**A4**

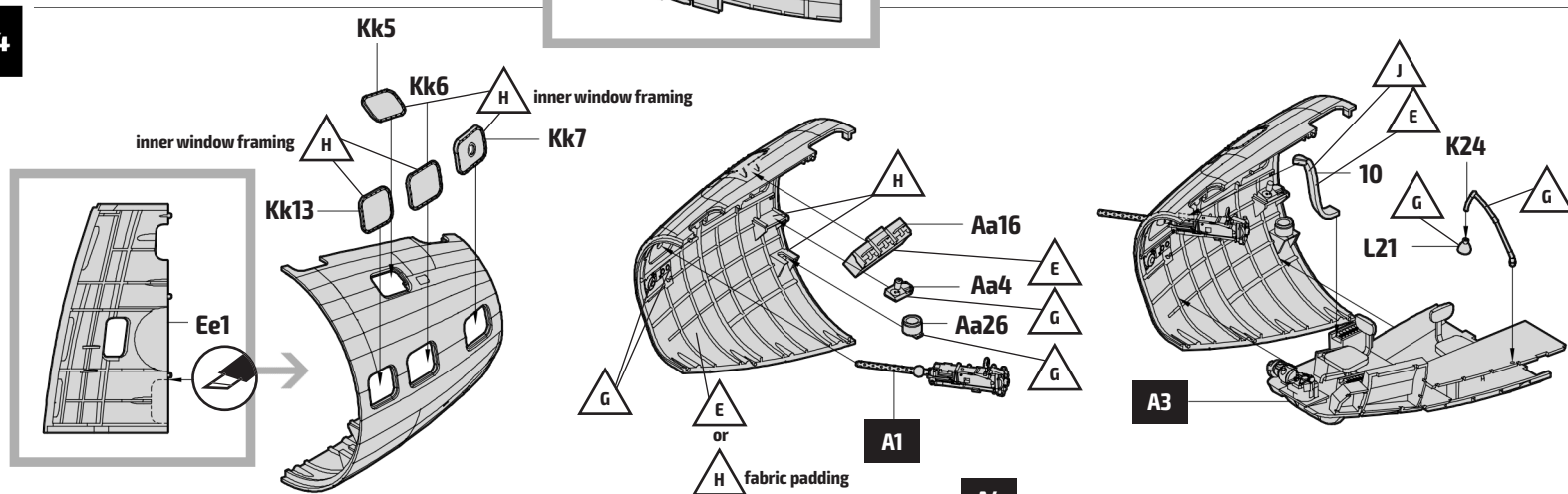
**A5**

x2

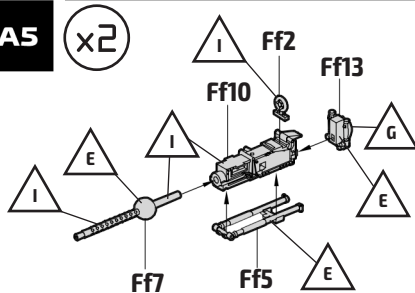

## A6

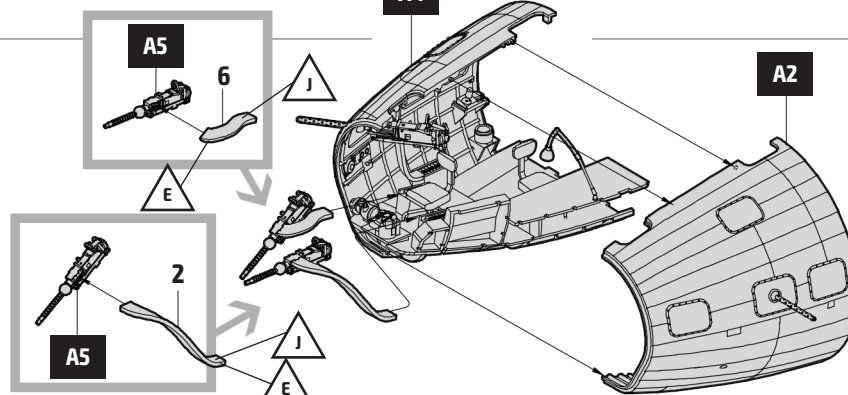
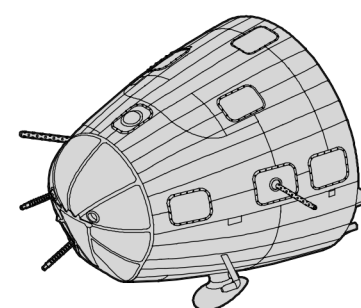
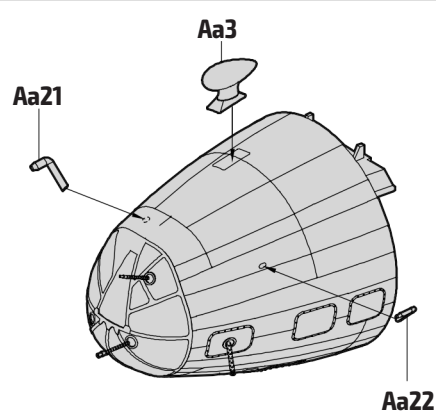
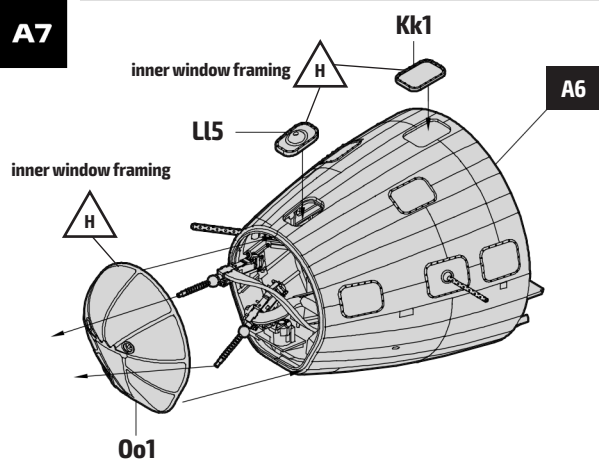
**A7**

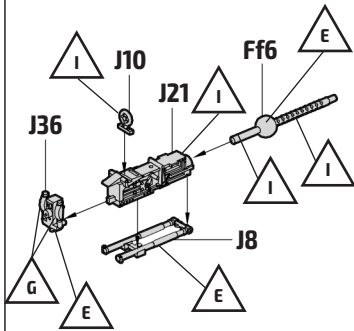
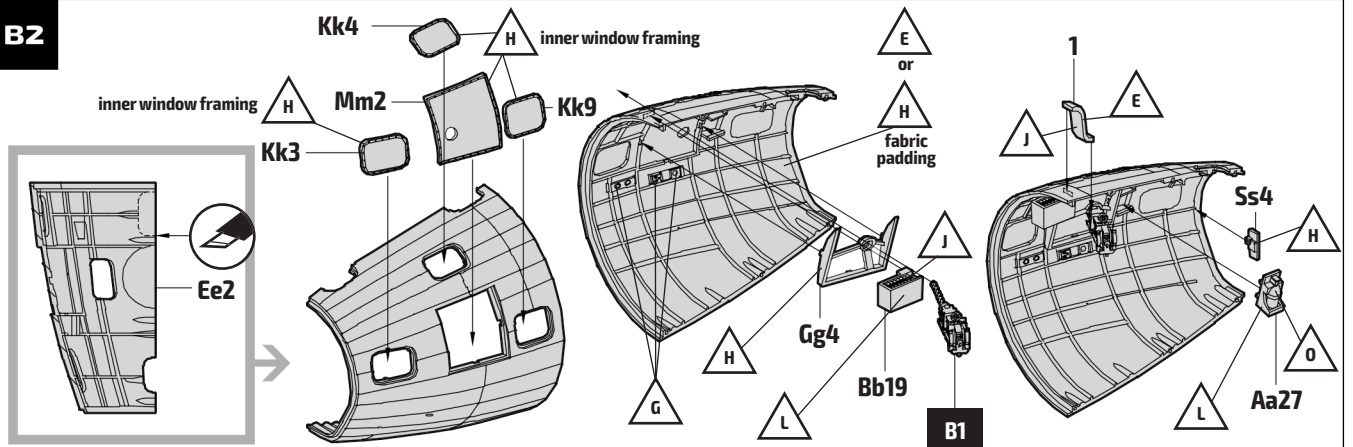
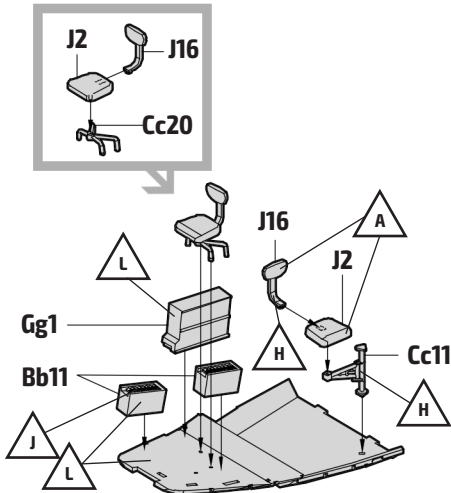
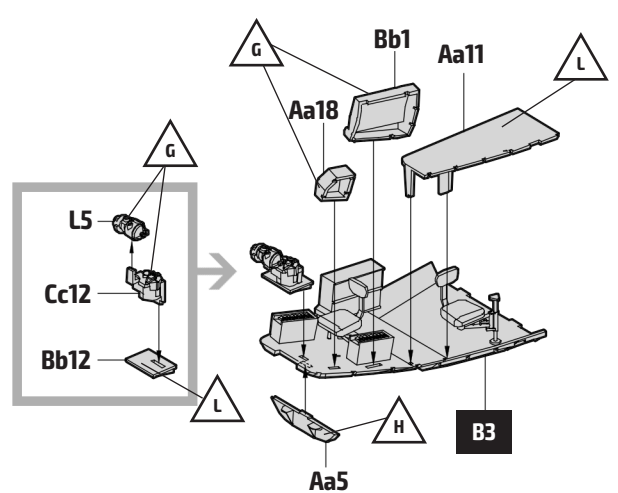
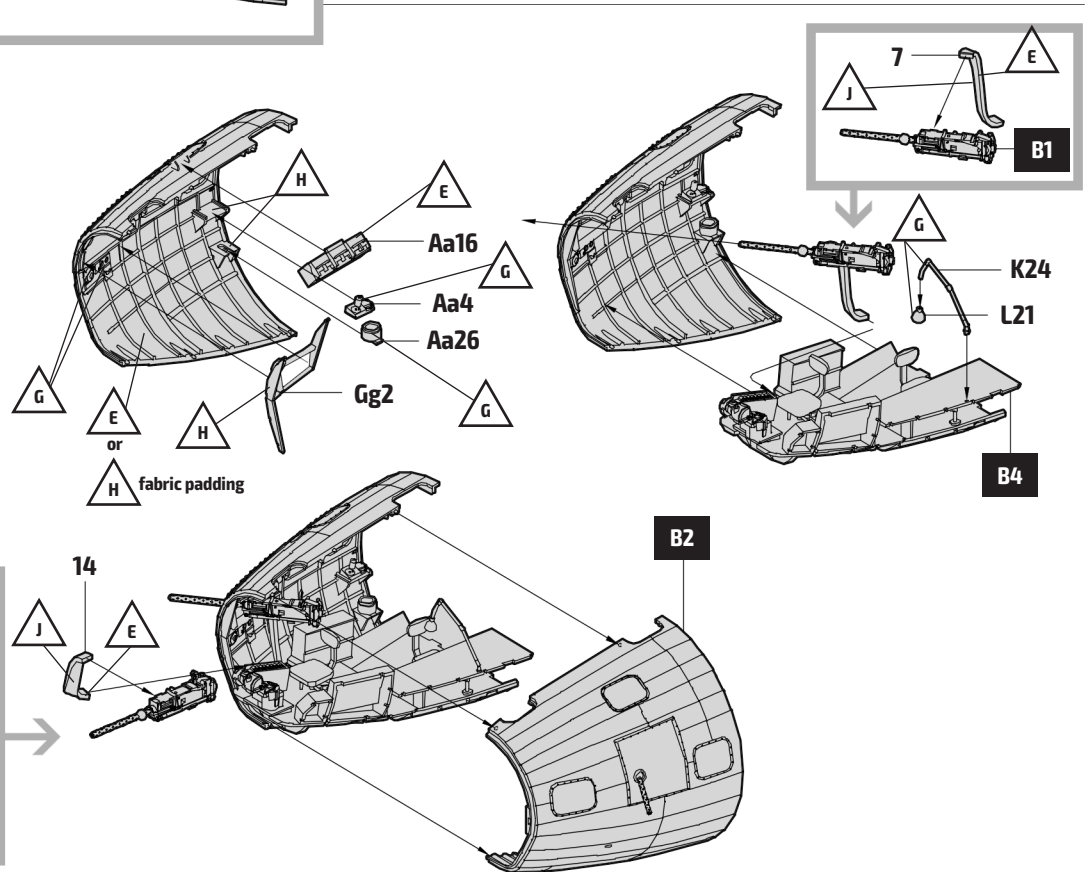
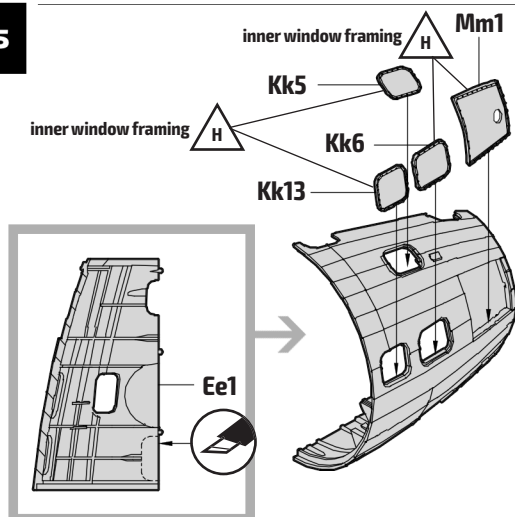
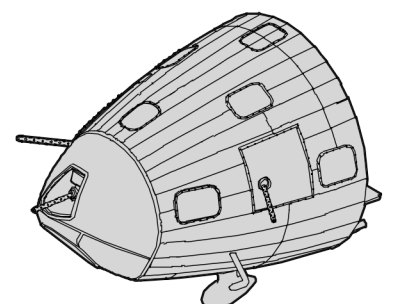
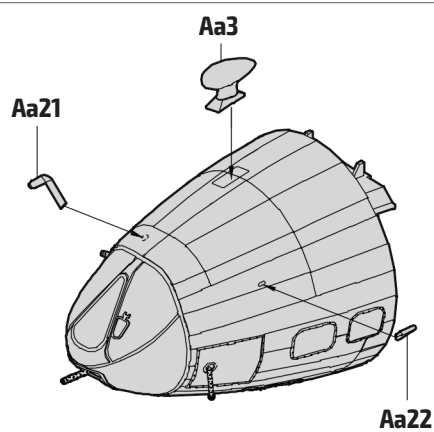
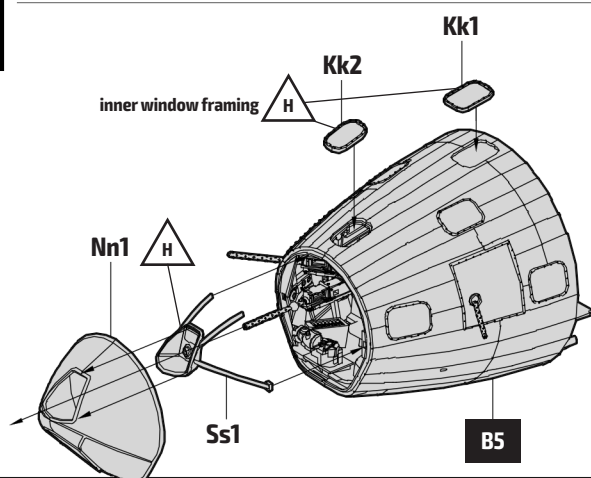

**B****B1****x2****B2****B3****B4****B5****B6**

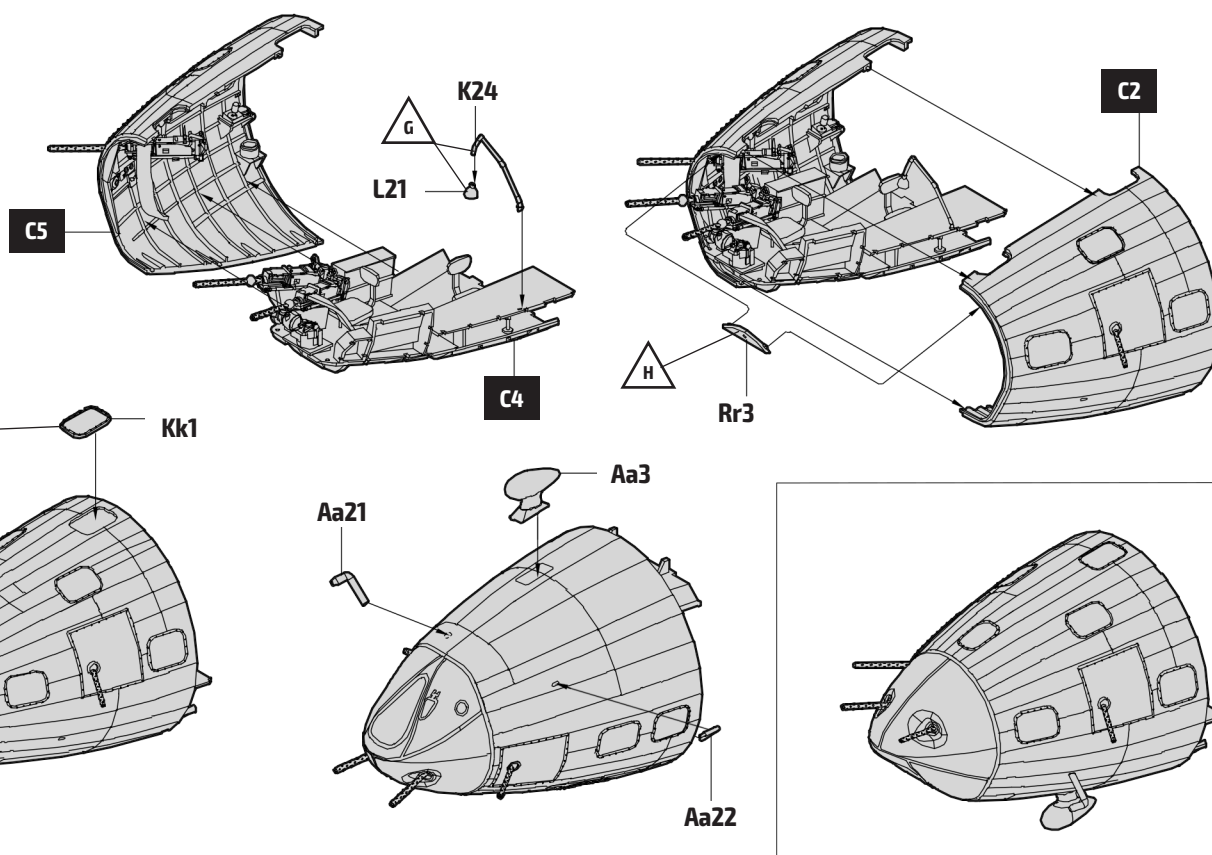
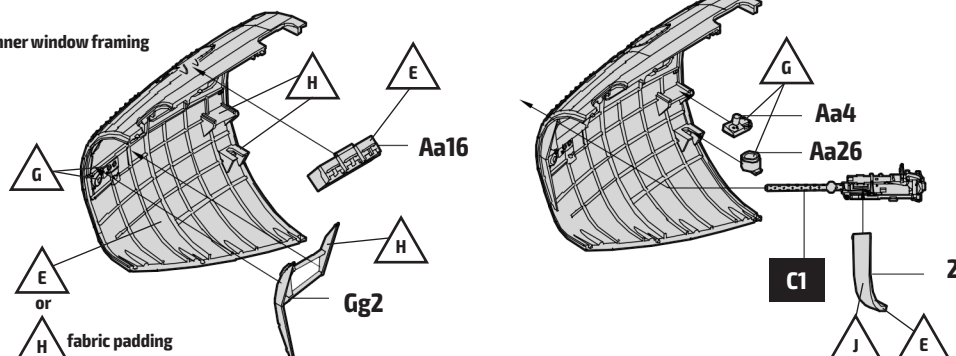
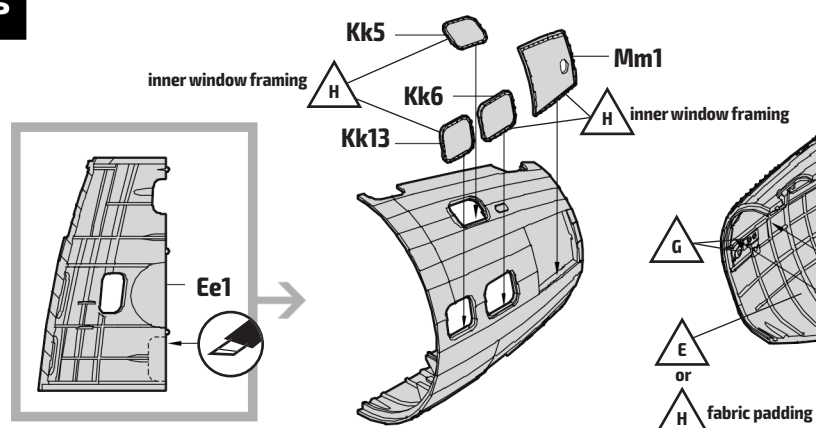
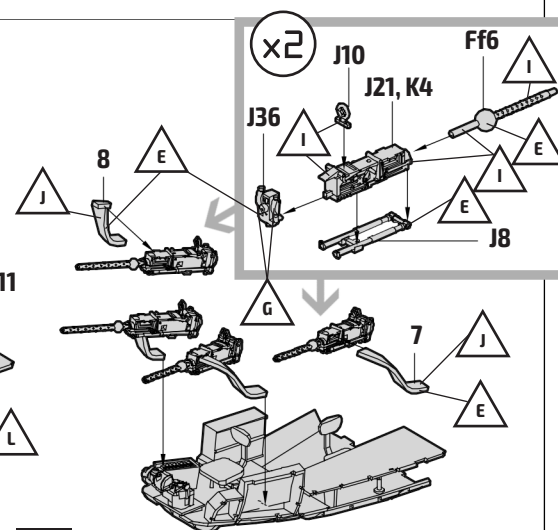
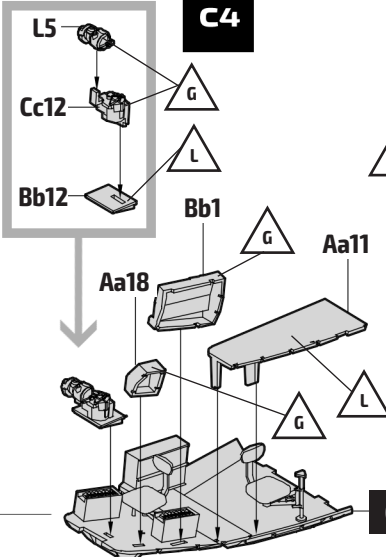
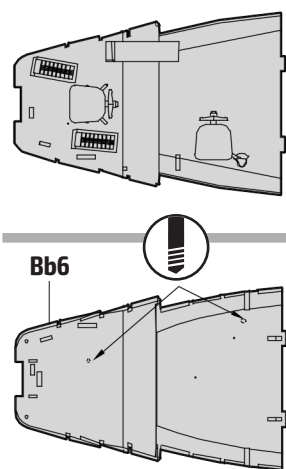
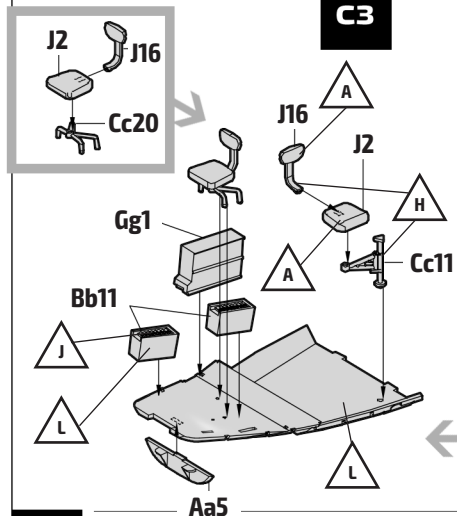
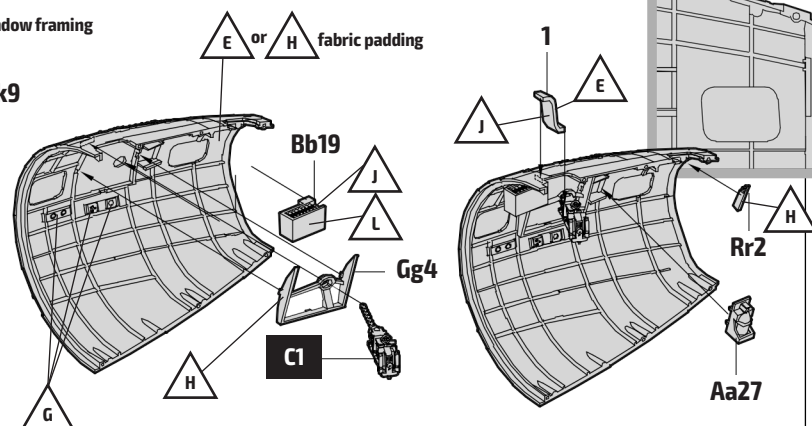
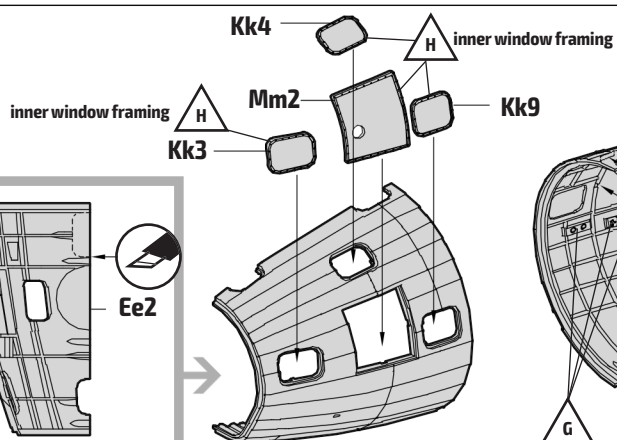





[illegible]



13

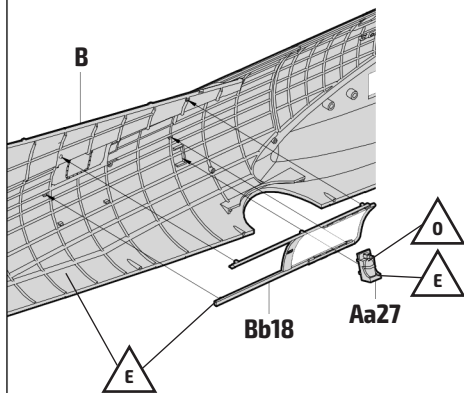

14

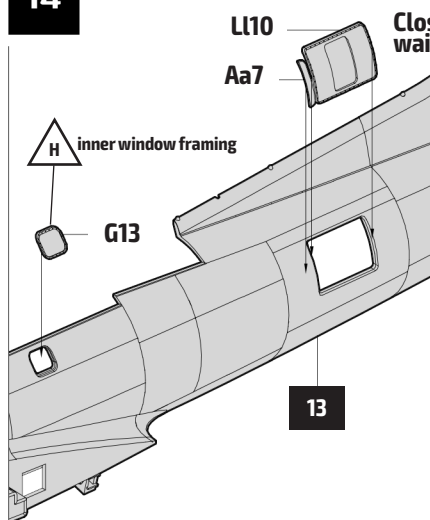

Closed portside waist window



Open portside waist window

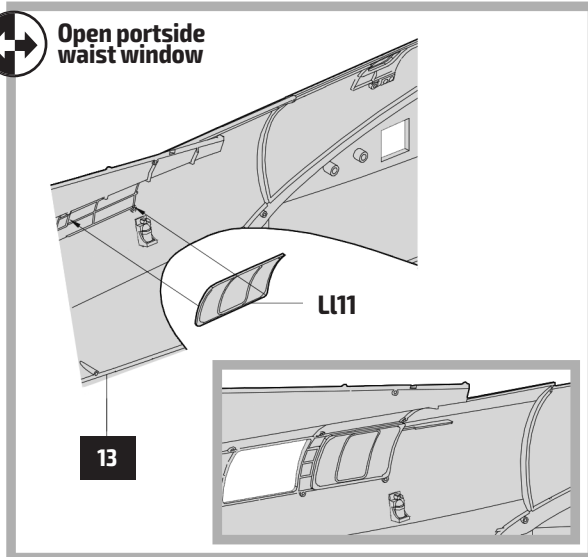

15

(x2)

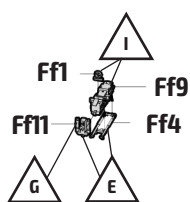

16

(x2)

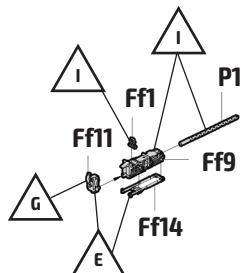

17-1

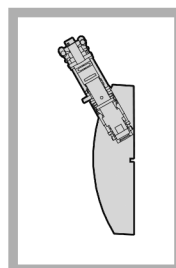
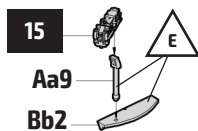
Portside waist gun in firing position  
(use in conjunction with open waist window)

17-2

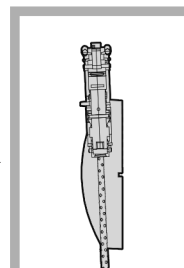
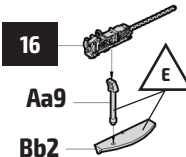
Portside waist gun in stowed position  
(use in conjunction with closed waist window)

18

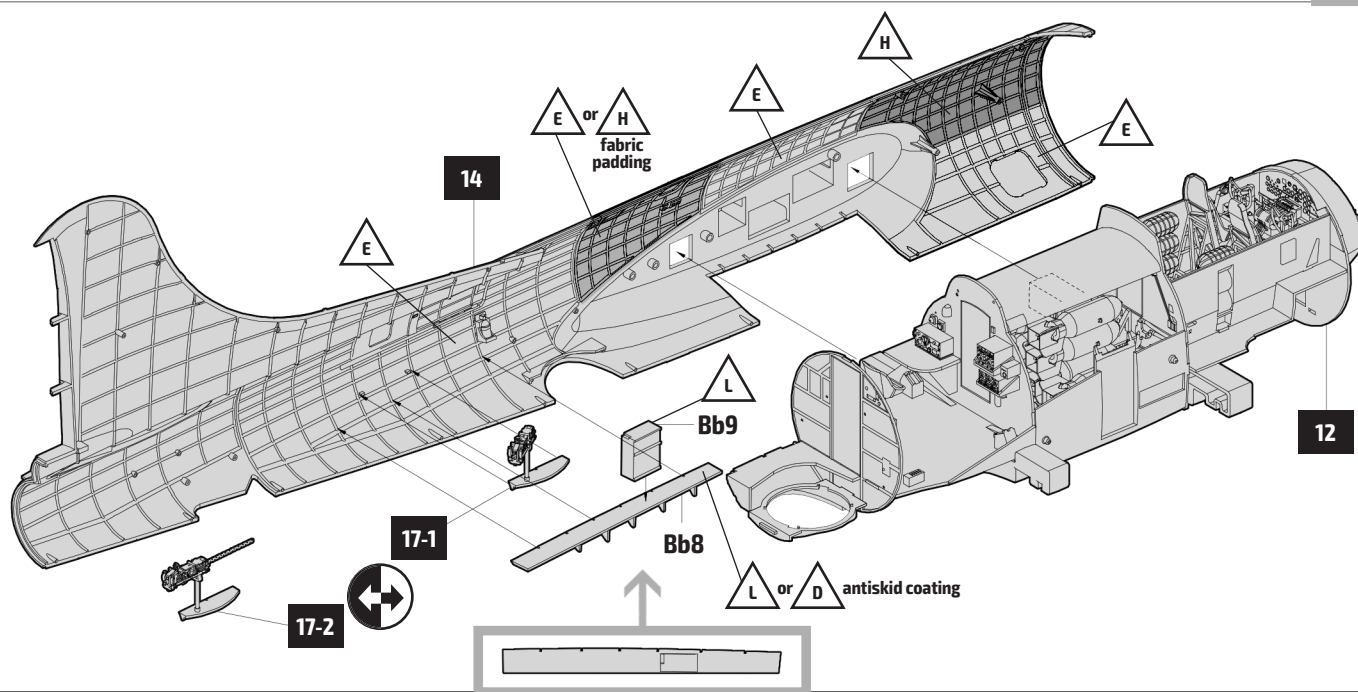

19

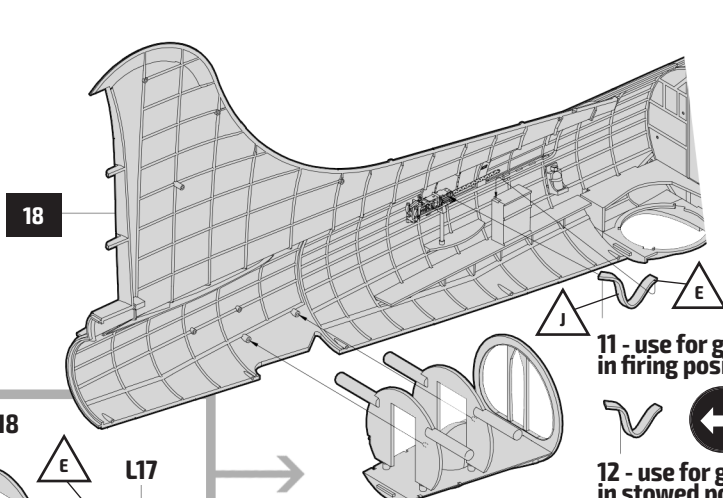
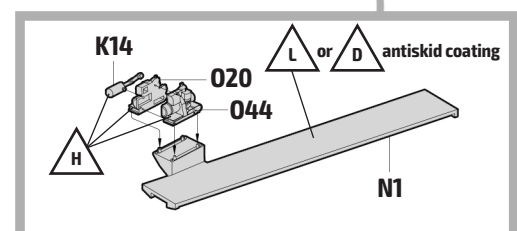
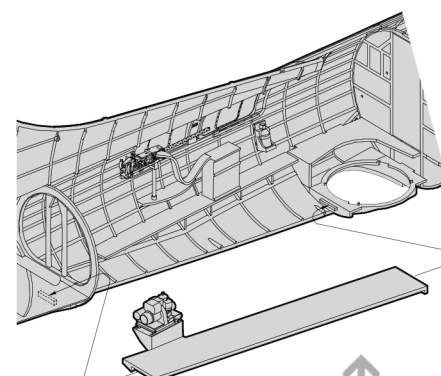
11 - use for gun installed  
in firing position12 - use for gun installed  
in stowed position

20

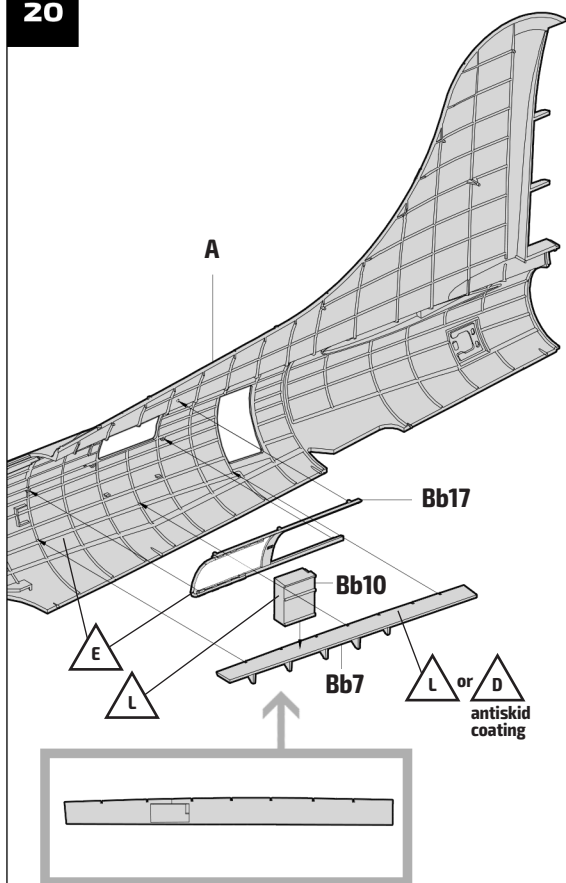

21-1

Starboard waist gun in firing position  
(use in conjunction with open starboard  
waist window)

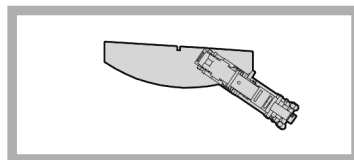
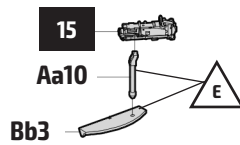

21-2

Starboard waist gun in stowed position  
(use in conjunction with closed  
starboard waist window)

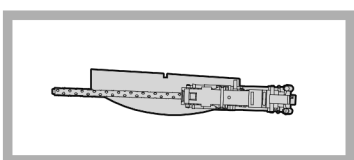
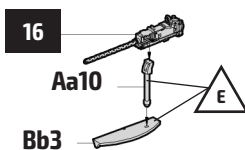

22

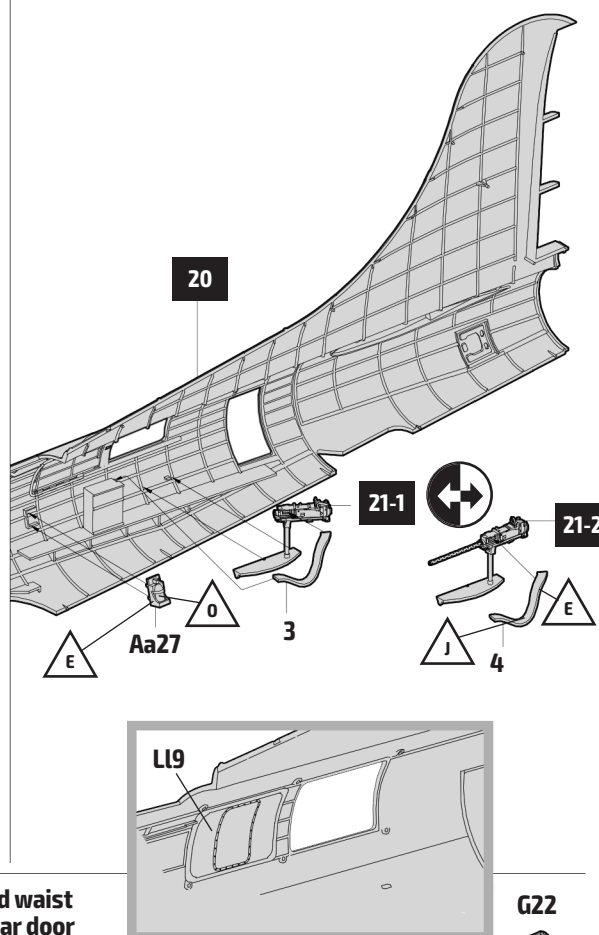

23-1

Closed starboard waist window and rear door

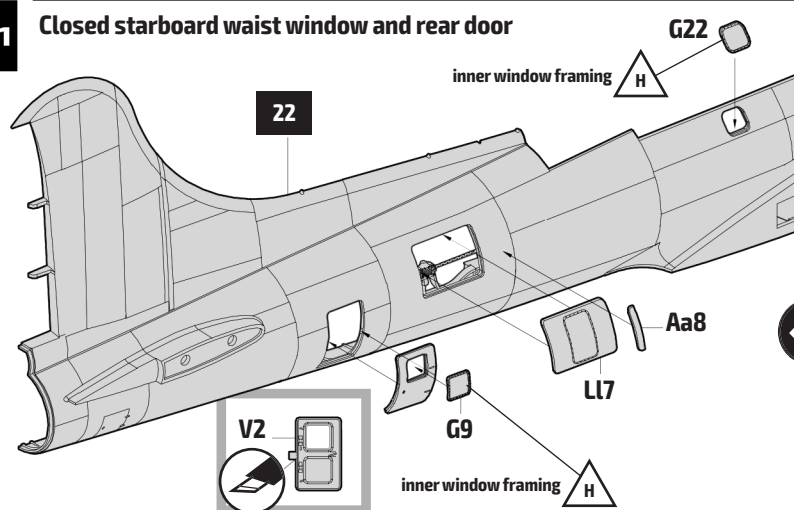

23-2

Open starboard waist  
window and rear door

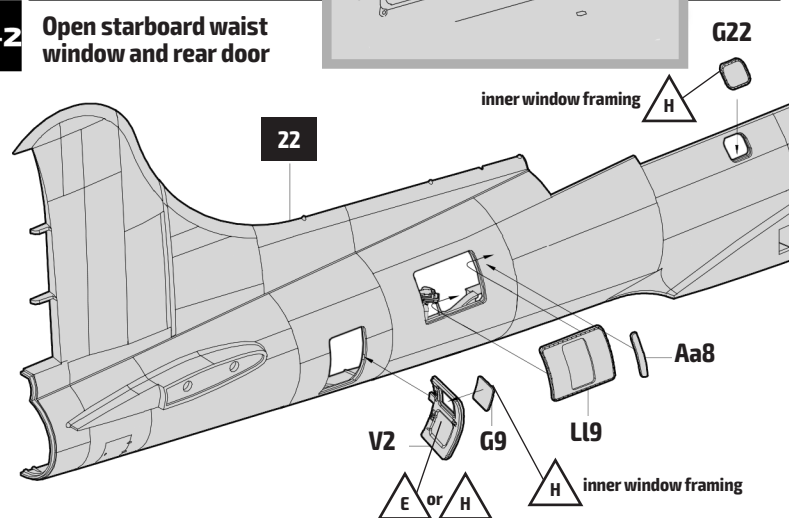

24

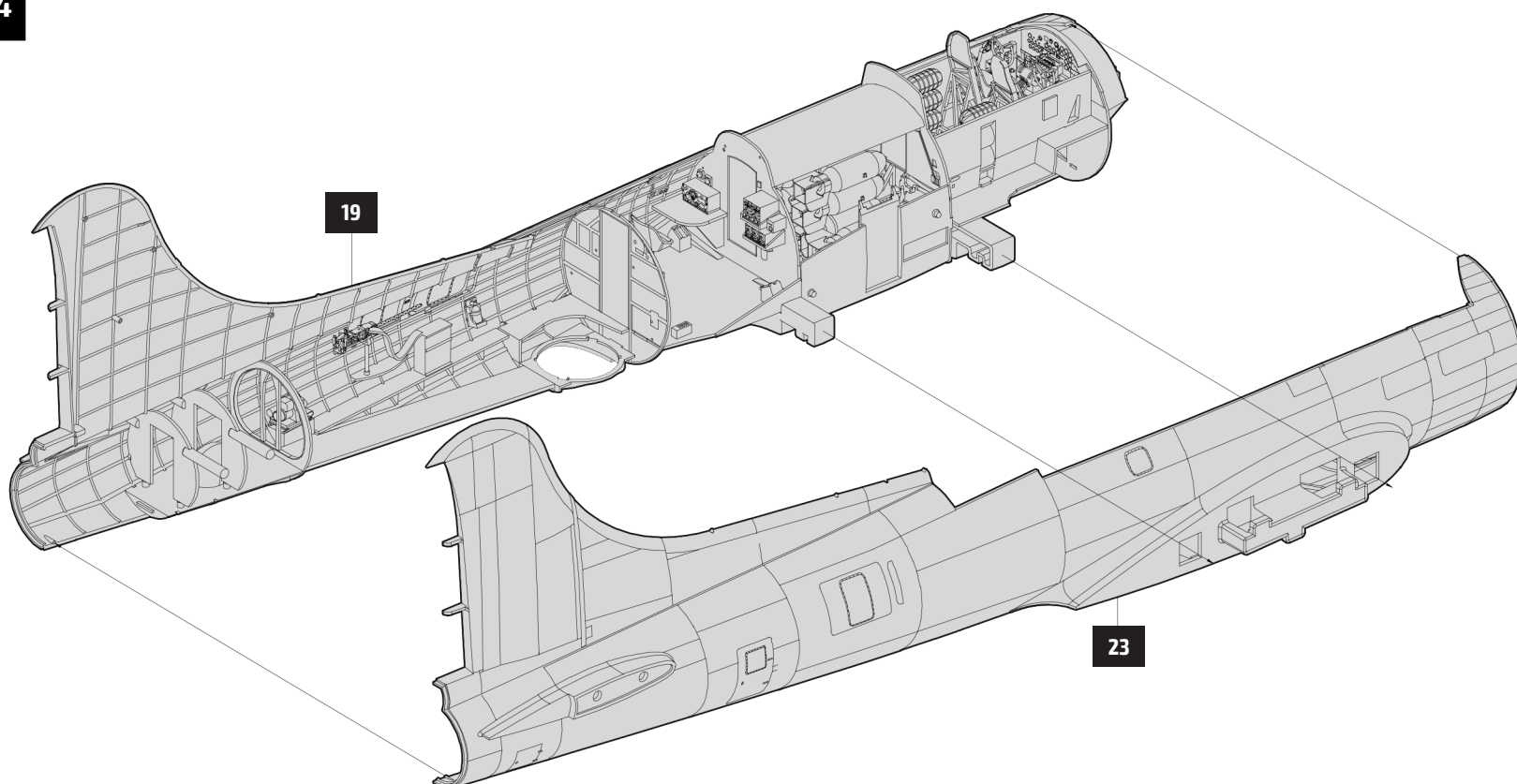



25

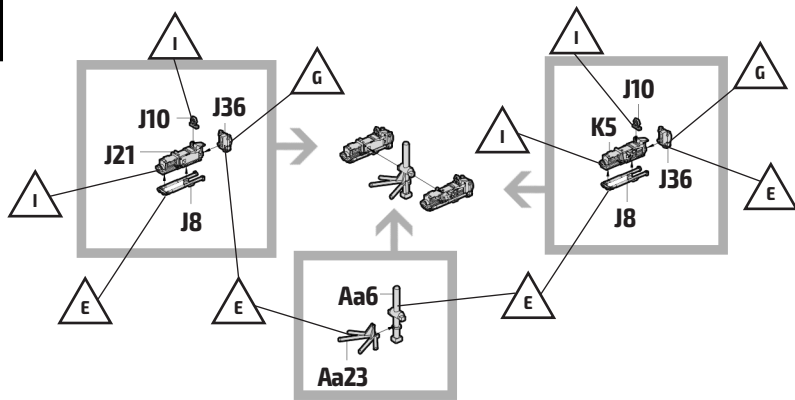

26

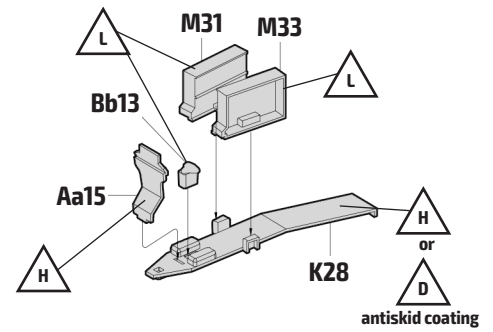

27

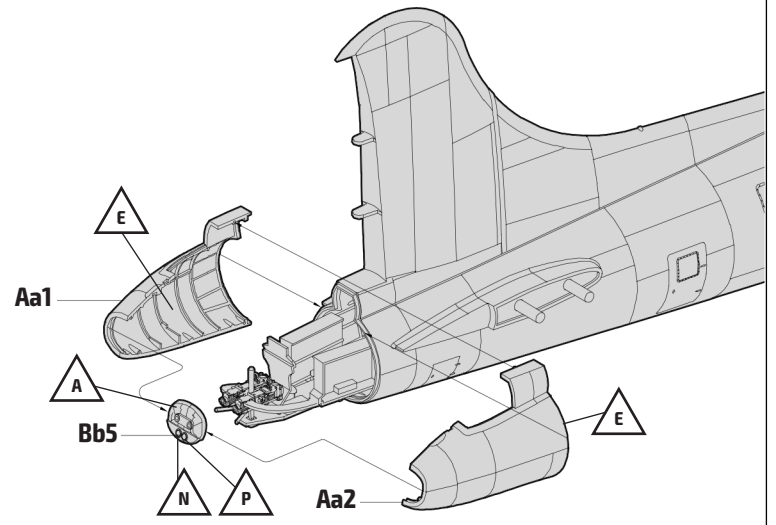
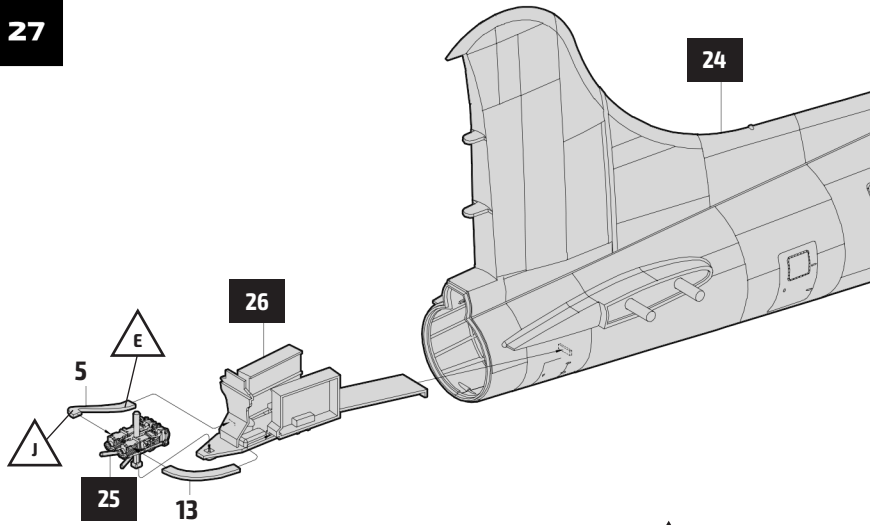

28

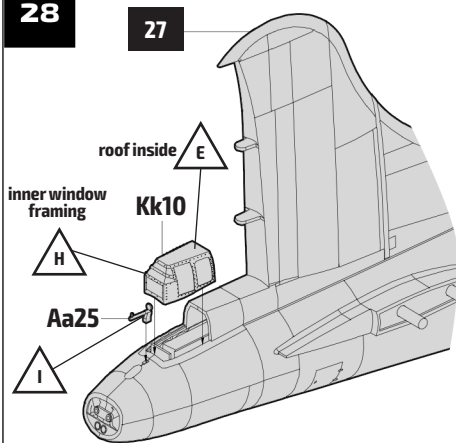

29-1

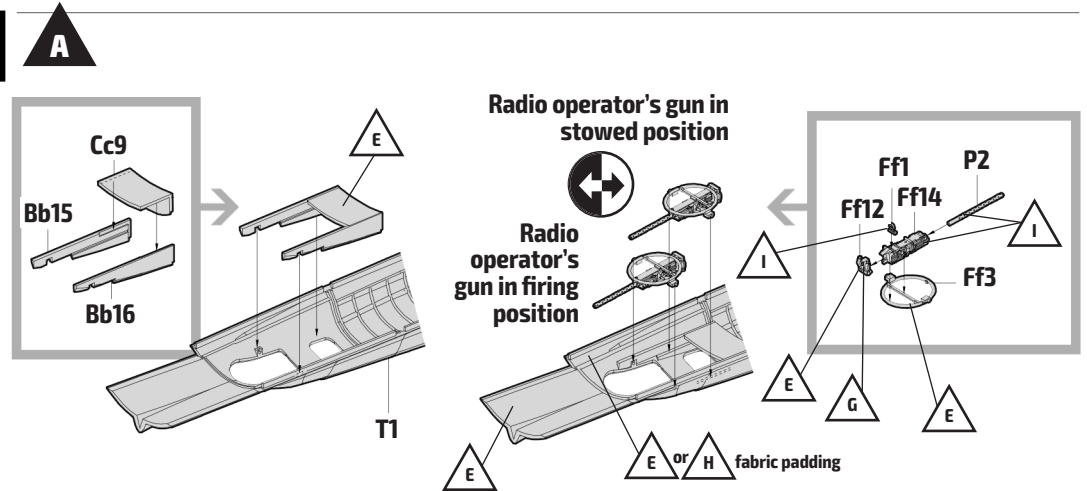

29-2

B C

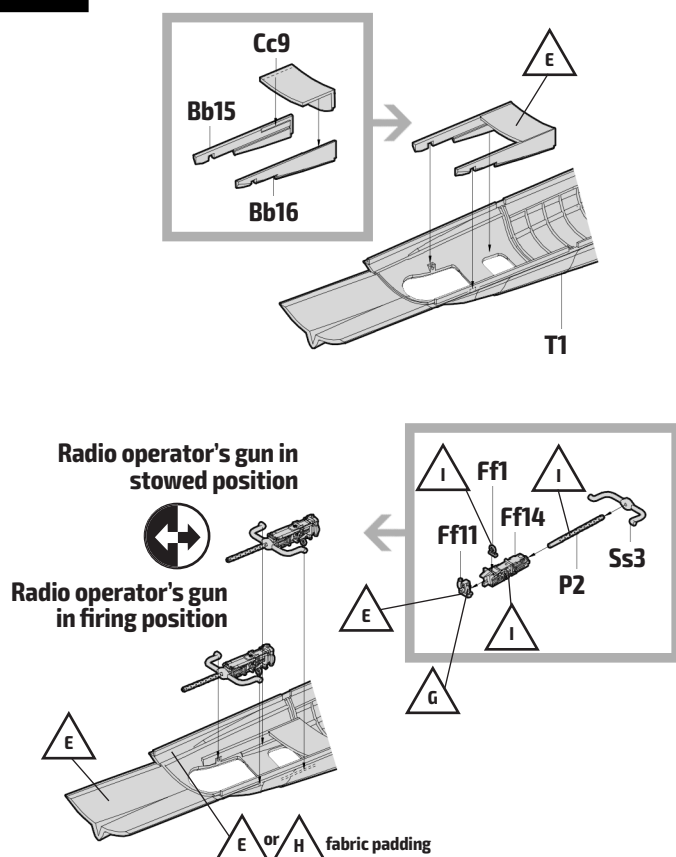

30

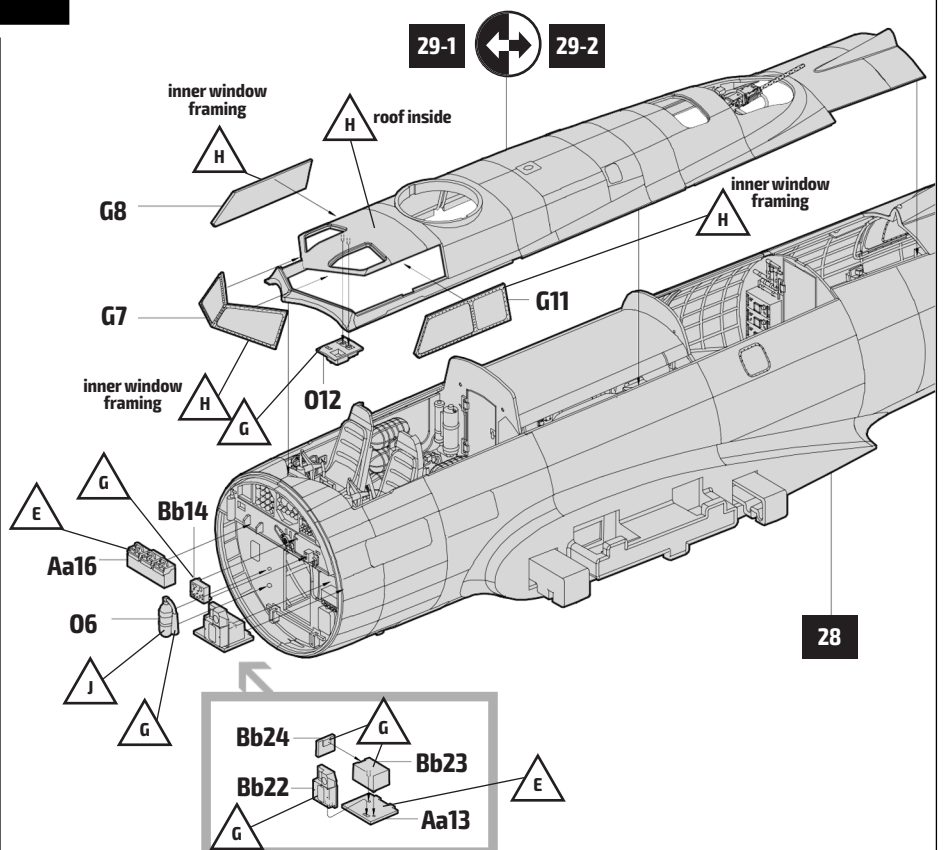

31

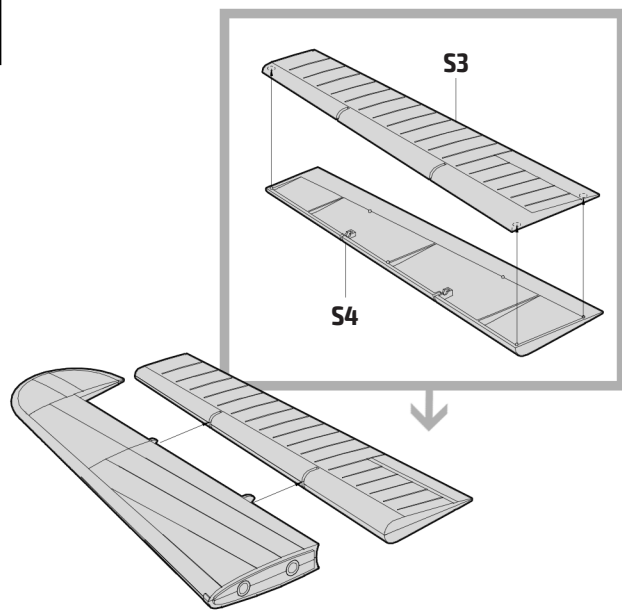

32

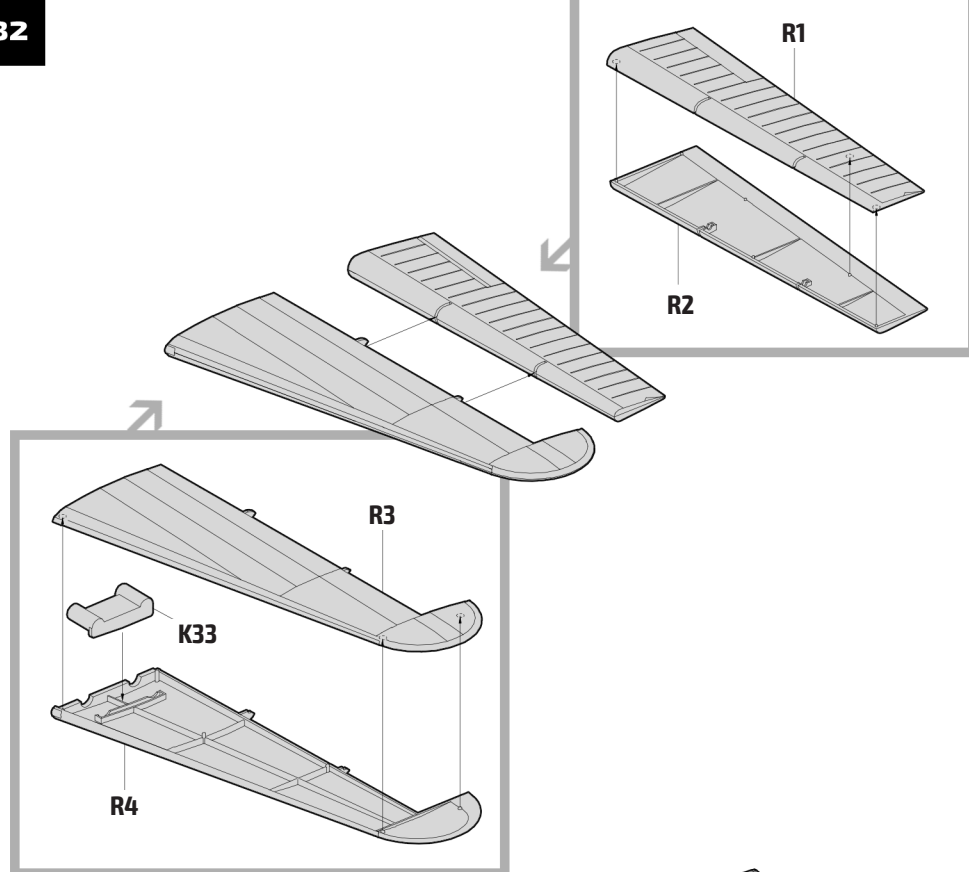

33

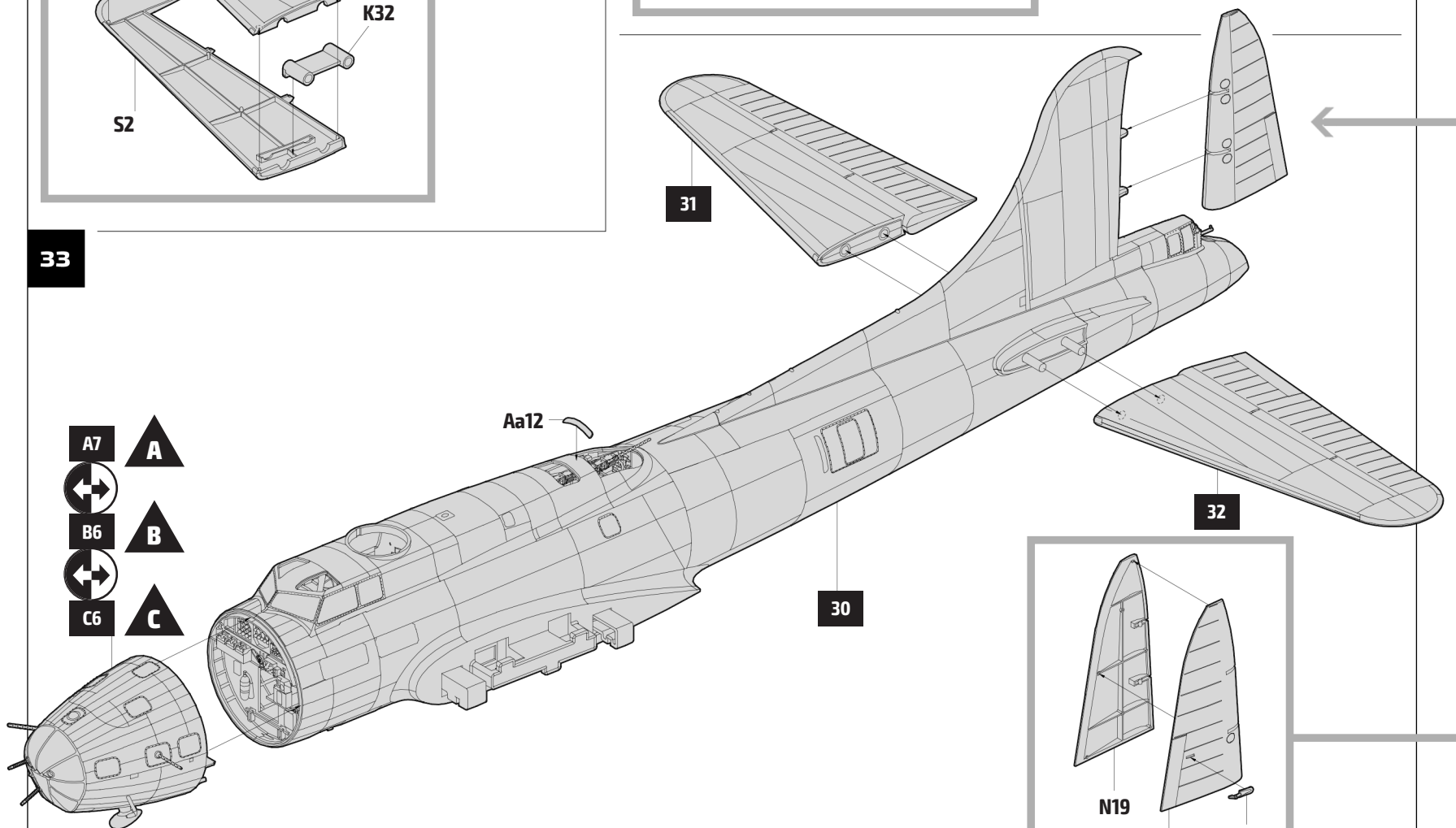

34

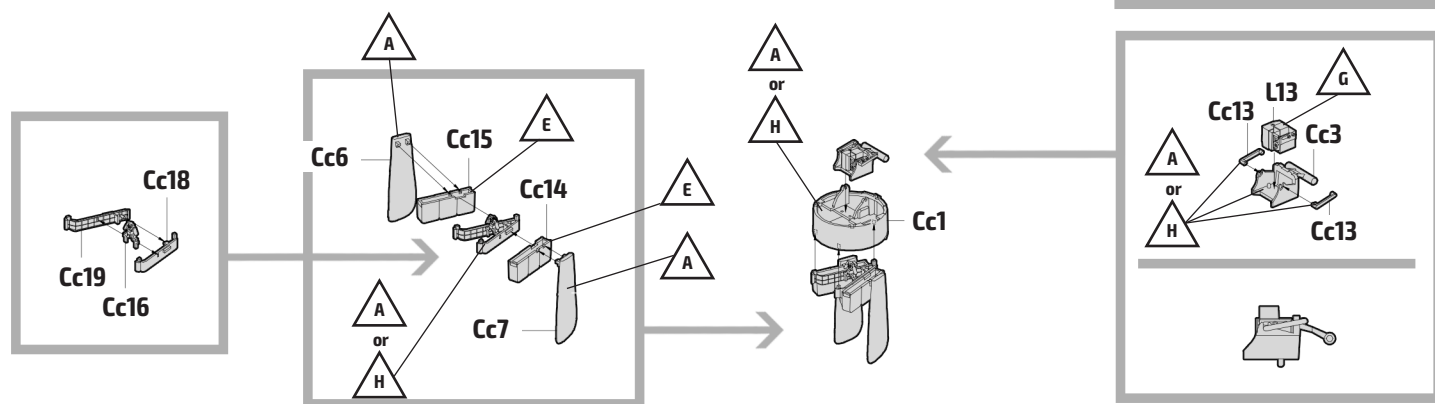



35-1

A B

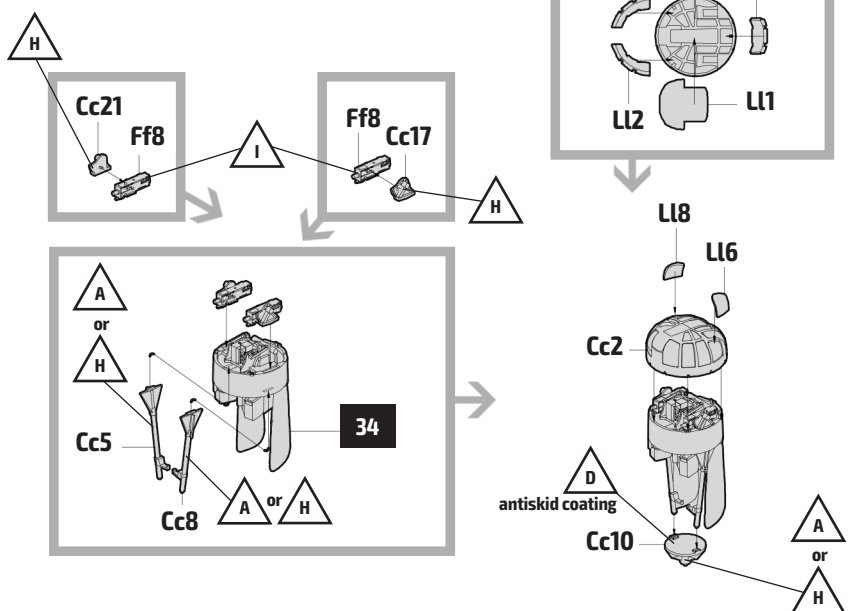

35-2

C

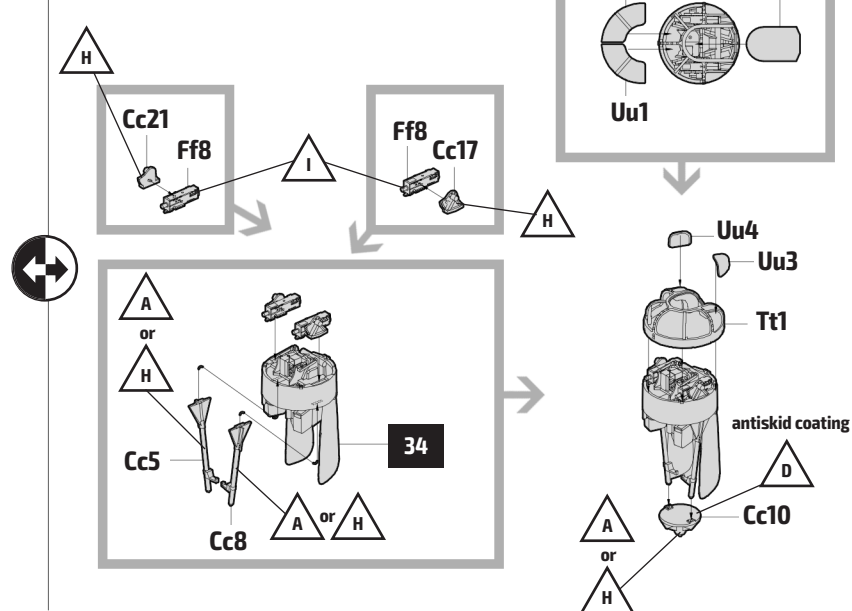

36

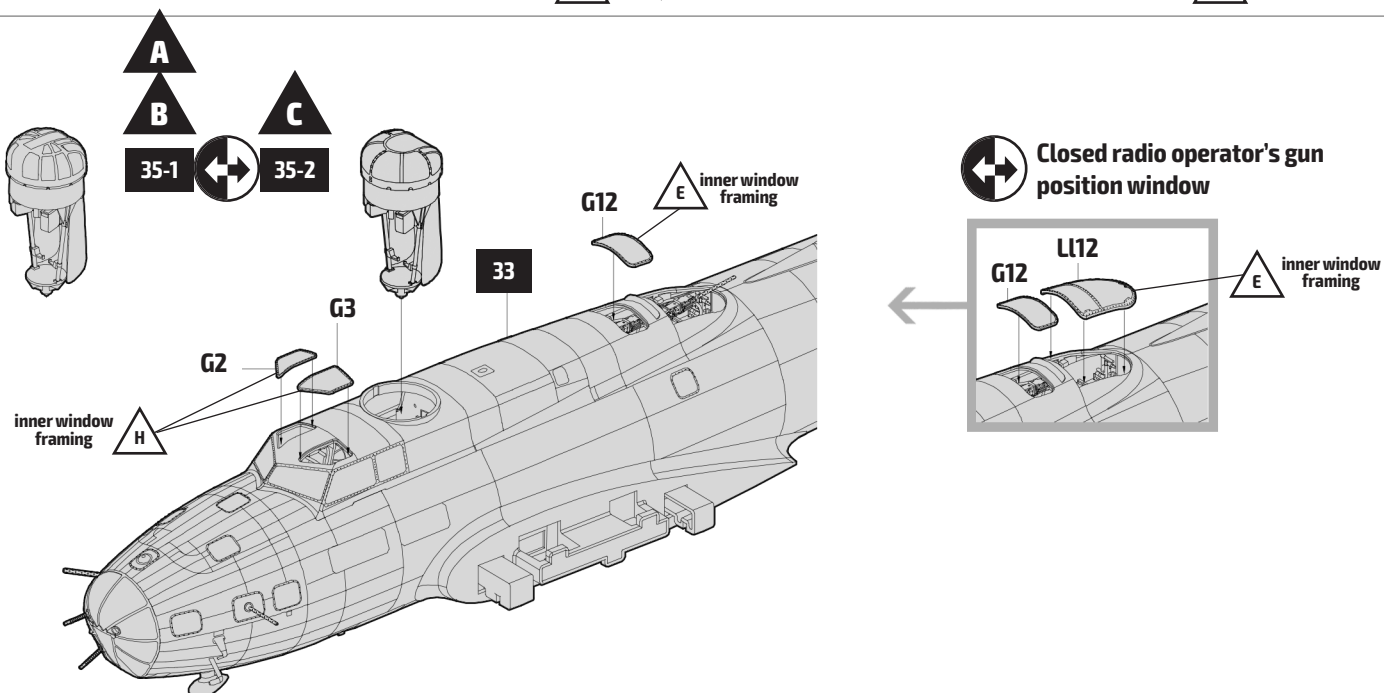

37

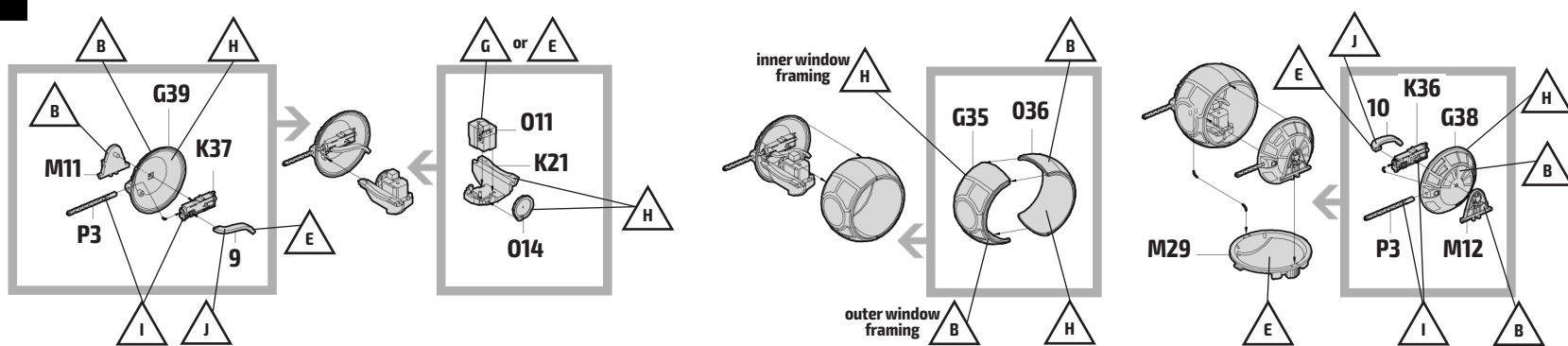

38

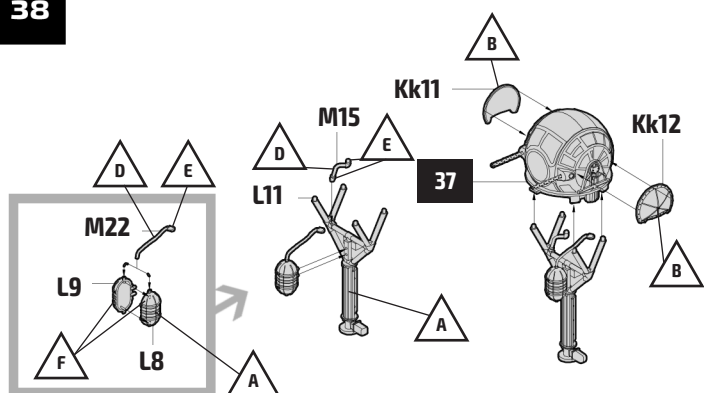

39-1 Tailwheel in extended position

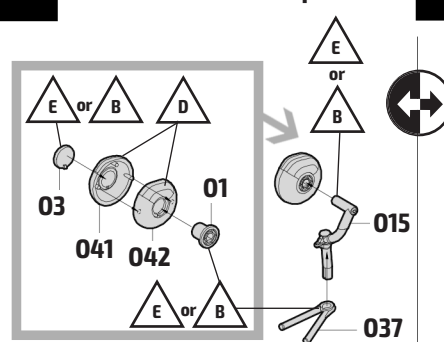

39-2 Tailwheel in retracted position

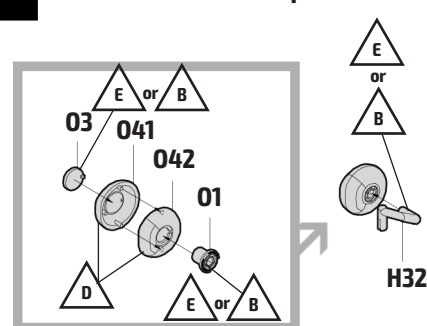

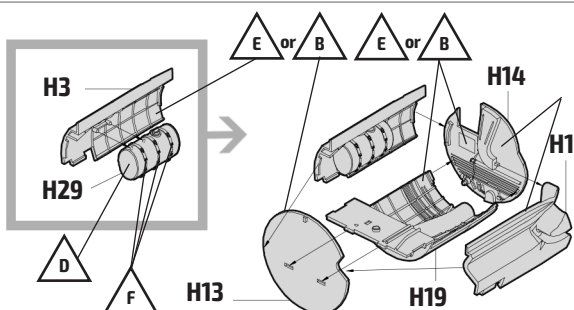
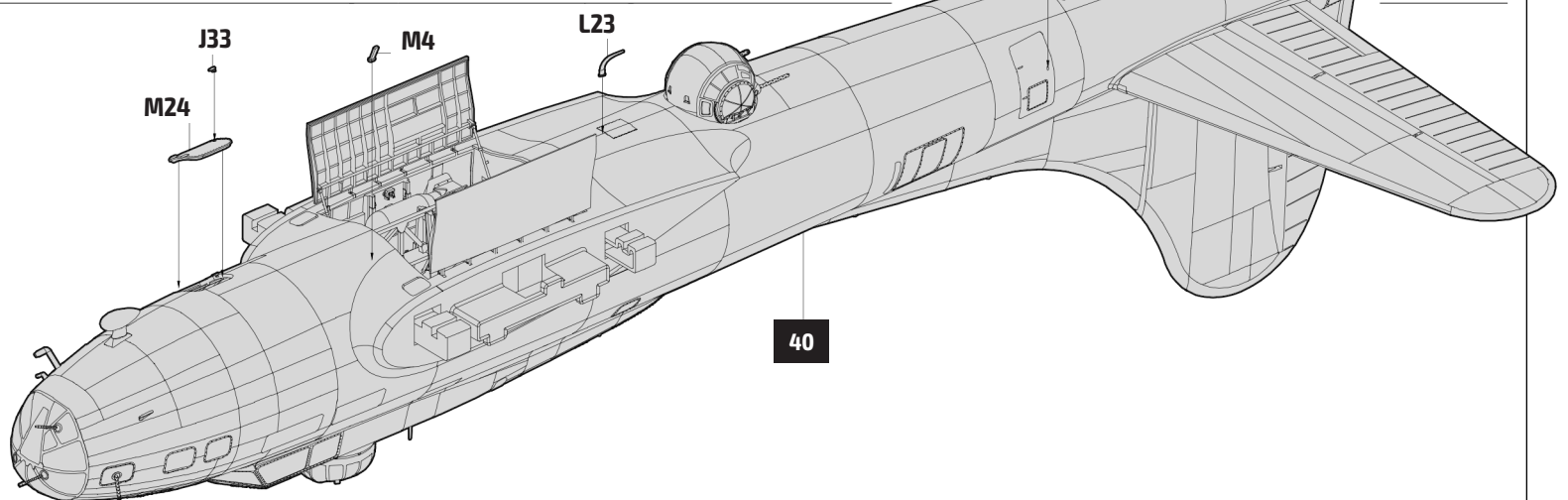
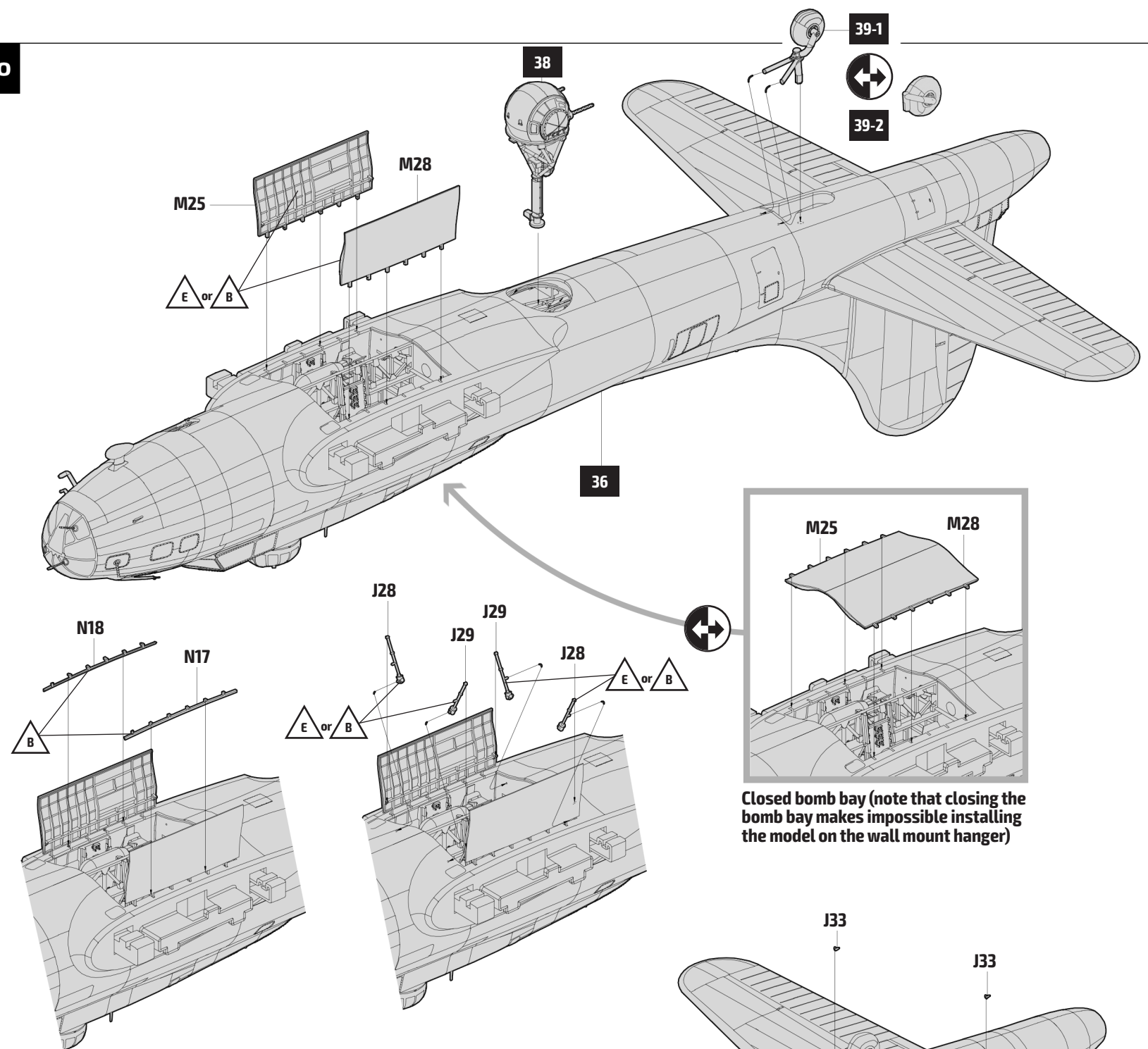
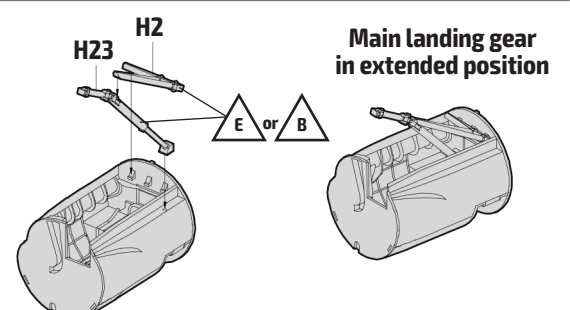
Main landing gear  
in retracted positionMain landing gear  
in extended position





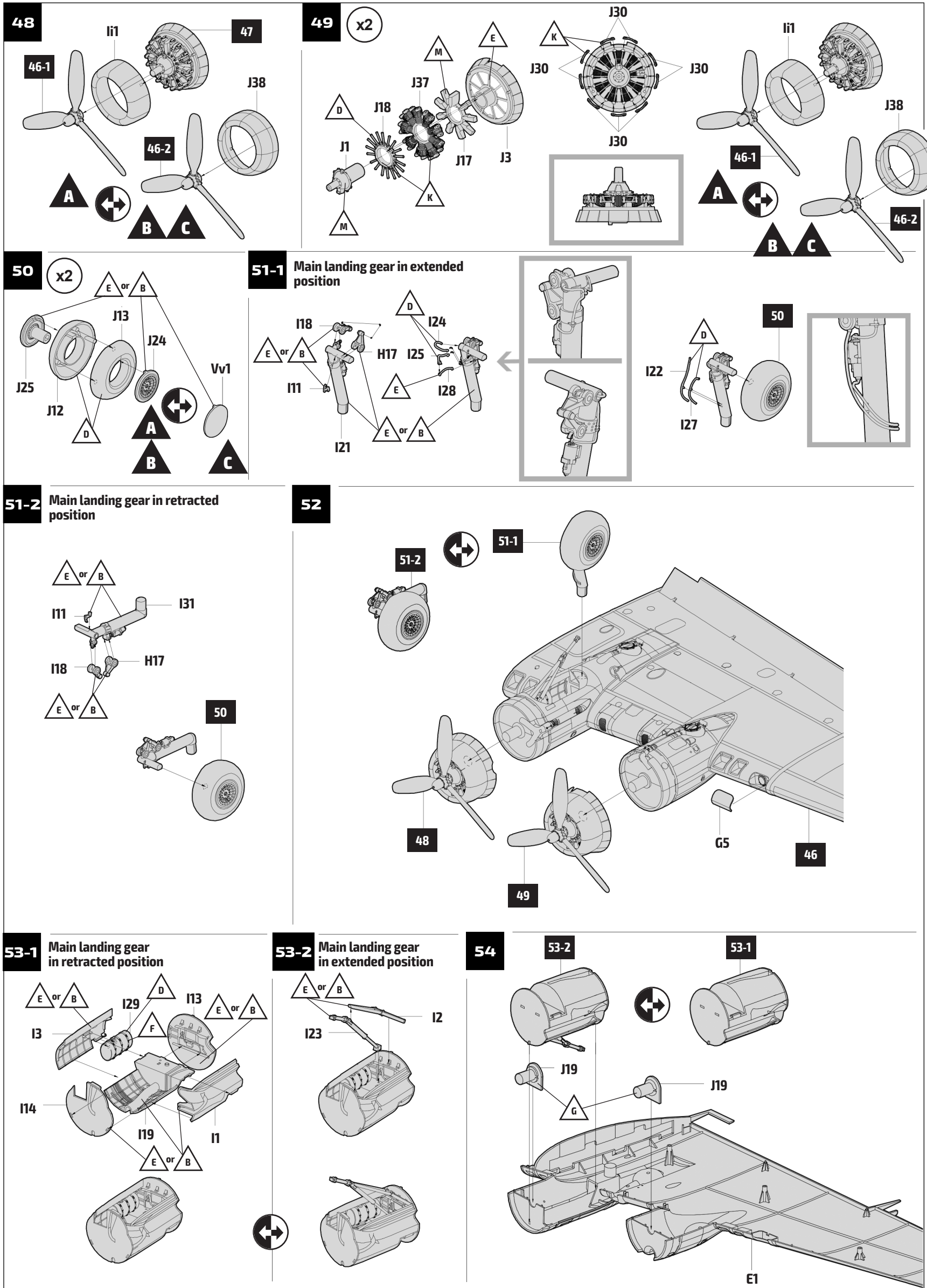



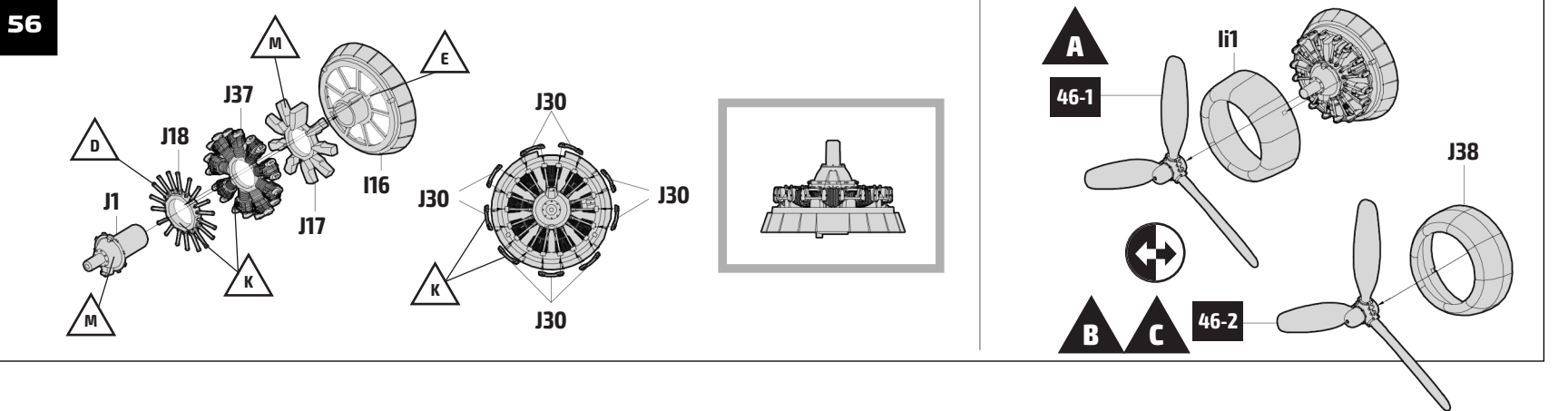
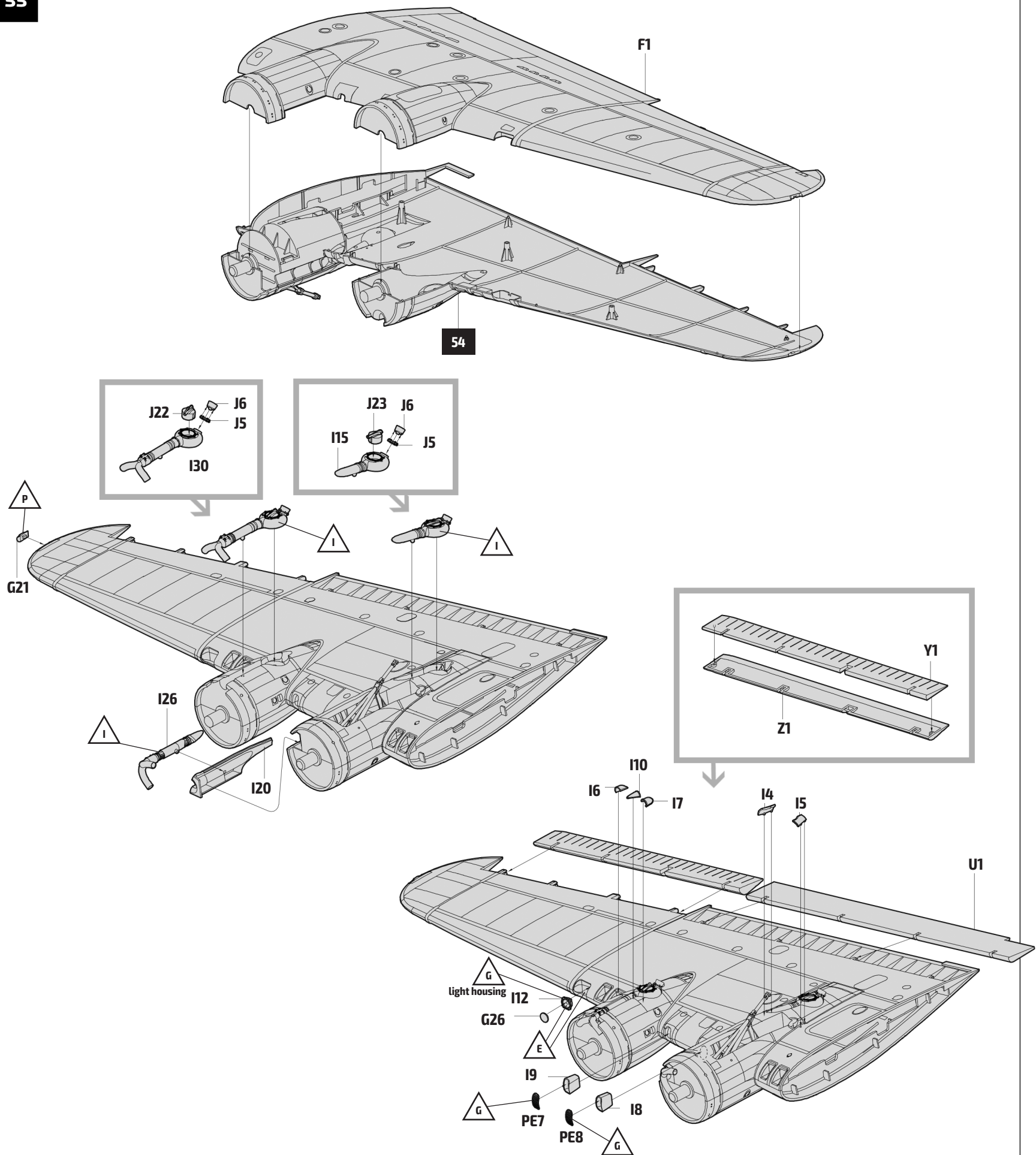

# 57-1 Main landing gear in extended position

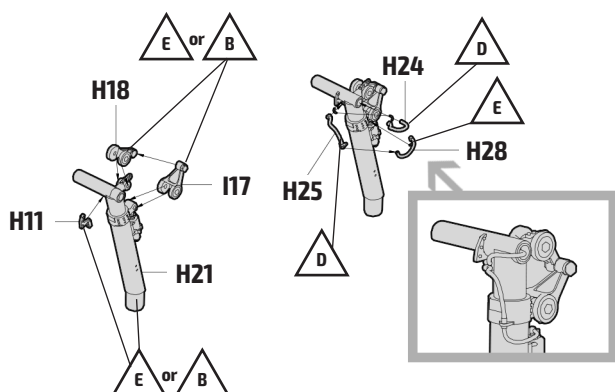

# 57-2 Main landing gear in retracted position

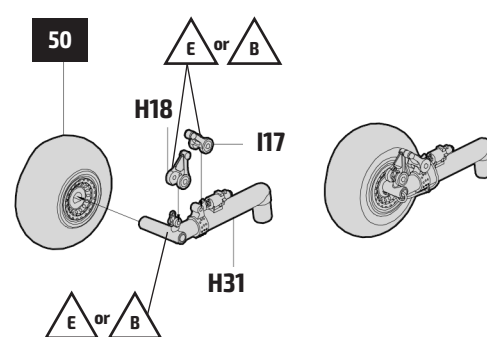

# 58

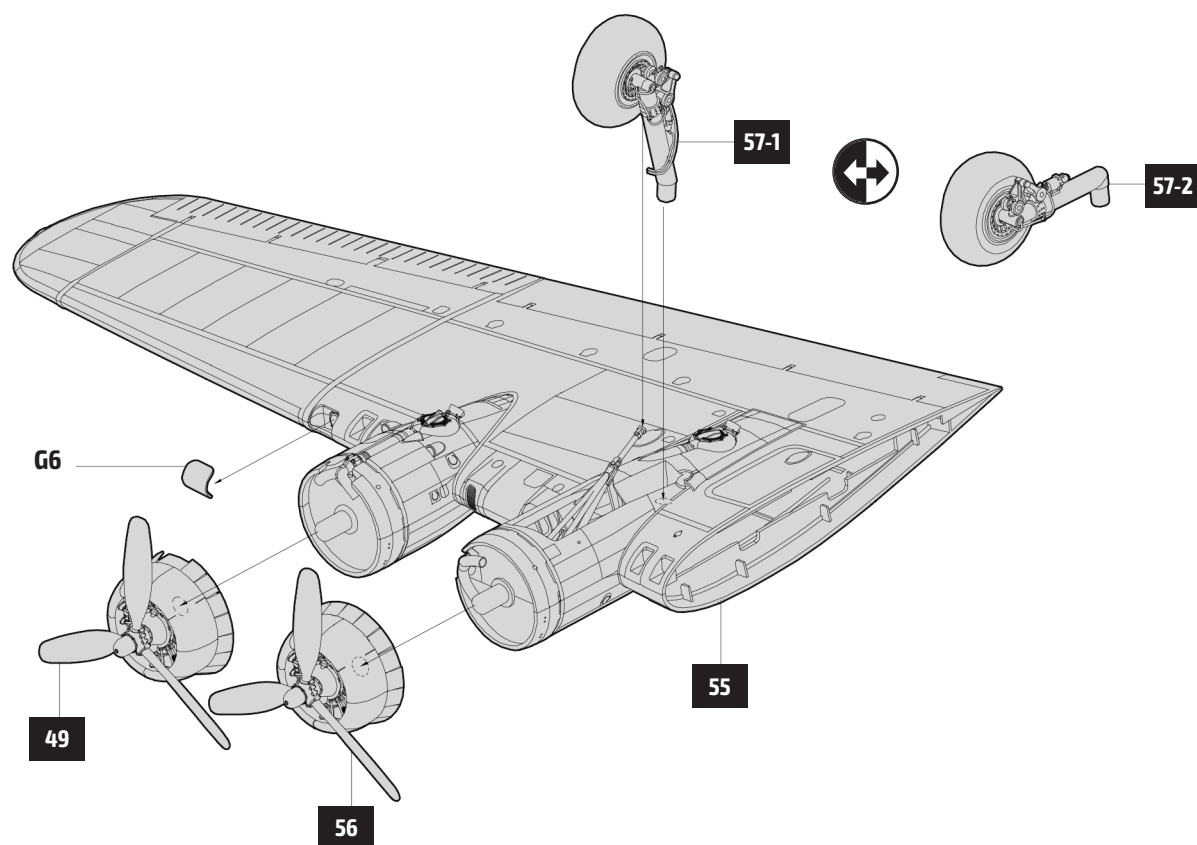

# 59

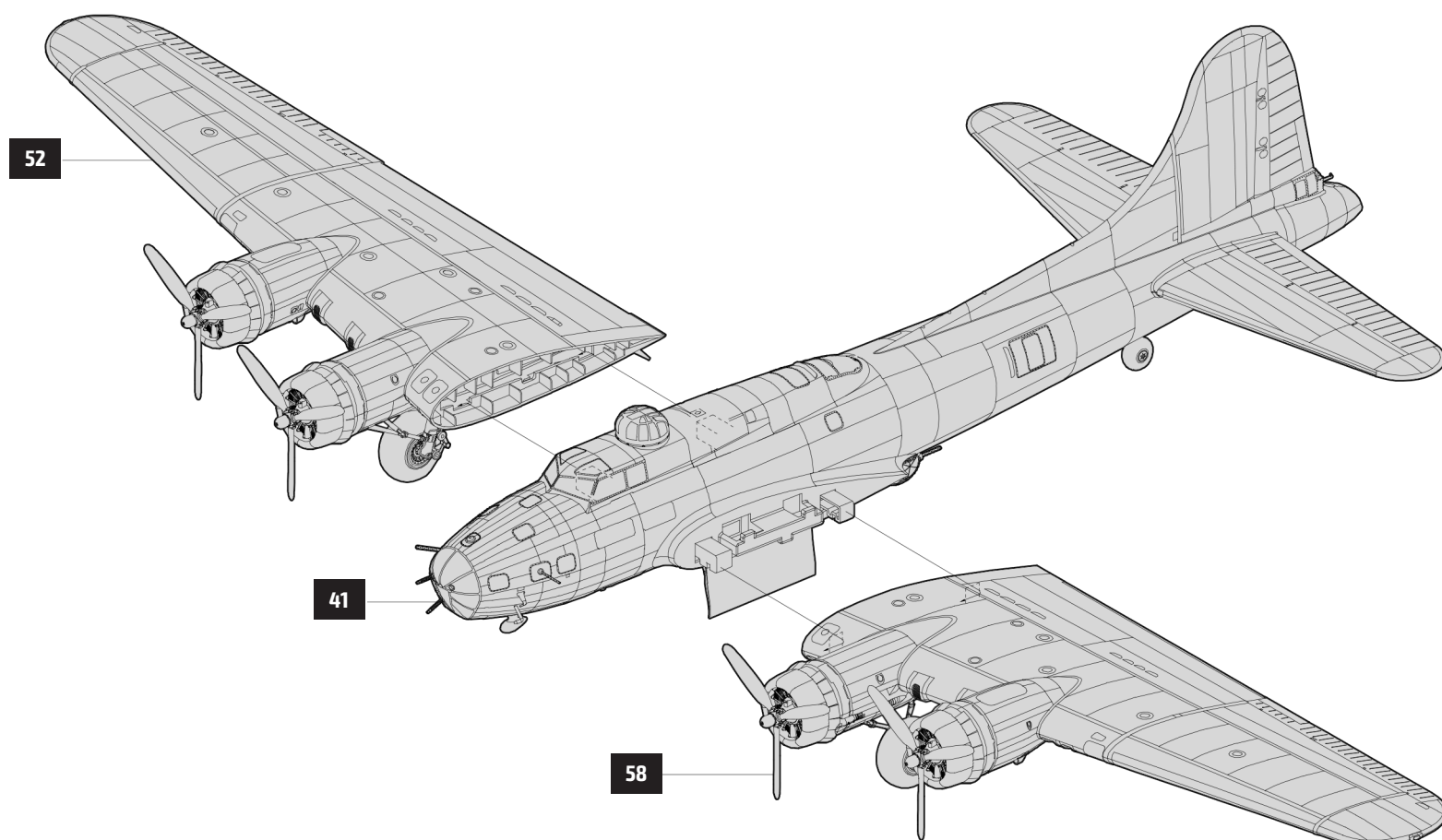





62

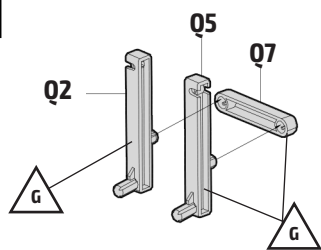

64

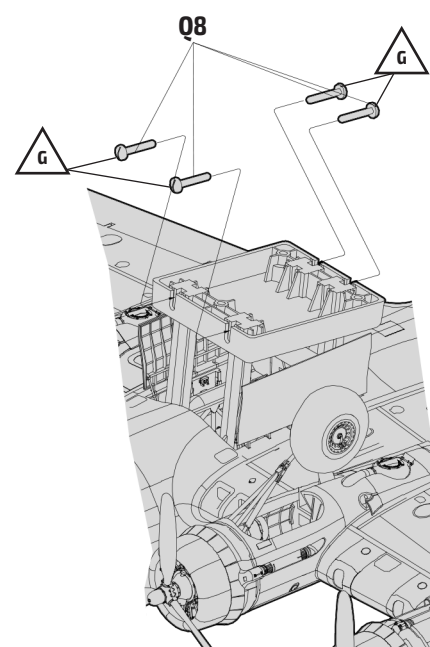
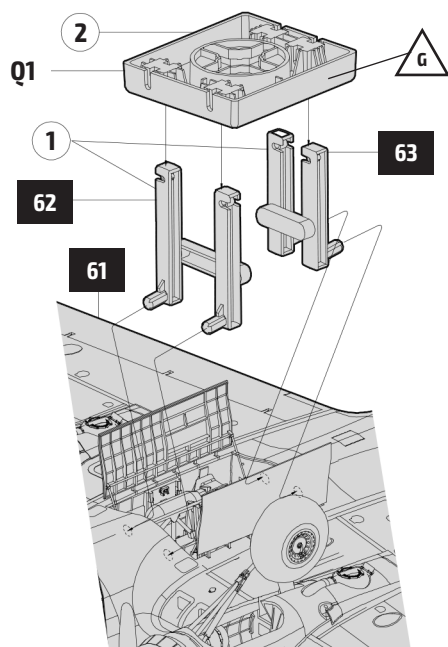

63

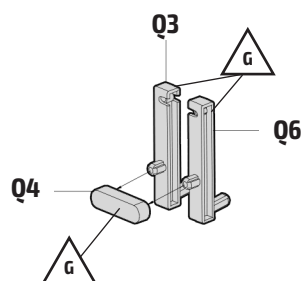

65

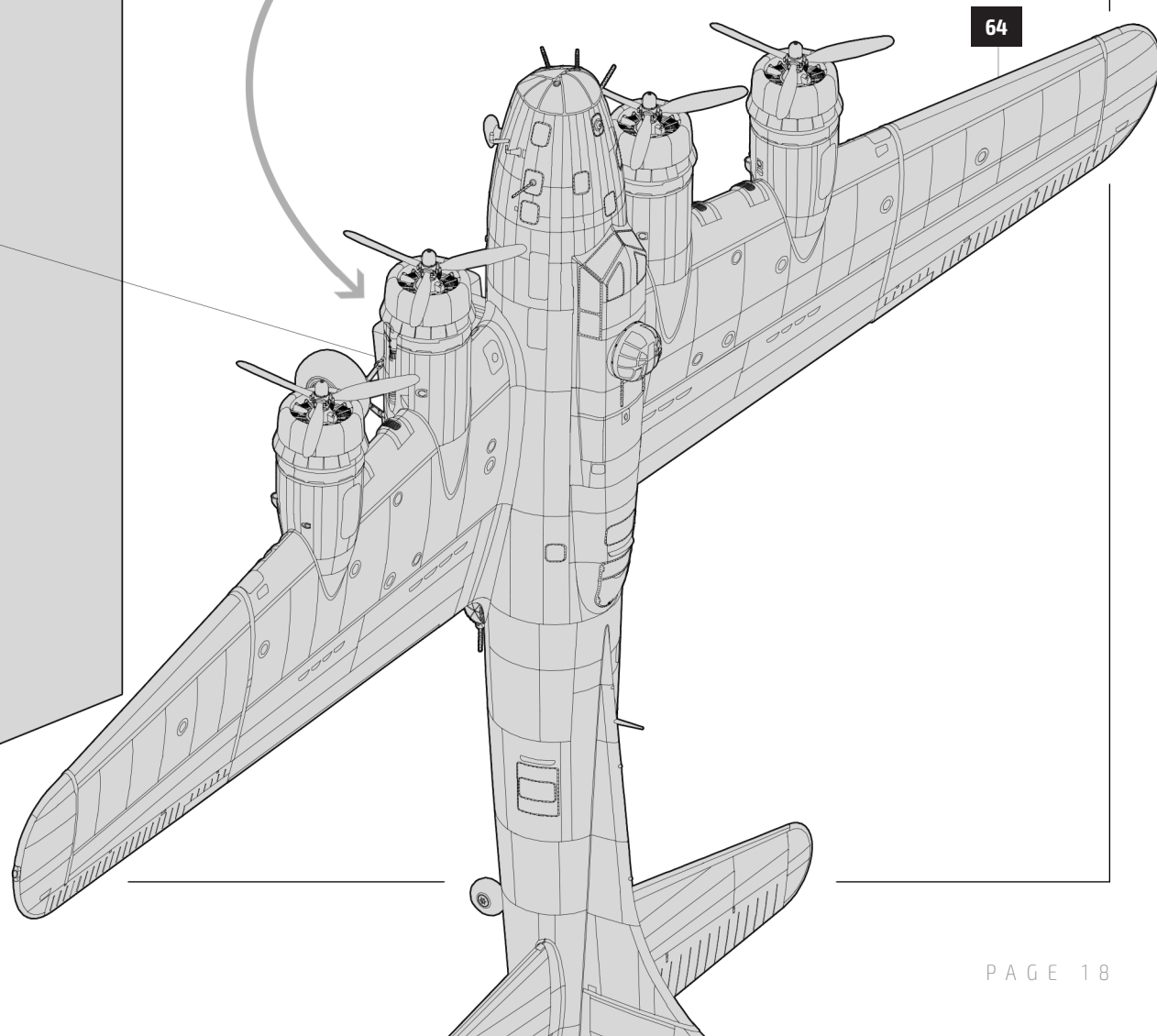
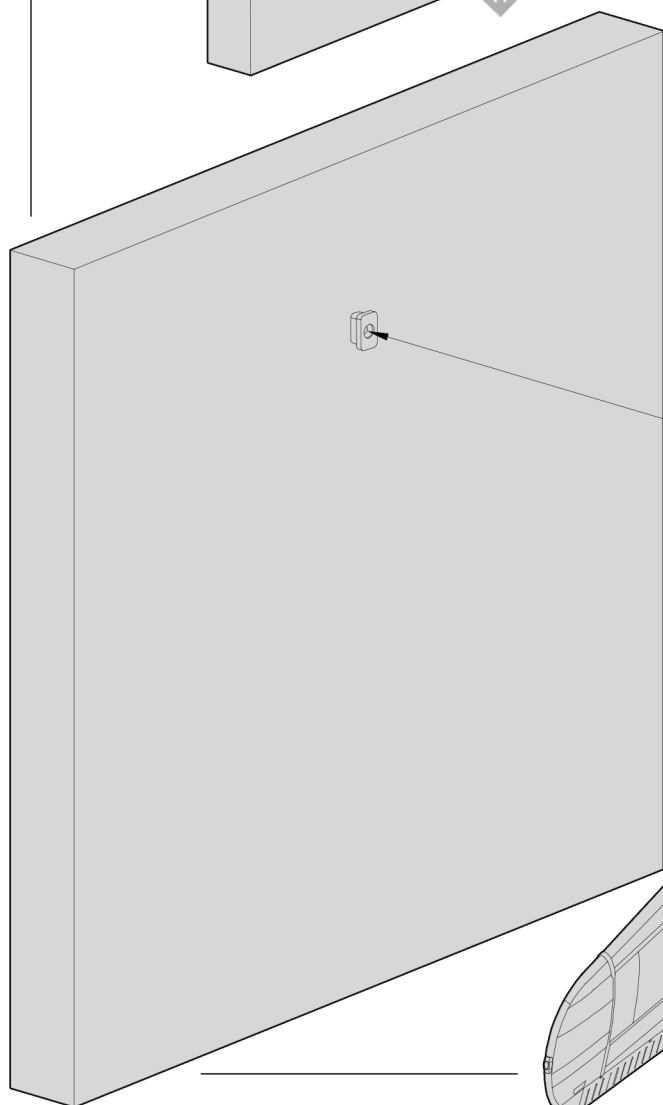
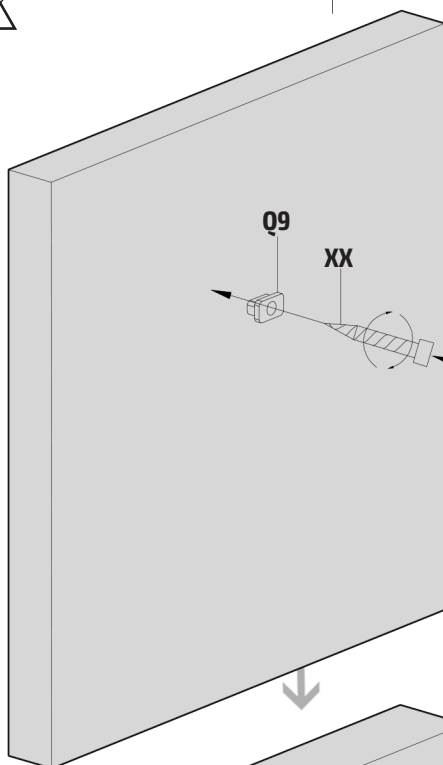



# Parts

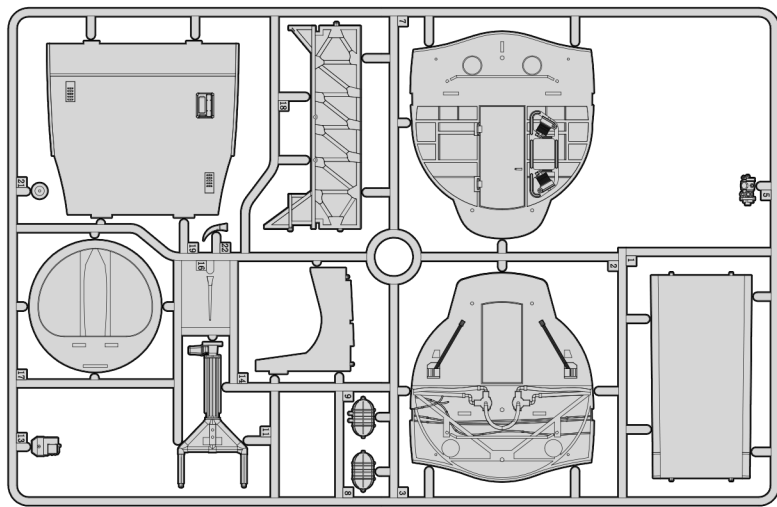

L

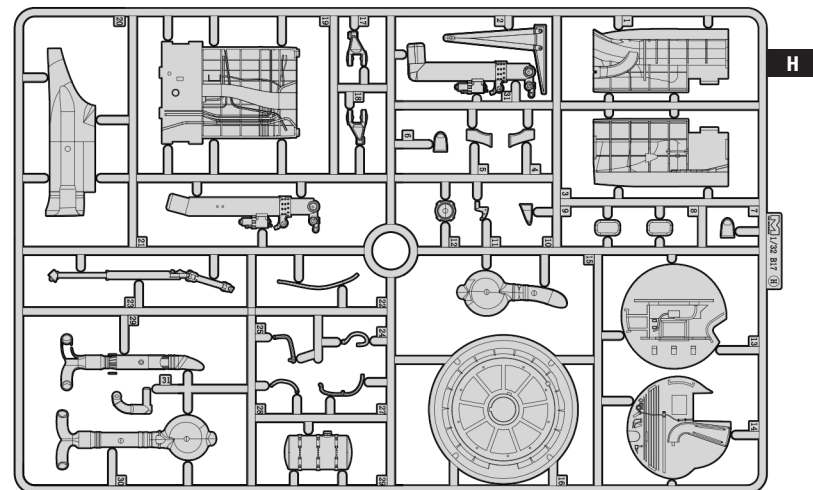
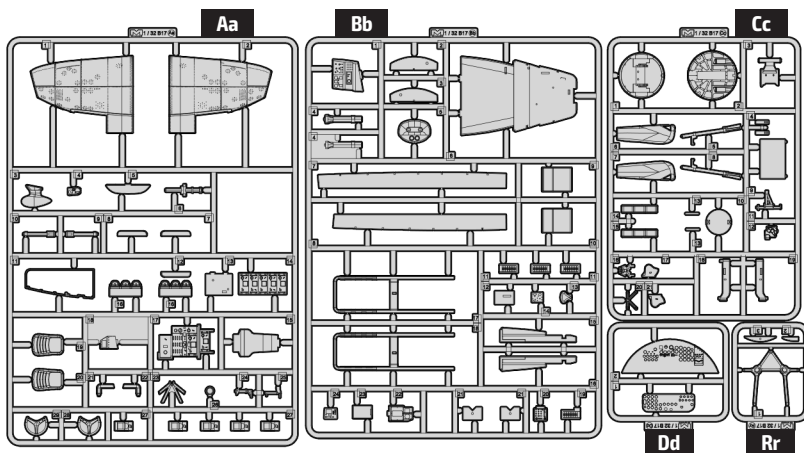
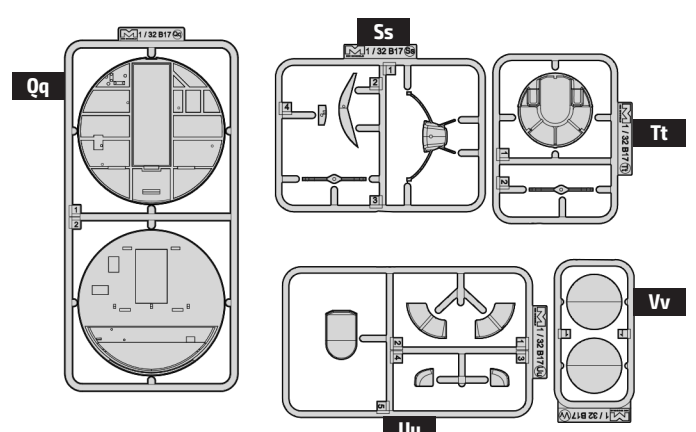
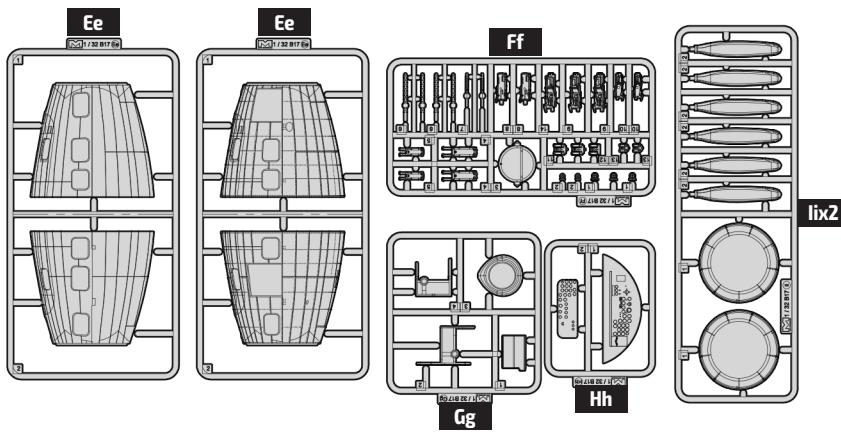
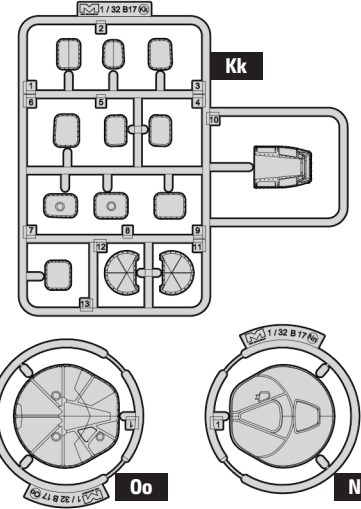
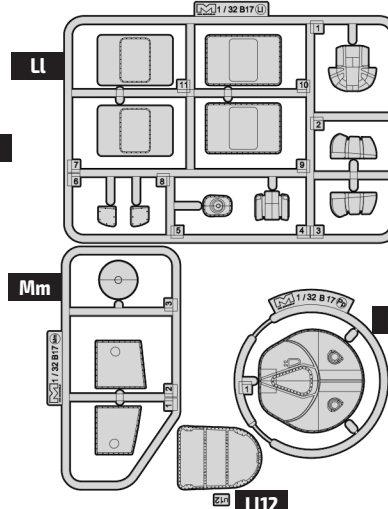

H

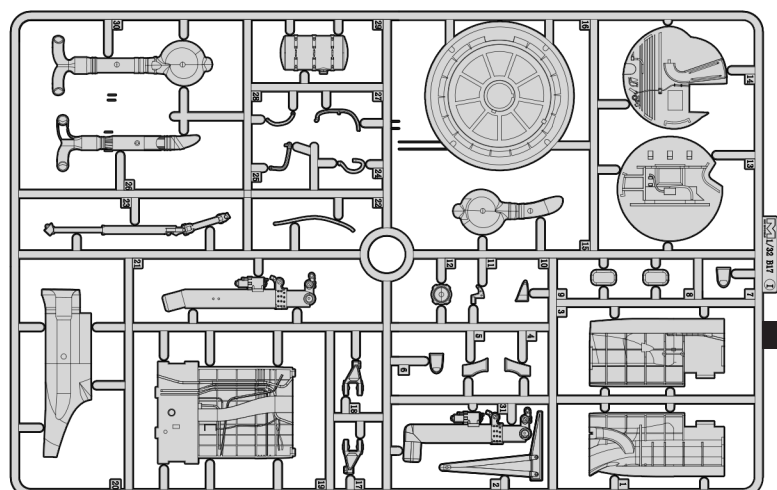

I

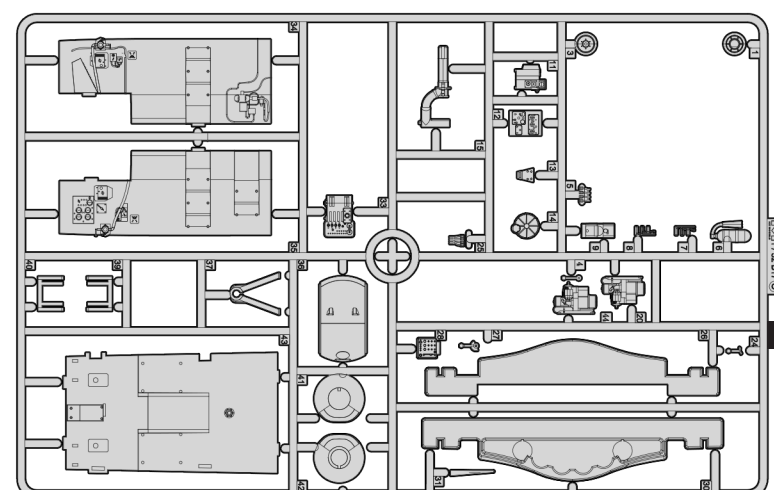

O

# Parts

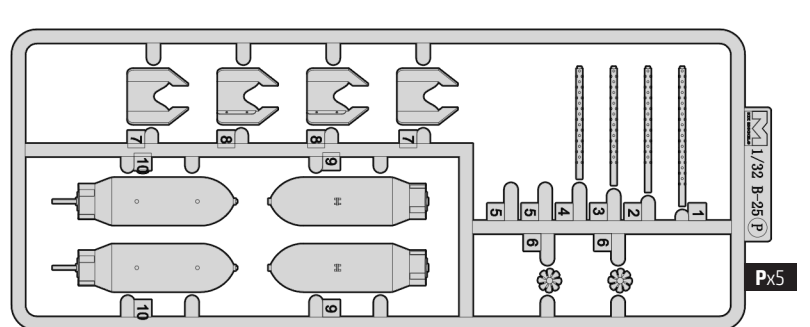
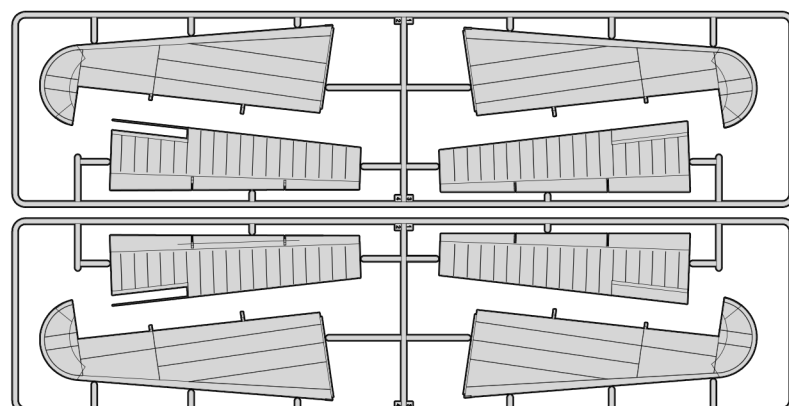
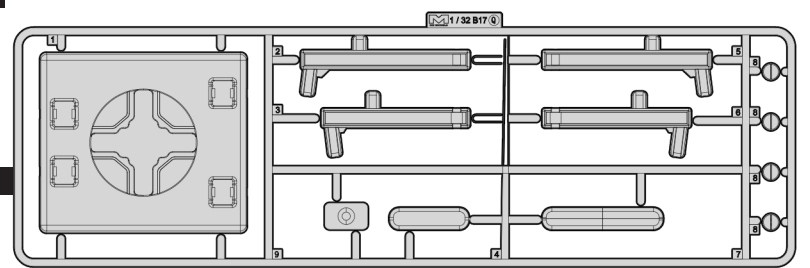
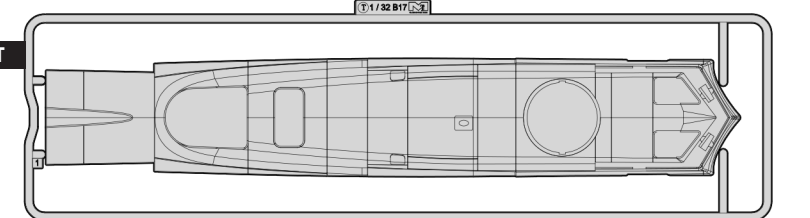
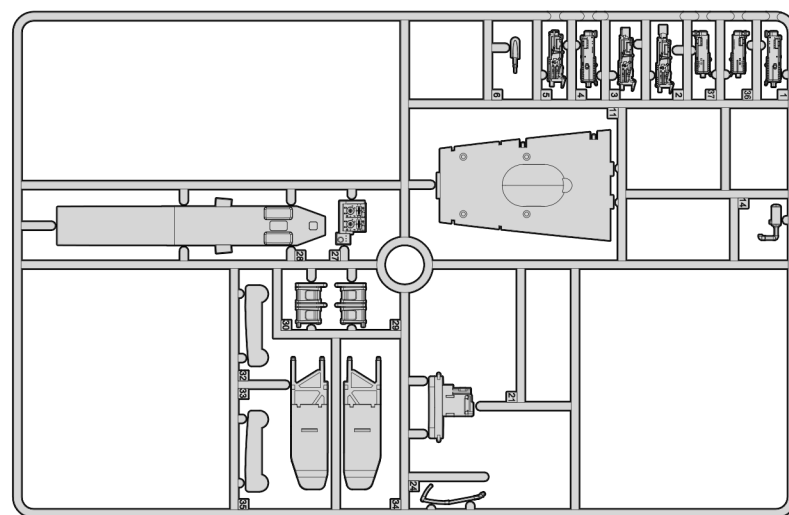
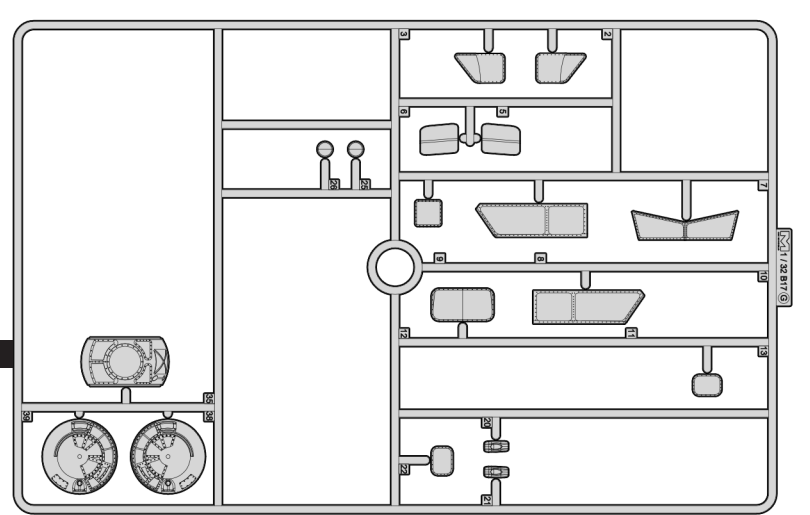
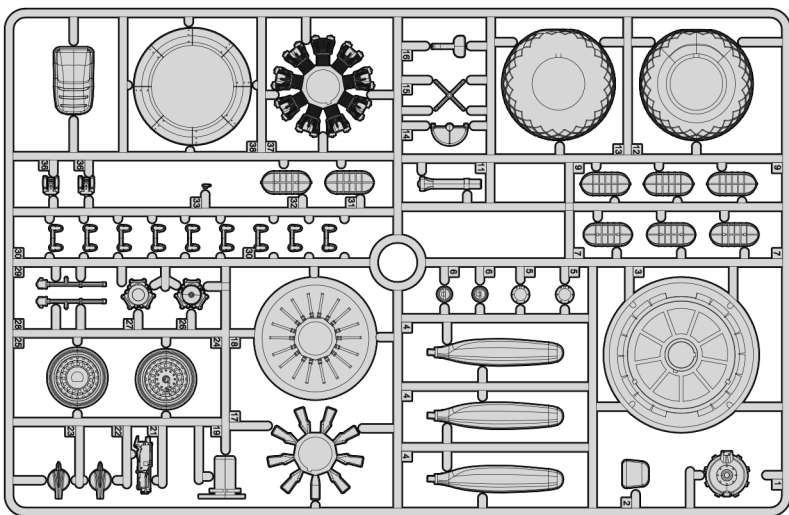
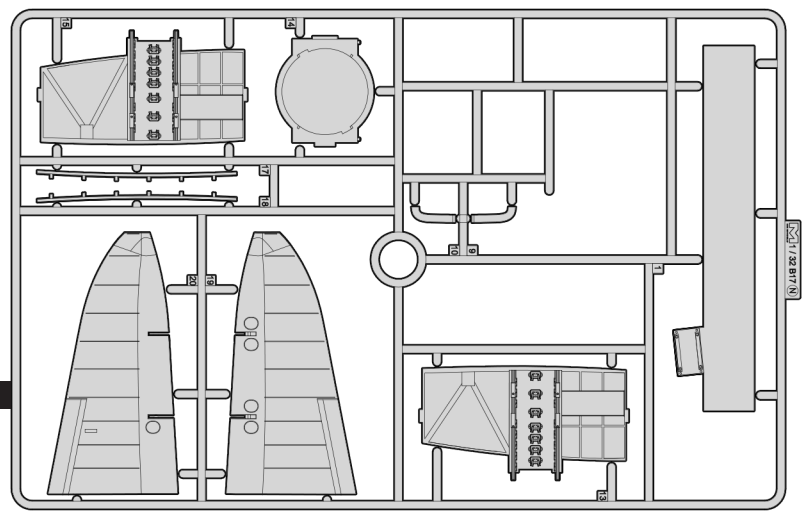
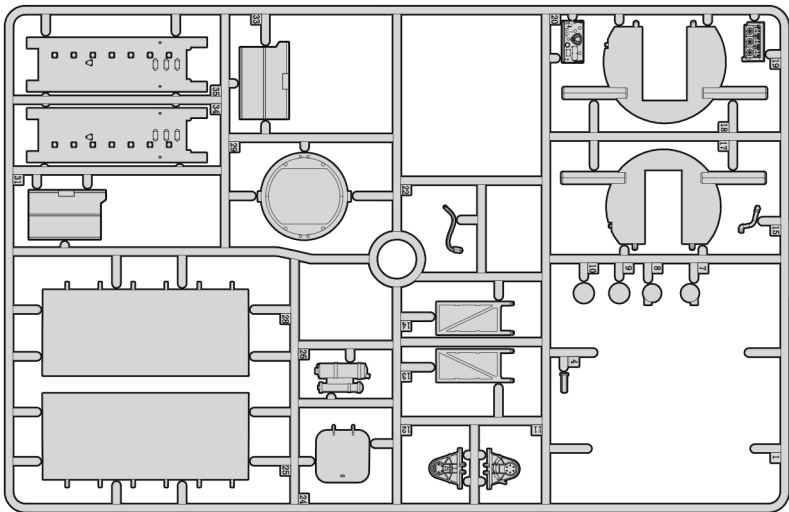

## Parts

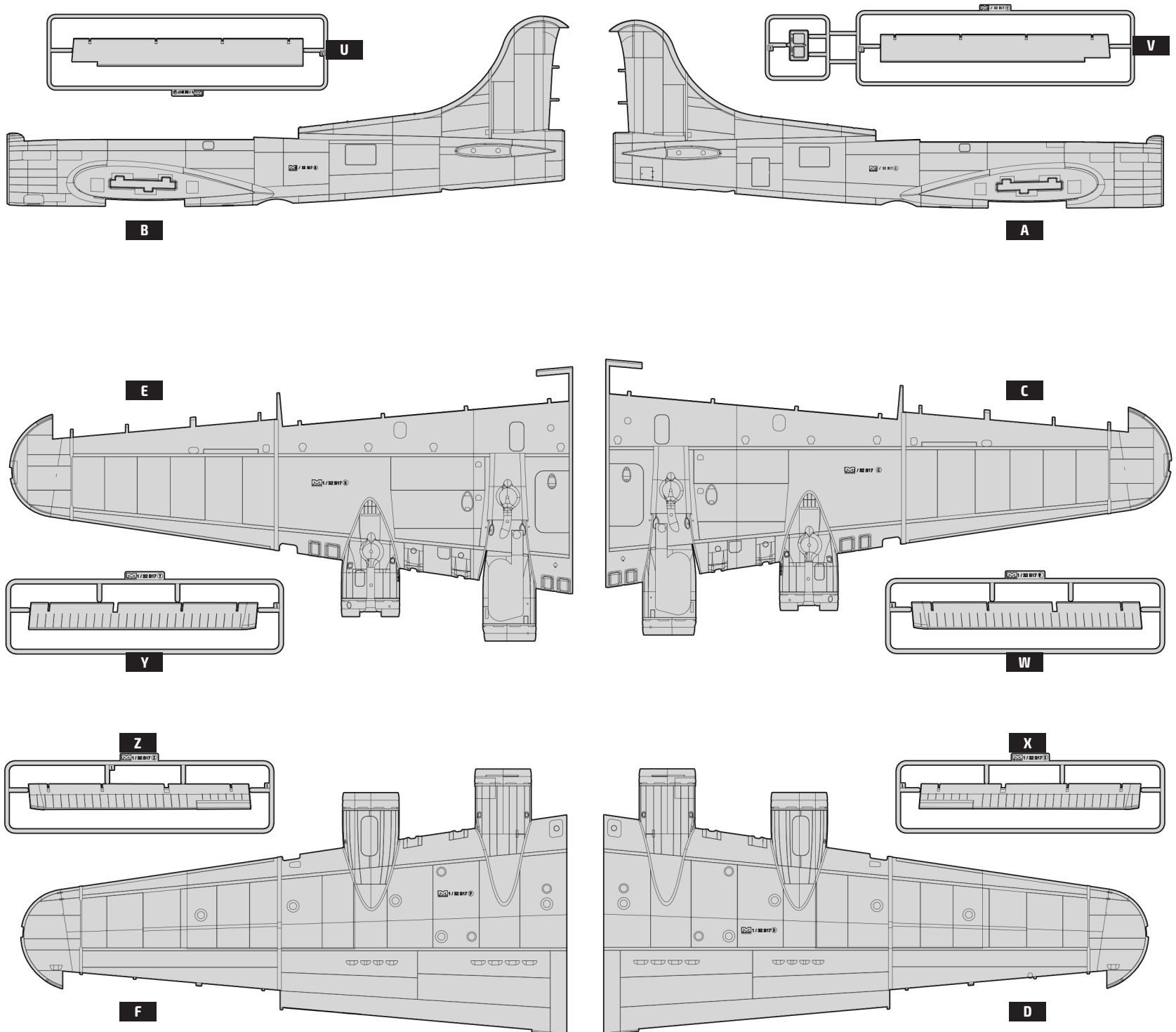

## Resin Parts

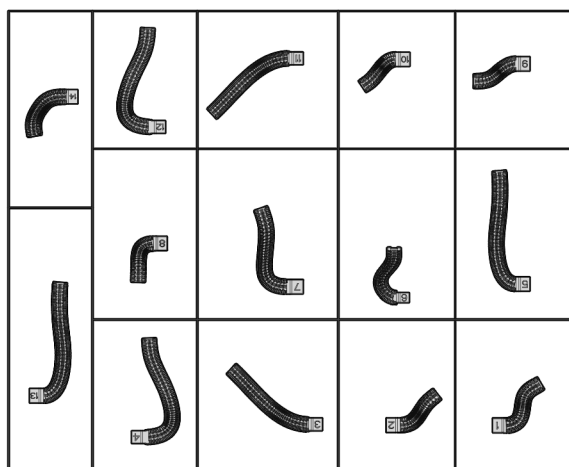

## Photo-etched Parts

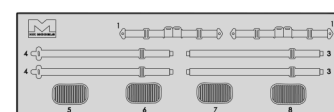



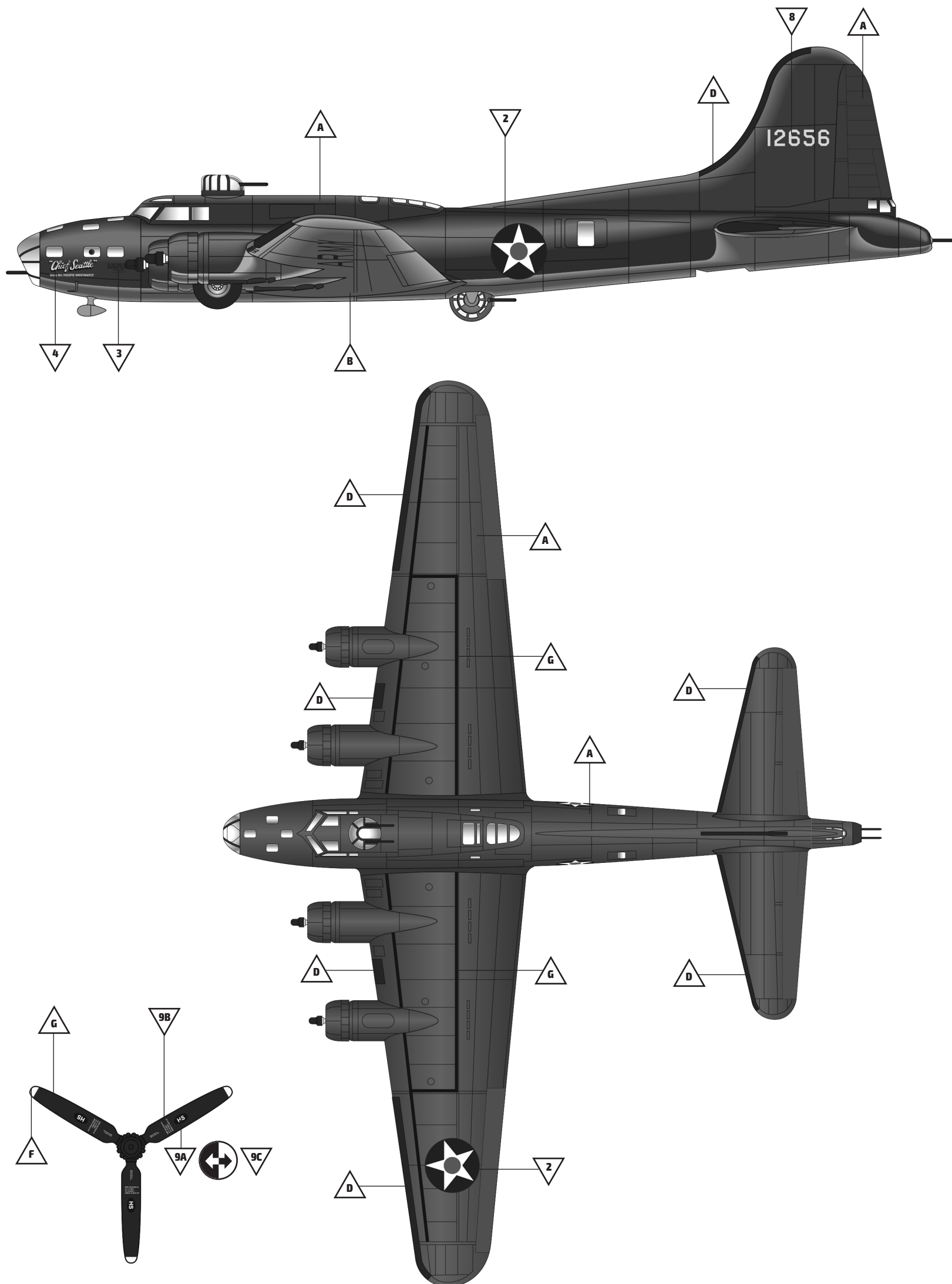

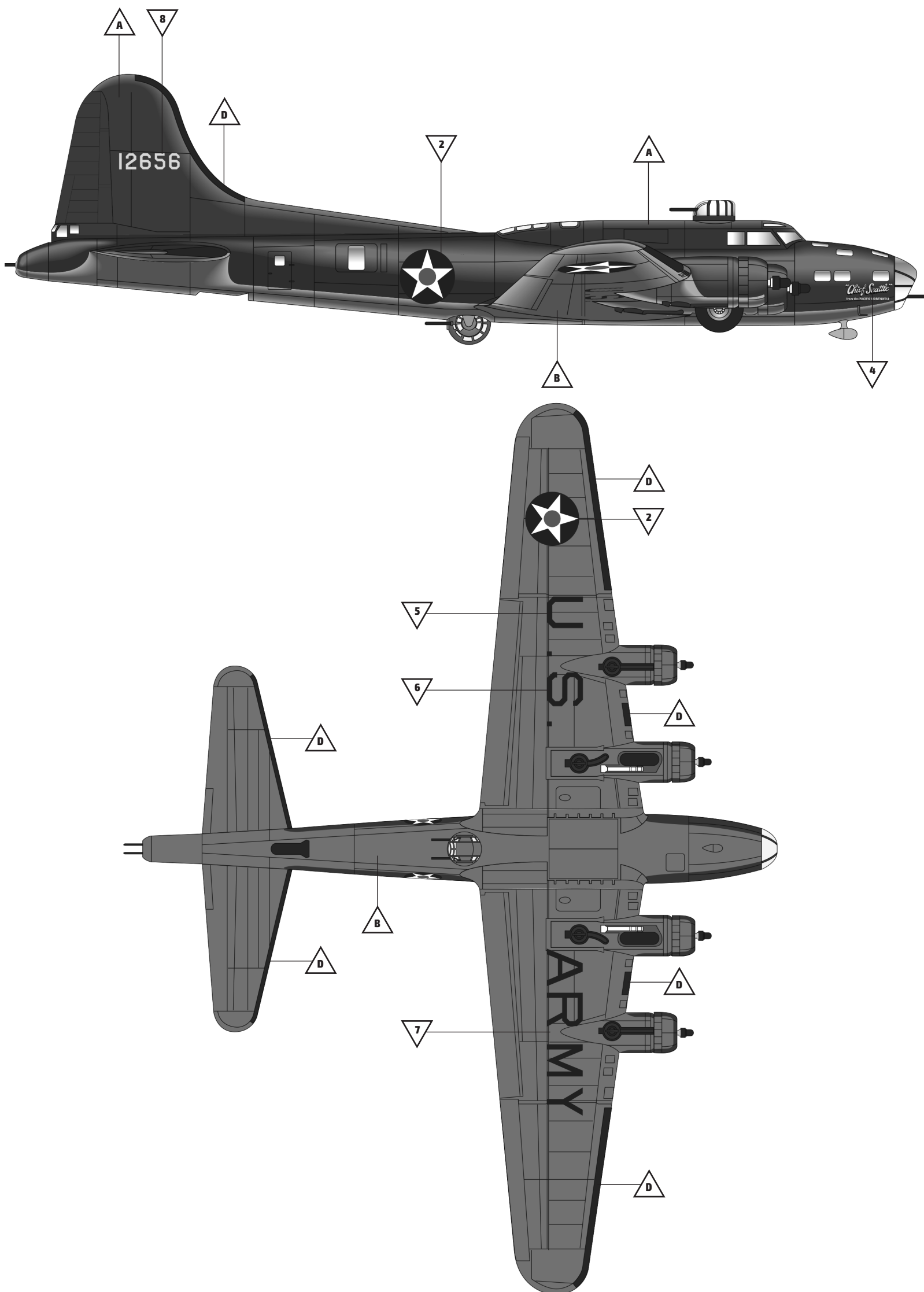



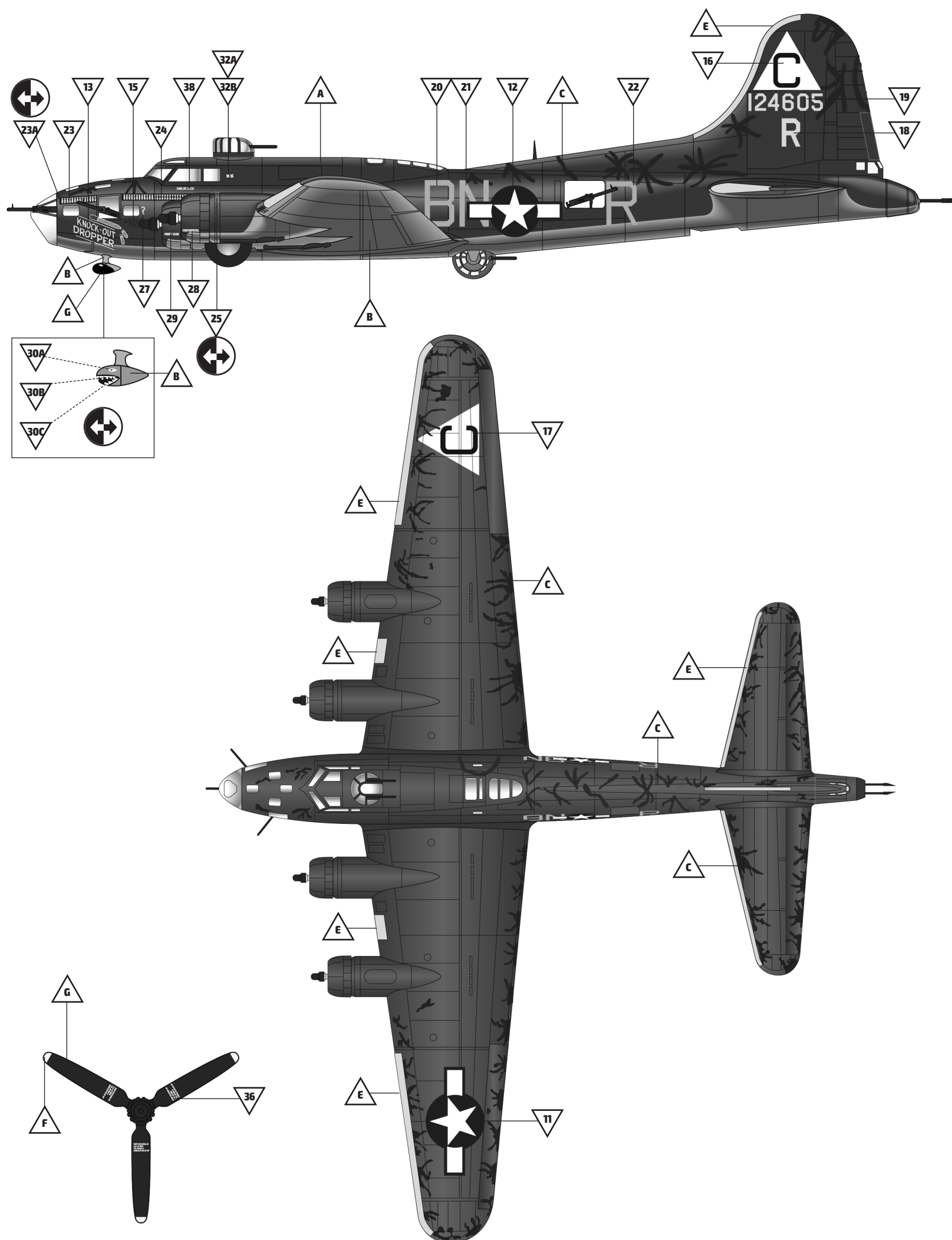

\*Decals 33A + 33B are an early representation of kills, more swastikas may be added using decals 34A + 34B and 35A + 35B to show later additions to the scoreboard

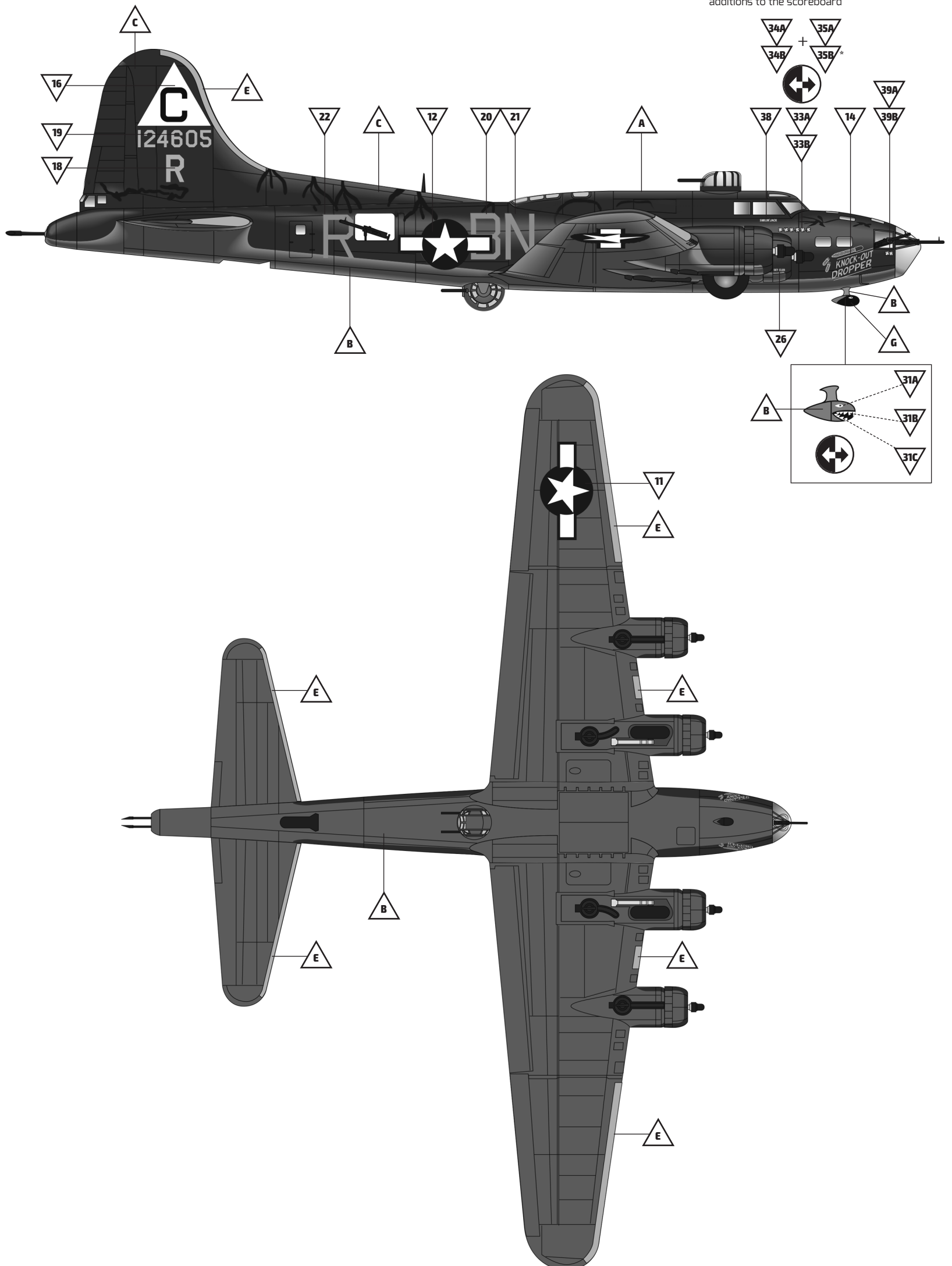

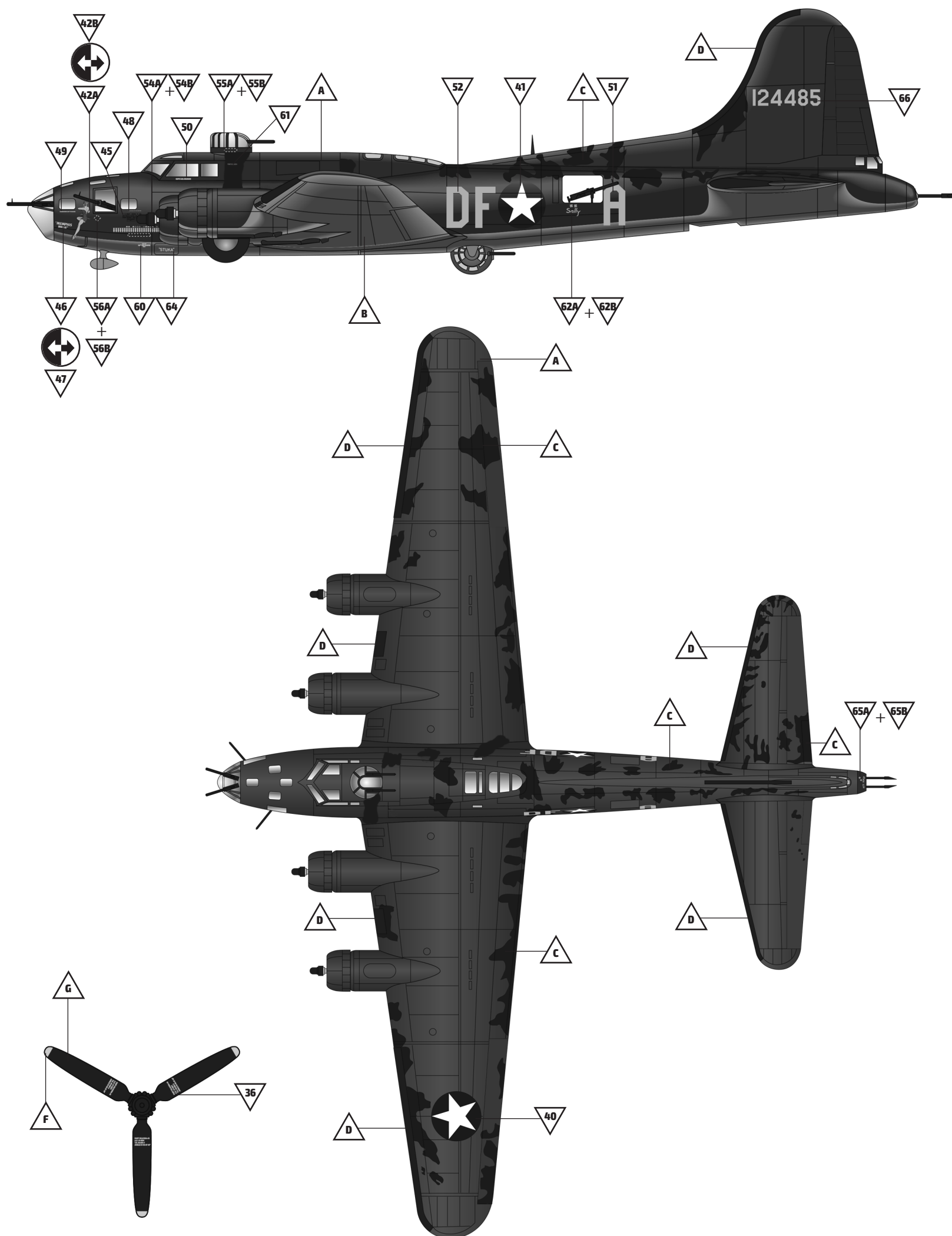





## Colour Guide

Key	Gunze/Mr.Hobby	Tamiya	AK Interactive
A: Dark Olive Drab 41	H52	XF-62:2 + XF-10:1	AK2201
B: Neutral Grey 43	H53	XF-53	AK2203
C: Medium Green 42	H302	XF-26	AK2202
D: Rubber Black	H77	XF-85	AK720
E: Aluminium	MC218	XF-16	AK479
F: Yellow	H4	XF-3	AK2091
G: Flat Black	H12	XF-1	AK735
H: Dull Dark Green	H302	XF-26:4 + XF-1:1	AK2106
I: Gunmetal	MC214	X-10	AK483
J: Brass	MC219	X-12	AK4002
K: Steel	H18	XF-56	AK476
L: Wood	H37	XF-64	AK780
M: Grey	H75	XF-54	AK164
N: White	H11	XF-2	AK738
O: Light Green	H50	XF-71:4 + XF-2:1	AK173
P: Clear Red	H90	X-27	AK265
Q: Clear Green	H94	X-25	AK266

In cooperation with:



[www.ak-interactive.com](http://www.ak-interactive.com)



Large  
Scale  
Modeller  
[www.largescalemodeller.com](http://www.largescalemodeller.com)

Illustration, manual layout and format: **Tomek Wajnka & AK-Interactive**  
Manual and assistance: **AK-Interactive**  
Introductory text: **James Hatch**